

LEAVING A CONSTRUCTION AREA
BLACK ON WHITE

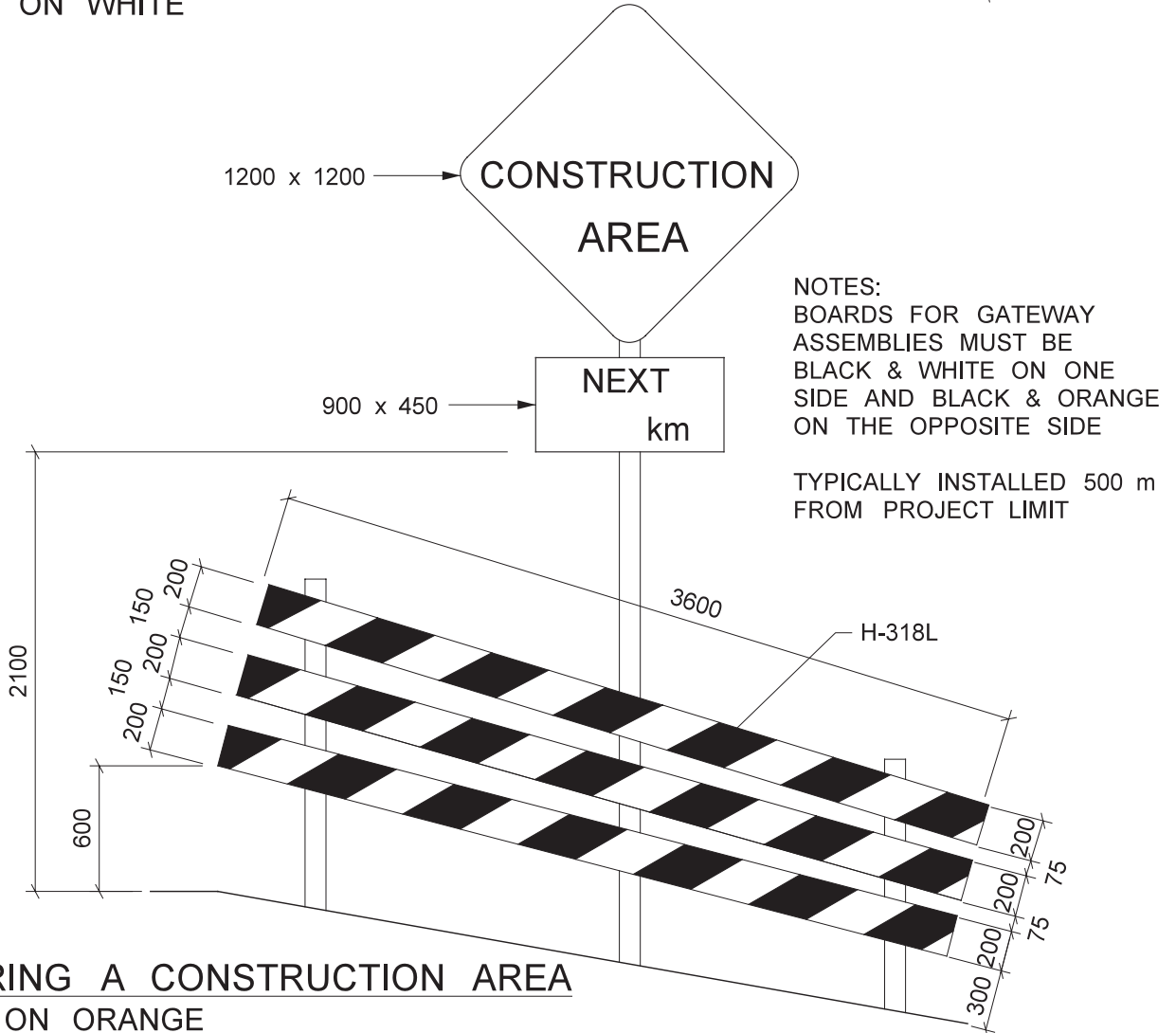

NOTES:
BOARDS FOR GATEWAY ASSEMBLIES MUST BE BLACK & WHITE ON ONE SIDE AND BLACK & ORANGE ON THE OPPOSITE SIDE

TYPICALLY INSTALLED 500 m FROM PROJECT LIMIT

ENTERING A CONSTRUCTION AREA
BLACK ON ORANGE