

# Royal Gazette

Prince Edward Island

Postage paid in cash at First Class Rates

---

---

**PUBLISHED BY AUTHORITY**

**VOL. CXXV - NO. 5**

---

---

**Charlottetown, Prince Edward Island, January 30th, 1999**

---

---

**CANADA  
PROVINCE OF PRINCE EDWARD ISLAND  
IN THE SUPREME COURT - ESTATES DIVISION**

TAKE NOTICE that at all persons indebted to the following estates must make payment to the personal representative of the estates noted below, and that all persons having any demands upon the following estates must present such demands to the representative within six months of the date of the advertisement:

Estate of: Date of the Advertisement	Personal Representative: Executor/Executrix (Ex) Administrator/Administratrix (Ad)	Place of Payment
LANNAN, Albert Francis New Dominion Queens County, P.E.I. January 30th, 1999 (05-18)*	Mary Beverly Lannan (Ex)	Farmer & MacLeod National Bank Tower Suite 205, 134 Kent Street Charlottetown, P.E.I.
MacMILLAN, Grace Jean Charlottetown (Formerly of East Royalty) Queens County, P.E.I. January 30th, 1999 (05-18)*	Joan Wood (Ex)	MacLeod, MacDougall, Crane & Parkman P.O. Box 1056 Charlottetown, P.E.I.
MacMILLAN, H. Noel Charlottetown Queens County, P.E.I. January 30th, 1999 (05-18)*	Alana M. MacMillan Darlene K. MacMillan (Ex)	Campbell, Stewart P.O. Box 485 Charlottetown, P.E.I.
MAHAR, Francis W. Sturgeon Kings County, P.E.I. January 30th, 1999 (05-18)*	Oscar Mahar (Ex)	Alfred K. Fraser, Q.C. P.O. Box 516 Montague, P.E.I.
MILLS, Russell Souris Kings County, P.E.I. January 30th, 1999 (05-18)*	James Mills (Ex)	Allen J. MacPhee, Q.C. P.O. Box 238 Souris, P.E.I.
MORASH, Diane Charlottetown Queens County, P.E.I. January 30th, 1999 (05-18)*	John Faulkner (Ex)	Patterson Palmer Hunt Murphy P.O. Box 486 Charlottetown, P.E.I.
ROSE, Trent P. East Baltic Kings County, P.E.I. January 30th, 1999 (05-18)*	Brendon Rose (Ex)	Allen J. MacPhee, Q.C. P.O. Box 238 Souris, P.E.I.

*\*Indicates date of first publication in ROYAL GAZETTE*

**CANADA**  
**PROVINCE OF PRINCE EDWARD ISLAND**  
**IN THE SUPREME COURT - ESTATES DIVISION**

TAKE NOTICE that at all persons indebted to the following estates must make payment to the personal representative of the estates noted below, and that all persons having any demands upon the following estates must present such demands to the representative within six months of the date of the advertisement:

Estate of: Date of the Advertisement	Personal Representative: Executor/Executrix (Ex) Administrator/Administratrix (Ad)	Place of Payment
HARRINGTON, Luella E. Medford, Middlesex County Massachusetts, USA January 30th, 1999 (05-18)*	J. Scott Harrington (Ad)	Cox Hanson O'Rilly Matheson P.O. Box 875 Charlottetown, P.E.I.
MacNEILL, Jean Long Creek Queens County, P.E.I. January 30th, 1999 (05-18)*	Malcolm MacNeill (Jr.) (Ad)	Foster, O'Keefe P.O. Box 38 Charlottetown, P.E.I.
MacNEILL, Malcolm (Sr.) Long Creek Queens County, P.E.I. January 30th, 1999 (05-18)*	Malcolm MacNeill (Jr.) (Ad)	Foster, O'Keefe P.O. Box 38 Charlottetown, P.E.I.
MATHESON, George P. Ebenezer Queens County, P.E.I. January 30th, 1999 (05-18)*	J. Ralph Matheson (Ad)	Farmer & MacLeod National Bank Tower Suite 205, 134 Kent Street Charlottetown, P.E.I.
MATHESON, Mary Ann Ebenezer Queens County, P.E.I. January 30th, 1999 (05-18)*	J. Ralph Matheson (Ad)	Farmer & MacLeod National Bank Tower Suite 205, 134 Kent Street Charlottetown, P.E.I.
BENNETT, Shirley Margaret North Lake Kings County, P.E.I. January 16th, 1999 (03-16)	Anne Marie Harris (Ex)	McInnes Cooper & Robertson BDC Place, Suite 620 119 Kent Street Charlottetown, P.E.I.
CAMPBELL, Arthur Lorne Alliston Kings County, P.E.I. January 16th, 1999 (03-16)	Victor Campbell (Ex)	Alfred K. Fraser, Q.C. P.O. Box 516 Montague, P.E.I.
DAHL, Carl M. Charlottetown Queens County, P.E.I. January 16th, 1999 (03-16)	C. Joseph Dahl Maria Louise Smelser (Ex)	Robert R. MacArthur P.O. Box 127 Cornwall, P.E.I.
DETWILLER, John P. Hopkinton, Merrimack County New Hampshire, USA January 16th, 1999 (03-16)	Nancy H. Y. Detwiller (Ex)	Stewart McKelvey Stirling Scales P.O. Box 2140 Charlottetown, P.E.I.
DOUCETTE, J. Eric Charlottetown Queens County, P.E.I. January 16th, 1999 (03-16)	Mildred Faye Doucette (Ex)	Horace B. Carver, Q.C. P.O. Box 2698 Charlottetown, P.E.I.

**CANADA**  
**PROVINCE OF PRINCE EDWARD ISLAND**  
**IN THE SUPREME COURT - ESTATES DIVISION**

TAKE NOTICE that at all persons indebted to the following estates must make payment to the personal representative of the estates noted below, and that all persons having any demands upon the following estates must present such demands to the representative within six months of the date of the advertisement:

Estate of: Date of the Advertisement	Personal Representative: Executor/Executrix (Ex) Administrator/Administratrix (Ad)	Place of Payment
FRANCIS, M. Thelma Charlottetown Queens County, P.E.I. January 16th, 1999 (03-16)	Mark Ladner Gregg Francis (Ex)	Allen J. MacPhee, Q.C. P.O. Box 238 Souris, P.E.I.
MacLEOD, Ruth Montague Kings County, P.E.I. January 16th, 1999 (03-16)	Donna Lee MacPherson Kerri Wynne MacLeod (Ex)	Alfred K. Fraser, Q.C. P.O. Box 516 Montague, P.E.I.
MacPHEE, Bruce Lowell New Dominion Queens County, P.E.I. January 16th, 1999 (03-16)	Lowell MacPhee (Ex)	Farmer & MacLeod National Bank Tower Suite 205, 134 Kent Street Charlottetown, P.E.I.
MacWILLIAMS, Lloyd George Melbourne Borden-Carleton Prince County, P.E.I. January 16th, 1999 (03-16)	Marion Adelaide MacWilliams (Ex)	Taylor, McLellan P.O. Box 35 Summerside, P.E.I.
NEILY, Edith Harriet Claypool Charlottetown Queens County, P.E.I. January 16th, 1999 (03-16)	Royal Trust Corporation of Canada (Ex)	Campbell, Lea, Michael, McConnell & Pigot P.O. Box 429 Charlottetown, P.E.I.
PALMER, William F. Halifax Nova Scotia January 16th, 1999 (03-16)	Reta Mae Palmer Beverley Ann Mason Linda Mae Stanley Dr. Bruce William Palmer (Ex)	Stewart McKelvey Stirling Scales P.O. Box 2140 Charlottetown, P.E.I.
SMITH, George E. St. Theresa Kings County, P.E.I. January 16th, 1999 (03-16)	Patrick Edward Smith (Ex)	Larter Sanderson Howard 92 Water Street Charlottetown, P.E.I.
KEEP, Peter Kitsun Washbourne 48 Road, Mount Albion Queens County, P.E.I. December 26th, 1998 (52-13)	Ora May Keep (Ex)	Foster, O'Keefe P.O. Box 38 Charlottetown, P.E.I.
MacKENZIE, Heather Stratford Queens County, P.E.I. December 26th, 1998 (52-13)	Deborah Roberts (Ex)	Stewart McKelvey Stirling Scales P.O. Box 2140 Charlottetown, P.E.I.
READY, John Edward Tignish Prince County, P.E.I. December 26th, 1998 (52-13)	Irma Doyle (Ex)	John W. Maynard P.O. Box 177 O'Leary, P.E.I.

**CANADA**  
**PROVINCE OF PRINCE EDWARD ISLAND**  
**IN THE SUPREME COURT - ESTATES DIVISION**

TAKE NOTICE that at all persons indebted to the following estates must make payment to the personal representative of the estates noted below, and that all persons having any demands upon the following estates must present such demands to the representative within six months of the date of the advertisement:

Estate of: Date of the Advertisement	Personal Representative: Executor/Executrix (Ex) Administrator/Administratrix (Ad)	Place of Payment
RODD, Sadie (Sally) Miriam Charlottetown Queens County, P.E.I. December 26th, 1998 (52-13)	David Rodd Sandra Rodd (Ex)	Stewart McKelvey Stirling Scales P.O. Box 2140 Charlottetown, P.E.I.
WAITE, Ivan Lea Summerside Prince County, P.E.I. December 26th, 1998 (52-13)	Beulah May Waite (Ex)	Ramsay & Clark P.O. Box 96 Summerside, P.E.I.
JEFFERY, Richard Alberton Prince County, P.E.I. December 26th, 1998 (52-13)	Fenton Jeffery (Ad)	J. Allan Shaw P.O. Box 40 Alberton, P.E.I.
MacWILLIAMS, Geraldine Mary New Dominion Queens County, P.E.I. December 26th, 1998 (52-13)	Wendell Gerald MacWilliams Lilla Rose MacWilliams Stephen Russell MacWilliams (Ad)	Stewart McKelvey Stirling Scales P.O. Box 2140 Charlottetown, P.E.I.
NEWITT, Mary Alexandra Toronto, Ontario (formerly of Northam, Prince County, P.E.I.) December 26th, 1998 (52-13)	John H. (Jack) Newitt (Ad)	The Law Office of Kathleen Loo Craig P.O. Box 11 Summerside, P.E.I.
BOULGER, Loretta Marie Charlottetown Queens County, P.E.I. December 19th, 1998 (51-12)	James J. Boulger Gaylene Gallant (Ex)	E.W. Scott Dickieson P.O. Box 1453 Charlottetown, P.E.I.
CHAMPION, Harold Winston Summerside Prince County, P.E.I. December 19th, 1998 (51-12)	Geraldine Mae Champion (Ex)	Key McKnight & Peacock P.O. Box 1570 Summerside, P.E.I.
DOUCETTE, Frederick Joseph Harper Road, Tignish RR3 Prince County, P.E.I. December 19th, 1998 (51-12)	Mary Christopher (Ex)	Aylward & Associates 82 Summer Street Summerside, P.E.I.
GILLESPIE, James Robert Summerside Prince County, P.E.I. December 19th, 1998 (51-12)	J. Garth Gillespie Charles W. Gillespie (Ex)	Taylor, McLellan P.O. Box 35 Summerside, P.E.I.
JOHNSTON, George Patrick Kinkora Prince County, P.E.I. December 19th, 1998 (51-12)	Helen Johnston (Ex)	Patterson Palmer Hunt Murphy 268 Water Street Summerside, P.E.I.

**CANADA**  
**PROVINCE OF PRINCE EDWARD ISLAND**  
**IN THE SUPREME COURT - ESTATES DIVISION**

TAKE NOTICE that at all persons indebted to the following estates must make payment to the personal representative of the estates noted below, and that all persons having any demands upon the following estates must present such demands to the representative within six months of the date of the advertisement:

Estate of: Date of the Advertisement	Personal Representative: Executor/Executrix (Ex) Administrator/Administratrix (Ad)	Place of Payment
McGOWAN, Elizabeth Margaret Brudenell Kings County, P.E.I. December 19th, 1998 (51-12)	Anne Wood (Ex)	Stewart McKelvey Stirling Scales P.O. Box 2140 Charlottetown, P.E.I.
PARTRIDGE, Roderick A. Montreal Quebec December 19th, 1998 (51-12)	Johanna Earle (Ex)	Patterson Palmer Hunt Murphy P.O. Box 486 Charlottetown, P.E.I.
JOHNSTON, Lawrence Kinkora Prince County, P.E.I. December 19th, 1998 (51-12)	Austin Johnston Gerard Johnston Marlene Zalewski (Ad)	Key McKnight & Peacock P.O. Box 1570 Summerside, P.E.I.
DAWSON, Gordon Augustine Cove Prince County, P.E.I. December 5th, 1998 (49-10)	Jean Dawson David Dawson Paul Dawson (Ex)	Aylward & Associates 82 Summer Street Summerside, P.E.I.
HENNESSEY, Joseph Alfred Charlottetown Queens County, P.E.I. December 5th, 1998 (49-10)	Royal Trust Corporation of Canada (Ex)	Larter Sanderson Howard 91 Water Street Charlottetown, P.E.I.
MacKAY, William Allan Summerside Prince County, P.E.I. December 5th, 1998 (49-10)	Nancy Evelyn MacKay (Ex)	Taylor, McLellan P.O. Box 35 Summerside, P.E.I.
MacNEILL, Murdoch S. Dutchess County New York, USA December 5th, 1998 (49-10)	Carol B. Annacone (Ad)	Macnutt & Dumont P.O. Box 965 Charlottetown, P.E.I.
CAMPBELL, Elric Wyman Summerside Prince County, P.E.I. November 28th, 1998 (48-09)	David Campbell (Ex)	Aylward & Associates 82 Summer Street Summerside, P.E.I.
LLEWELLYN, Temple MacIntyre Montague Kings County, P.E.I. November 28th, 1998 (48-09)	Richard Llewellyn (Ex)	Alfred K. Fraser, Q.C. P.O. Box 516 Montague, P.E.I.
MacKINNON-GLOVER, Ann Louise Village Green Queens County, P.E.I. November 28th, 1998 (48-09)	Dwight Glover Marlene Glover (Ex)	Birt & McNeill P.O. Box 20063 Sherwood, P.E.I.

**CANADA**  
**PROVINCE OF PRINCE EDWARD ISLAND**  
**IN THE SUPREME COURT - ESTATES DIVISION**

TAKE NOTICE that at all persons indebted to the following estates must make payment to the personal representative of the estates noted below, and that all persons having any demands upon the following estates must present such demands to the representative within six months of the date of the advertisement:

Estate of: Date of the Advertisement	Personal Representative: Executor/Executrix (Ex) Administrator/Administratrix (Ad)	Place of Payment
MacNEVIN, Leonard St. Catherines Queens County, P.E.I. November 28th, 1998 (48-09)	Reigh MacNevin (Ex)	Farmer & MacLeod National Bank Tower Suite 205, 134 Kent Street Charlottetown, P.E.I.
MORRIS, Leila Amy Charlottetown Queens County, P.E.I. November 28th, 1998 (48-09)	Robert D. Donnelly Shirley J. Donnelly (Ex)	Reagh & Reagh 17 West Street Charlottetown, P.E.I.
PETERSON, Alma Una Sherren Mount Herbert Queens County, P.E.I. November 28th, 1998 (48-09)	William Ronald Gordon Peterson (Ex)	Stewart McKelvey Stirling Scales P.O. Box 2140 Charlottetown, P.E.I.
STEVENSON, J. Lorne Charlottetown (Formerly of New Glasgow) Queens County, P.E.I. November 28th, 1998 (48-09)	Barry M. Stevenson David H. Stevenson (Ex)	Farmer & MacLeod National Bank Tower Suite 205, 134 Kent Street Charlottetown, P.E.I.
STEVENSON, Winnifred Stanley Bridge Queens County, P.E.I. November 28th, 1998 (48-09)	Deborah MacLean (Ex)	Carr Stevenson & MacKay P.O. Box 522 Charlottetown, P.E.I.
WELLS, Georgina Martina Alberton Prince County, P.E.I. November 28th, 1998 (48-09)	Gerald MacMillan (Ex)	J. Allan Shaw P.O. Box 40 Alberton, P.E.I.
BLAISDELL, Doris (Lewis) Monticello Kings County, P.E.I. November 28th, 1998 (48-09)	Barbara Oickle (Ad)	Alfred K. Fraser, Q.C. P.O. Box 516 Montague, P.E.I.
BLAISDELL, George Monticello Kings County, P.E.I. November 28th, 1998 (48-09)	Barbara Oickle (Ad)	Alfred K. Fraser, Q.C. P.O. Box 516 Montague, P.E.I.
LAYBOLT, Harriett Dingwell's Mills Kings County, P.E.I. November 28th, 1998 (48-09)	John F. Laybolt (Ad)	Alfred K. Fraser, Q.C. P.O. Box 516 Montague, P.E.I.
MADORE, Maude Rosabelle Souris Kings County, P.E.I. November 28th, 1998 (48-09)	Kenneth Madore (Ad)	Allen J. MacPhee, Q.C. P.O. Box 238 Souris, P.E.I.

**CANADA**  
**PROVINCE OF PRINCE EDWARD ISLAND**  
**IN THE SUPREME COURT - ESTATES DIVISION**

TAKE NOTICE that at all persons indebted to the following estates must make payment to the personal representative of the estates noted below, and that all persons having any demands upon the following estates must present such demands to the representative within six months of the date of the advertisement:

Estate of: Date of the Advertisement	Personal Representative: Executor/Executrix (Ex) Administrator/Administratrix (Ad)	Place of Payment
BAILLIE, Kathleen Audrey Summerside Prince County, P.E.I. November 21st, 1998 (47-08)	Roger Scott Baillie David George Baillie (Ex)	Aylward & Associates 82 Summer Street Summerside, P.E.I.
BIGGAR, Betty Bly Summerside Prince County, P.E.I. November 21st, 1998 (47-08)	Kay Heeschen Barry Munn (Ex)	Aylward & Associates 82 Summer Street Summerside, P.E.I.
COMPTON, Frances Summerside Prince County, P.E.I. November 21st, 1998 (47-08)	Ivan Compton Keir Compton (Ex)	The Law Office of Kathleen Loo Craig P.O. Box 11 Summerside, P.E.I.
MacLELLAN, Sterling Souris Kings County, P.E.I. November 21st, 1998 (47-08)	Alice (Nettie) MacLellan (Ex)	Allen J. MacPhee, Q.C. P.O. Box 238 Souris, P.E.I.
MATTHEWS, George Alvin Summerside Prince County, P.E.I. November 21st, 1998 (47-08)	Darlene Norring (Ex)	Taylor, McLellan P.O. Box 35 Summerside, P.E.I.
McINNIS, Daniel James Selkirk Kings County, P.E.I. November 21st, 1998 (47-08)	Bernice McInnis (Ex)	Diamond & McKenna P.O. Box 39 Charlottetown, P.E.I.
MURPHY, Wallace Aeneas Carleton Prince County, P.E.I. November 21st, 1998 (47-08)	Mary St. Clair Murphy Brendon Wallace Murphy (Ex)	McInnes Cooper & Robertson BDC Place, Suite 620 119 Kent Street Charlottetown, P.E.I.
PAUPTIT, Reta Elizabeth Summerside Prince County, P.E.I. November 21st, 1998 (47-08)	Woodland Pauptit Blanche Clow (Ex)	Ramsay & Clark P.O. Box 96 Summerside, P.E.I.
PHILLIPS, Gerald Erland Mount Royal Prince County, P.E.I. November 21st, 1998 (47-08)	Marie Phillips (Ex)	John W. Maynard P.O. Box 177 O'Leary, P.E.I.
TODD, Albert Edward West Royalty Queens County, P.E.I. November 21st, 1998 (47-08)	J. Kenneth Clark Roderick Nicholson (Ex)	Ramsay & Clark P.O. Box 96 Summerside, P.E.I.

**CANADA**  
**PROVINCE OF PRINCE EDWARD ISLAND**  
**IN THE SUPREME COURT - ESTATES DIVISION**

TAKE NOTICE that at all persons indebted to the following estates must make payment to the personal representative of the estates noted below, and that all persons having any demands upon the following estates must present such demands to the representative within six months of the date of the advertisement:

Estate of: Date of the Advertisement	Personal Representative: Executor/Executrix (Ex) Administrator/Administratrix (Ad)	Place of Payment
VICTOR, Wilfred M. Newport Kings County, P.E.I. November 21st, 1998 (47-08)	Gladys I. Victor (Ex)	Ramsay & Clark P.O. Box 96 Summerside, P.E.I.
WHITE, Herbert Vincent Charlottetown Queens County, P.E.I. November 21st, 1998 (47-08)	Alberta Vergene White (Ex)	Stewart McKelvey Stirling Scales P.O. Box 2140 Charlottetown, P.E.I.
MURPHY, Mary Catherine Millvale Queens County, P.E.I. November 21st, 1998 (47-08)	Marion Murphy (Ad)	McInnes Cooper & Robertson BDC Place, Suite 620 119 Kent Street Charlottetown, P.E.I.
SULLIVAN, Daniel P. Campbellton Prince County, P.E.I. November 21st, 1998 (47-08)	Kevin Stemmler (Ad)	J. Allan Shaw P.O. Box 40 Alberton, P.E.I.
DIAMOND, Thomas "Earl" South Winsloe, Winsloe RR9 Queens County, P.E.I. November 14th, 1998 (46-07)	Ernest Diamond Blaine Diamond (Ex)	Carr, Stevenson & MacKay P.O. Box 522 Charlottetown, P.E.I.
GAMESTER, Lemuel Rogerson Bungay Road Queens County, P.E.I. November 14th, 1998 (46-07)	Janie Gamester (Ad)	Stewart McKelvey Stirling Scales P.O. Box 2140 Charlottetown, P.E.I.
CHAPMAN, John Frederick 1210 Edmison Drive Peterborough, Ontario November 7th, 1998 (45-06)	Jennie Alice Chapman (Ex)	Campbell, Stewart P.O. Box 485 Charlottetown, P.E.I.
TWEEL, Anna "Linda" Hecker Battery Point, Stratford Queens County, P.E.I. November 7th, 1998 (45-06)	Terrance Daniel Tweel Christopher Peter Tweel (Ex)	T. Daniel Tweel P.O. Box 3160 Charlottetown, P.E.I.
COOK, Joseph Henry Belle River Queens County, P.E.I. November 7th, 1998 (45-06)	Daniel Archibald Cook (Ad)	MacLeod, MacDougall, Crane & Parkman P.O. Box 1056 Charlottetown, P.E.I.
CROSBY, Margaret E. Meadowbank Queens County, P.E.I. October 31st, 1998 (44-05)	E. Lawson Drake Ian M. MacLeod, Q.C. (Ex)	Farmer & MacLeod National Bank Tower Suite 205, 134 Kent Street Charlottetown, P.E.I.



**CANADA**  
**PROVINCE OF PRINCE EDWARD ISLAND**  
**IN THE SUPREME COURT - ESTATES DIVISION**

TAKE NOTICE that at all persons indebted to the following estates must make payment to the personal representative of the estates noted below, and that all persons having any demands upon the following estates must present such demands to the representative within six months of the date of the advertisement:

Estate of: Date of the Advertisement	Personal Representative: Executor/Executrix (Ex) Administrator/Administratrix (Ad)	Place of Payment
DICKIE, Sarah (Sadie) J. Cape Traverse Prince County, P.E.I. October 31st, 1998 (44-05)	George E. Read (Ex)	Aylward & Associates 82 Summer Street Summerside, P.E.I.
DIXON, Lillian Jean Rollo Bay Kings County, P.E.I. October 31st, 1998 (44-05)	Roland Burke (Ex)	Allen J. MacPhee, Q.C. P.O. Box 238 Souris, P.E.I.
GAUTHIER, Leo J. Mayfield Queens County, P.E.I. October 31st, 1998 (44-05)	Marlene Gallant (Ex)	Farmer & MacLeod National Bank Tower Suite 205, 134 Kent Street Charlottetown, P.E.I.
GREEN, Jean Millar Central Bedeque Prince County, P.E.I. October 31st, 1998 (44-05)	Myrna Murray Elaine Noonan (Ex)	Taylor, McLellan P.O. Box 35 Summerside, P.E.I.
MacINTYRE, Mary Lenora Charlottetown Queens County, P.E.I. October 31st, 1998 (44-05)	Bernard MacIntyre Marie Sheehan (Ex)	Horace B. Carver, Q.C. P.O. Box 2698 Charlottetown, P.E.I.
McMILLAN, John Archibald Central Kildare Prince County, P.E.I. October 31st, 1998 (44-05)	George McMillan (Ex)	J. Allan Shaw P.O. Box 40 Alberton, P.E.I.
RAMSAY, John Keir O'Leary Prince County, P.E.I. October 31st, 1998 (44-05)	Laura Lee Ramsay (Ex)	J. Allan Shaw P.O. Box 40 Alberton, P.E.I.
SIGALET, Edward James Stanley Bridge, Kensington RR 6 Queens County, P.E.I. October 31st, 1998 (44-05)	Albina Shirley Sigalet (Ex)	Aylward & Associates 82 Summer Street Summerside, P.E.I.
BAILEY, Bridgette Elmira Kings County, P.E.I. October 31st, 1998 (44-05)	Augustus (Gus) Bailey (Ad)	Allen J. MacPhee, Q.C. P.O. Box 238 Souris, P.E.I.
BAILEY, Joseph Elmira Kings County, P.E.I. October 31st, 1998 (44-05)	Augustus (Gus) Bailey (Ad)	Allen J. MacPhee, Q.C. P.O. Box 238 Souris, P.E.I.

**CANADA**  
**PROVINCE OF PRINCE EDWARD ISLAND**  
**IN THE SUPREME COURT - ESTATES DIVISION**

TAKE NOTICE that at all persons indebted to the following estates must make payment to the personal representative of the estates noted below, and that all persons having any demands upon the following estates must present such demands to the representative within six months of the date of the advertisement:

Estate of: Date of the Advertisement	Personal Representative: Executor/Executrix (Ex) Administrator/Administratrix (Ad)	Place of Payment
FERGUSON, Jean Rita Charlottetown Queens County, P.E.I. October 31st, 1998 (44-05)	John Lloyd Ferguson (Ad)	MacLeod, MacDougall, Crane & Parkman P.O. Box 1056 Charlottetown, P.E.I.
MacDONALD, Ernest Charles Inverness Prince County, P.E.I. October 31st, 1998 (44-05)	Ella Coughlin (Ad)	Patterson Palmer Hunt Murphy 268 Water Street Summerside, P.E.I.
MacKAY, James Irvine Charlottetown Queens County, P.E.I. October 31st, 1998 (44-05)	Virginia (MacKay) Crabbe (Ad)	Farmer & MacLeod National Bank Tower Suite 205, 134 Kent Street Charlottetown, P.E.I.
MacPHEE, Roderick Glencorradale Kings County, P.E.I. October 31st, 1998 (44-05)	Mary MacPhee (Ad)	Alfred K. Fraser, Q.C. P.O. Box 516 Montague, P.E.I.
MacPHEE, Theresa Amelia Glencorradale Kings County, P.E.I. October 31st, 1998 (44-05)	Mary MacPhee (Ad)	Alfred K. Fraser, Q.C. P.O. Box 516 Montague, P.E.I.
McISAAC, Albert Glenwood Prince County, P.E.I. October 31st, 1998 (44-05)	Mary Regina Russell (Ad)	Regena Kay Russell P.O. Box 383 O'Leary, P.E.I.

## Public Notice of Pending Road Closure

Made by the Minister of Transportation and Public Works under section 32 of the Roads Act, R.S.P.E.I. 1988, Cap. R-15.

TAKE NOTICE THAT the Minister of Transportation and Public Works has determined that a certain public road as described in Schedule "A" has become unnecessary for public use and shall be ordered closed.

AND TAKE NOTICE THAT Subsection 32.4(a) provides as follows:

32.4(a) Where a road or portion of a road is closed, it ceases to be a common and public highway and any public right-of-way thereon is extinguished.

AND TAKE NOTICE THAT anyone having a valid interest in lands along or near this road as described in Schedule "A", or otherwise being affected by this public road closure will have 30 days from the date of posting of this notice to notify the Department of Transportation and Public Works in writing at the following address.

Department of Transportation and Public Works  
Province of Prince Edward Island  
P.O. Box: 2000  
Charlottetown, PEI  
C1A 7N8

Attention: Serge Bernard  
Chief Provincial Surveyor

AND TAKE NOTICE THAT a Ministerial Order shall hereafter be issued thereby declaring this road as described in Schedule "A" closed and thereafter it shall cease to be a common and public highway and any public right-of-way thereon shall be extinguished.

THIS NOTICE DATED THIS 26TH DAY OF JANUARY 1999.

### SCHEDULE A

ALL THAT PIECE OR PORTION OF ROAD situate, lying and being in Lot 48, County of Queens, Province of Prince Edward Island, bounded and described as follows, that is to say:

COMMENCING at a certain point on the subject road, said road referred to as the "Keppoch Road" as shown on the J.H.Meacham & Co. Atlas published in 1880, said point where it intersects with the present day southeastern boundary of the Keppoch Road, at or near the northeastern boundary of PID 328757 lands now or formerly in possession of Donald & Pam Newcombe;

THENCE in a southeasterly direction following the various courses of the said "Keppoch Road" until its end where it strikes the present day westerly boundary of the Kinlock Road, at or near the northeasterly boundary of PID 398586 lands now or formerly in possession of Stonington Inc.

Being or intended to be a portion of the so-called "Keppoch Road" as shown on the above noted atlas, bounded on the northwest by the present day Keppoch Road and on the southeast by the present day Kinlock Road. A portion of said road having been first described in a certain indenture dated May 28, 1896 and registered under Document no. 171 of the Queens County Right-of-Ways Index.

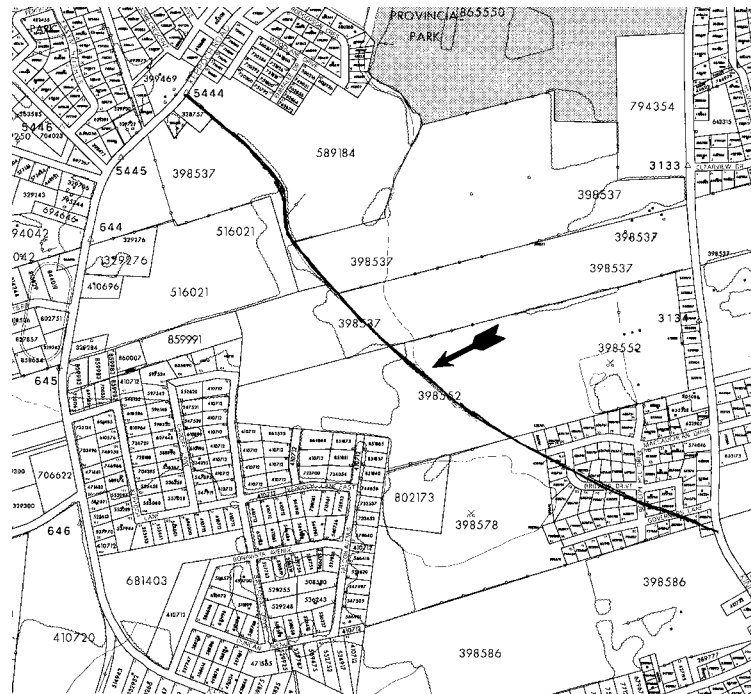
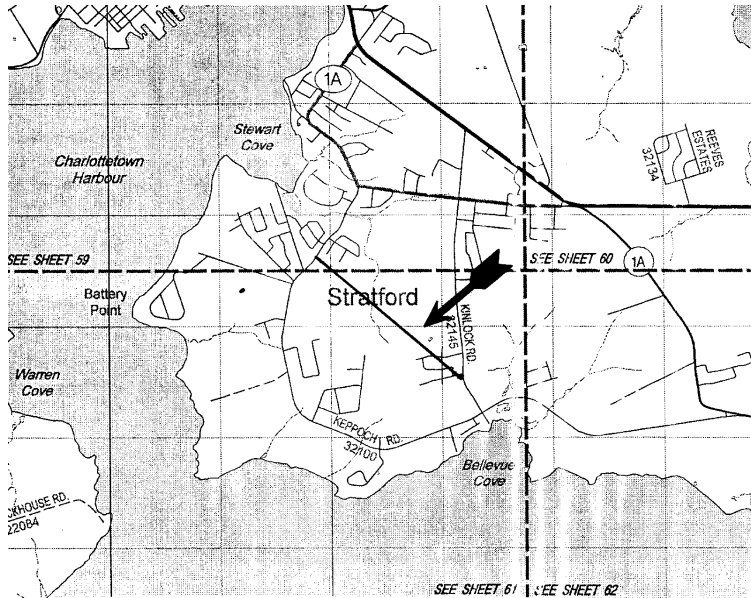

Transportation  
and Public Works  
Hon. Michael F. Currie  
Minister

**MC99-1**  
**PRINCE EDWARD ISLAND**  
**MARKETING COUNCIL**

ORDER NO.: MC99-1

EFFECTIVE: February 1, 1999

Under the *Natural Products Marketing Act*, R.S.P.E.I. 1988, Cap. N-3, the Prince Edward Island Marketing Council makes the following Order:

**CLASS 1 MILK PRICE DETERMINATION ORDER - AMENDMENT**

1. Section 3 of the Class 1 Milk Price Determination Order (MC98-1) dated February 1, 1998, is hereby deleted and substituted with the following:

3. The price of milk components paid to the Prince Edward Island Milk Marketing Board by processors for components sold in Class 1(a) products shall be \$5.5485 per kilogram of butterfat, \$4.8624 per kilogram of protein and \$4.8624 per kilogram of other solids. The Prince Edward Island Milk Marketing Board shall use a standard component test value of 3.3705 kilograms per hectolitre for protein and 5.7320 kilograms per hectolitre of other solids for billing purposes.

2. Section 4 of the Class 1 Milk Price Determination Order (MC98-1) dated February 1, 1998, is hereby deleted and substituted with the following:

4. The price of milk components paid to the Prince Edward Island Milk Marketing Board by processors for components sold in Class 1(b) products shall be \$5.5485 per kilogram of butterfat, \$4.4631 per kilogram of protein and \$4.4631 per kilogram of other solids. The Prince Edward Island Milk Marketing Board shall use a standard component test value of 2.8026 kilograms per hectolitre for protein and 4.7661 kilograms per hectolitre of other solids for billing purposes.

3. Section 5 of the Class 1 Milk Price Determination Order (MC98-1) dated February 1, 1998, is hereby deleted and substituted with the following:

5. The price of milk components paid to the Prince Edward Island Milk Marketing Board by processors for components sold in Class 1(c) products shall be \$5.5485 per kilogram of butterfat, \$4.8157 per kilogram of protein and \$4.8157 per kilogram of other solids. The Prince Edward Island Milk Marketing Board shall use a standard component test value of 3.3309 kilograms per hectolitre for protein and 5.6646 kilograms per hectolitre of other solids for billing purposes.

4. This Order comes into force on the 1st day of February, 1999.

Dated at Charlottetown, Prince Edward Island, this 25th day of January, 1999.

Kenneth MacLellan  
CHAIRMAN

Robert Morrison

SECRETARY  
PB99-2

**PRINCE EDWARD ISLAND  
POTATO BOARD**

BOARD ORDER: PB99-2

EFFECTIVE: January 20, 1999

Under the *Natural Products Marketing Act*, R.S.P.E.I. 1988, Cap. N-3, the Prince Edward Island Potato Marketing Plan Regulations, and the *Agricultural Products Marketing Act (Canada)*, the Prince Edward Island Potato Board makes the following Order:

DETENTION AND SEARCH OF VEHICLES ORDER

1. This Order applies to the operation of the Potato Quality Monitoring and Inspection facility in Borden-Carleton, and to the detention and search of vehicles at the Borden-Carleton and Wood Islands weigh scales for the purpose of ascertaining whether or not potatoes are being transported in violation of orders of the Prince Edward Island Potato Board. Application
  
2. In this Order the words used shall have the meanings set forth in the Natural Products Marketing Act, R.S.P.E.I. 1988, Cap. N-3 and regulations made thereunder and the Prince Edward Island Potato Marketing Plan Regulations. Definitions
  
3. All vehicles carrying potatoes that will exit Prince Edward Island via the Confederation Bridge must report to the Potato Quality Monitoring and Inspection facility in Borden-Carleton prior to proceeding to the Borden-Carleton weigh scales. Authority to require vehicles to report to Borden facility
  
4. The staff of the Board, and employees of the Canadian Food Inspection Agency, are authorized to: Authority to detain and search
  - (a) detain any vehicle which such staff and/or employees have reasonable grounds to believe is transporting potatoes produced in Prince Edward Island;
  - (b) require the driver of such vehicle to produce documentation to establish that the potatoes/potato packages are being transported in compliance with orders of the Board;
  - (c) search the vehicle for the purpose of locating and identifying all potatoes/potato packages being transported and ensure that such

vehicle is transporting potatoes/potato packages in compliance with the orders of the Board; and

- (d) inspect the potatoes/potato packages contained therein; and
- (e) seize and detain all potatoes/potato packages being transported in violation of orders of the Board, and issue a Notice of Detention in the form attached as Schedule A.

5. Board staff and/or employees of the Canadian Food Inspection Agency may attach thereto a numbered detention tag in the form attached as Schedule B and no person shall sell, offer for sale, move, allow or cause to be moved the potatoes or potato packages or remove the detention tag without written authority of the Board or the Canadian Food Inspection Agency. Detained potatoes

6. Potatoes/potato packages detained according to Section 4 or Clause 7.(2) may be released from detention once Board staff and/or employees of the Canadian Food Inspection Agency are satisfied that such potatoes or potato packages have been brought into compliance with the provisions of the Board Orders and have issued a Release from Detention Notice in the form attached as Schedule C. Release from detention

7.(1) The employees of the Department of Transportation and Public Works employed at the weigh scales at Borden/Carleton and Wood Islands are authorized to: Authority to detain and search

- (a) detain any vehicle which such employees have reasonable and probable grounds to believe is transporting potatoes produced in Prince Edward Island;
- (b) require the driver of such vehicle to produce verification that he has reported to the Potato Quality Monitoring and Inspection Facility in Borden/Carleton (in the case of vehicles intending to exit P.E.I. via the Confederation Bridge), and documentation to establish that the potatoes being transported are being transported in compliance with orders of the Board;
- (c) if such employees have reasonable and probable grounds to believe that the vehicle is transporting potatoes in violation of orders of the Board, search the vehicle for the purpose of locating and identifying all potatoes being so transported; and
- (d) seize and detain all potatoes being transported in violation of orders of the Board, and immediately notify Board staff and/or employees of the Canadian Food Inspection Agency.

7.(2) Upon receipt of the notification referred to in Clause 7.(1)(d), Board staff and/or employees of the Canadian Food Inspection Agency may proceed in the manner contemplated by Clause 4(e) and Section 5.

8. The employees of the Canadian Food Inspection Agency, and the employees of the Department of Transportation and Public Works employed at the weigh stations at Borden/Carleton and Wood Islands are appointed as agents of the Board and shall exercise all of the foregoing powers as such. Agents, powers

9. Schedules A, B and C attached hereto are approved and form part of this Order.

10. Board Order PB91-3 dated July 1, 1991 is hereby revoked.

11. This Order shall come into effect on January 20, 1999. Commencement

Dated at Charlottetown, Prince Edward Island this 14th day of January, 1999.

Robert MacDonald  
CHAIRMAN

Earle MacDonald  
SECRETARY



Schedule A

PRINCE EDWARD ISLAND POTATO BOARD

NOTICE OF DETENTION - POTATOES/POTATO PACKAGES

This Detention is made under authority of the *Natural Products Marketing Act, R.S.P.E.I. 1988, Cap. N-3, the Prince Edward Island Potato Marketing Plan Regulations, and the Agricultural Products Marketing Act (Canada).*

Date of Detention \_\_\_\_\_, \_\_\_\_\_ Time \_\_\_\_\_ A.M. \_\_\_\_\_ P.M.

Detention Issued at \_\_\_\_\_, P.E.I.

Detention Tag Number \_\_\_\_\_

Detention Issued to (Name of Dealer) \_\_\_\_\_

Address \_\_\_\_\_ Telephone Number \_\_\_\_\_

Quantity and Description of Detained Potatoes/Potato Packages \_\_\_\_\_

\_\_\_\_\_

Reason for Detention (provide complete details) \_\_\_\_\_

\_\_\_\_\_

Violation of \_\_\_\_\_

Potatoes/Potato Packages Temporarily Detained in Truck/Trailer \_\_\_\_\_

With due consideration for the proper preservation and safeguarding of the potatoes/potato packages noted above, authority as requested by \_\_\_\_\_ (Representative of Dealer) is hereby granted to move same to \_\_\_\_\_ where they shall remain until released by an Agent of the P.E.I. Potato Board.

Original of Notice to be Served to Dealer by:  Mail  Hand Delivery  Facsimile

Copies to be provided to:  Driver  Grower/Packer  P.E.I. Potato Board  CFIA

Driver Name (please print) \_\_\_\_\_ Signature \_\_\_\_\_

Issued by: Name (please print) \_\_\_\_\_ Signature \_\_\_\_\_

Schedule B

P.E.I. Potato Board

NOTICE OF DETENTION

Detention No. \_\_\_\_\_

Issued under authority of the *Natural Products Marketing Act R.S.P.E.I. 1988, Cap. N-3*, the Prince Edward Island Potato Marketing Plan Regulations, and the *Agricultural Products Marketing Act (Canada)*.

Quantity & Description of Detained Potatoes and/or Potato Packages:

\_\_\_\_\_  
\_\_\_\_\_  
\_\_\_\_\_

Violation of: \_\_\_\_\_

Date: \_\_\_\_\_ Name: \_\_\_\_\_

Signature: \_\_\_\_\_

Schedule C

PRINCE EDWARD ISLAND POTATO BOARD  
NOTICE OF RELEASE FROM DETENTION -  
POTATOES/POTATO PACKAGES

Detention Tag Number \_\_\_\_\_

Date of Release \_\_\_\_\_, \_\_\_\_\_ Time \_\_\_\_\_ A.M. \_\_\_ P.M.

Release Issued at \_\_\_\_\_, P.E.I.

Type of Release: \_\_\_ Full \_\_\_ Partial

Amount Remaining under Detention \_\_\_\_\_

Date of Detention \_\_\_\_\_, \_\_\_\_\_ Issued at \_\_\_\_\_, P.E.I.

Description and Total Quantity of Potatoes/Potato Packages Originally Detained

\_\_\_\_\_  
\_\_\_\_\_  
\_\_\_\_\_

Reason for this Release from Detention (provide complete details)

\_\_\_\_\_  
\_\_\_\_\_  
\_\_\_\_\_

Original of Notice of Release to be served to Dealer by: \_\_\_ Mail \_\_\_ Hand Delivery \_\_\_ Facsimile

Copies to be provided to: \_\_\_ Driver \_\_\_ Grower/Packer \_\_\_ P.E.I. Potato Board \_\_\_ CFIA

Comments \_\_\_\_\_

\_\_\_\_\_  
\_\_\_\_\_

Issued by: Name \_\_\_\_\_ Signature \_\_\_\_\_

Date \_\_\_\_\_ Telephone Number \_\_\_\_\_

**NOTICE OF TAX SALE**

There will be sold at a Public Auction at or near the Law Courts Building, at 108 Central Street, in Summerside, Prince Edward Island on Friday, the 12th day of February, 1999, at the hour of 12:30 in the afternoon, real property located at or near Tyne Valley, in Prince County, Prince Edward Island, being identified as Parcel No. 20610 and assessed in the name of NEIL BENT.

This property is being sold for non-payment of taxes in accordance with Section 16 of the Real Property Tax Act. A more complete legal description may be obtained by contacting the law firm of Patterson Palmer Hunt Murphy, Attention Lisa L. Goulden at (902) 888-1033, 268 Water Street, Summerside, Prince Edward Island in connection with this sale.

The said property will be sold subject to a reserve bid and conditions of sale.

DATED at Summerside, Prince County, Province of Prince Edward Island, this 15th day of January, A.D. 1999.

J.B. RAMSAY  
Provincial Tax Commissioner  
Province of Prince Edward Island

05-06

**NOTICE OF TAX SALE**

There will be sold at a Public Auction at or near the Law Courts Building, at 108 Central Street, in Summerside, Prince Edward Island on Friday, the 12th day of February, 1999, at the hour of 12:30 in the afternoon, real property located at or near Springhill, in Prince County, Prince Edward Island, being identified as Parcel No. 567651 and assessed in the name of LOMAN CAMPBELL.

This property is being sold for non-payment of taxes in accordance with Section 16 of the Real Property Tax Act. A more complete legal description may be obtained by contacting the law firm of Patterson Palmer Hunt Murphy, Attention Lisa L. Goulden at (902) 888-1033, 268 Water Street, Summerside, Prince Edward Island in connection with this sale.

The said property will be sold subject to a reserve bid and conditions of sale.

DATED at Summerside, Prince County, Province of Prince Edward Island, this 15th day of January, A.D. 1999.

J.B. RAMSAY  
Provincial Tax Commissioner  
Province of Prince Edward Island

05-06

**NOTICE OF TAX SALE**

There will be sold at a Public Auction at or near the Law Courts Building, at 108 Central Street, in Summerside, Prince Edward Island on Friday, the 12th day of February, 1999, at the hour of 12:30 in the afternoon, real property located at or near Freeland, in Prince County, Prince Edward Island, being identified as Parcel No. 29447 and assessed in the name of LILA D. CLARK.

This property is being sold for non-payment of taxes in accordance with Section 16 of the Real Property Tax Act. A more complete legal description may be obtained by contacting the law firm of Patterson Palmer Hunt Murphy, Attention Lisa L. Goulden at (902) 888-1033, 268 Water Street, Summerside, Prince Edward Island in connection with this sale.

The said property will be sold subject to a reserve bid and conditions of sale.

DATED at Summerside, Prince County, Province of Prince Edward Island, this 15th day of January, A.D. 1999.

J.B. RAMSAY  
Provincial Tax Commissioner  
Province of Prince Edward Island

05-06

**NOTICE OF TAX SALE**

There will be sold at a Public Auction at or near the Law Courts Building, at 108 Central Street, in Summerside, Prince Edward Island on Friday, the 12th day of February, 1999, at the hour of 12:30 in the afternoon, real property located at or near Unionvale, in Prince County, Prince Edward Island, being identified as Parcel No. 43042 and assessed in the name of ALLEN and KELLY CLEMENTS.

This property is being sold for non-payment of taxes in accordance with Section 16 of the Real Property Tax Act. A more complete legal description may be obtained by contacting the law firm of Patterson Palmer Hunt Murphy, Attention Lisa L. Goulden at (902) 888-1033, 268 Water Street, Summerside, Prince Edward Island in connection with this sale.

The said property will be sold subject to a reserve bid and conditions of sale.

DATED at Summerside, Prince County, Province of Prince Edward Island, this 15th day of January, A.D. 1999.

J.B. RAMSAY  
Provincial Tax Commissioner

Province of Prince Edward Island

05-06

**NOTICE OF TAX SALE**

There will be sold at a Public Auction at or near the Law Courts Building, at 108 Central Street, in Summerside, Prince Edward Island on Friday, the 12th day of February, 1999, at the hour of 12:30 in the afternoon, real property located at or near Lady Fane, in Prince County, Prince Edward Island, being identified as Parcel No. 685354 and assessed in the name of GERALD A. CRAIG.

This property is being sold for non-payment of taxes in accordance with Section 16 of the Real Property Tax Act. A more complete legal description may be obtained by contacting the law firm of Patterson Palmer Hunt Murphy, Attention Lisa L. Goulden at (902) 888-1033, 268 Water Street, Summerside, Prince Edward Island in connection with this sale.

The said property will be sold subject to a reserve bid and conditions of sale.

DATED at Summerside, Prince County, Province of Prince Edward Island, this 15th day of January, A.D. 1999.

J.B. RAMSAY

Provincial Tax Commissioner

Province of Prince Edward Island

05-06

**NOTICE OF TAX SALE**

There will be sold at a Public Auction at or near the Law Courts Building, at 108 Central Street, in Summerside, Prince Edward Island on Friday, the 12th day of February, 1999, at the hour of 12:30 in the afternoon, real property located at or near Abrams Village, in Prince County, Prince Edward Island, being identified as Parcel No. 657585 and assessed in the name of GERALDINE W. GALLANT.

This property is being sold for non-payment of taxes in accordance with Section 16 of the Real Property Tax Act. A more complete legal description may be obtained by contacting the law firm of Patterson Palmer Hunt Murphy, Attention Lisa L. Goulden at (902) 888-1033, 268 Water Street, Summerside, Prince Edward Island in connection with this sale.

The said property will be sold subject to a reserve bid and conditions of sale.

DATED at Summerside, Prince County, Province of Prince Edward Island, this 15th day of January, A.D. 1999.

J.B. RAMSAY

Provincial Tax Commissioner

Province of Prince Edward Island

05-06

**NOTICE UNDER THE QUIETING TITLES ACT**

TAKE NOTICE that DAVID BLACQUIERE and SANDRA BLACQUIERE both of Welland, Province of Ontario, claim to be the absolute owners in fee simple of the lands hereinafter described;

AND TAKE NOTICE that an application has been made to the Supreme Court of the Province of Prince Edward Island on behalf of David Blacquiere and Sandra Blacquiere to have the title judicially investigated and validity thereof ascertained and declared to the lands and premises described as follows:

ALL THOSE PARCELS of land situate, lying and being on Lot 21, New London, in Queens County, Prince Edward Island, bounded and described as follows:

**PARCEL 1**

COMMENCING at a point situate on the western edge of the Road leading from Clifton Corner to Clifton Bridge, and in the northeast corner of a lot of land in possession of Aubrey Found; THENCE running westwardly along the northern boundary of said Found's land a distance of one hundred and five (105) feet;

THENCE northwardly and parallel with said Clifton Bridge Road a distance of eighty (80) feet;

THENCE eastwardly and parallel with said Found's north boundary one hundred and five (105) feet to the aforesaid Road;

THENCE southwardly along said Road to the point at the place of commencement, containing by estimation eight thousand four hundred square feet of land.

**PARCEL 2**

COMMENCING on the west side of the Graham's Road at a point in the south boundary line of land now in the possession of Harold Dunning at the distance of one hundred and ninety-six (196) feet from the junction of the said Road with the north side of the Clinton Road and continuing thence southwardly along the west side of the Graham's Road for the distance of twenty-two (22) feet to a point;

THENCE westwardly at right angles to the Graham's Road and parallel to the Clinton Road

aforesaid for the distance of one hundred and five (105) feet;

THENCE northwardly parallel with the Graham's Road for the distance of twenty-two (22) feet or to land owned by Harold Dunning and thence along the said Harold Dunning's south boundary line to the place of commencement.

**PARCEL 3**

BOUNDED on the east by the Road leading from Clifton to the Bridge, on the south by land of Margaret MacKenzie and on the north and west by land now or formerly in possession of William Montgomery, having a front of forty (40) feet on said Road and running back westerly one hundred and five (105) feet and containing four hundred and sixty-six (466) square yards of land, a little more or less, and being land held in possession for many years by John Gunn, deceased. Being erroneously described in later deeds as having a frontage of fifty (50) feet.

The above lands are also described as follows: ALL THAT PARCEL of land situate, lying and being in New London, Lot 21, Queens County, Province of Prince Edward Island, and

COMMENCING at a point on the westerly margin of a sixty-six (66') foot wide Provincial Highway, Route No. 20, said point being marked 3009 as delineated on a "Plan of Survey Showing Lands Claimed by David & Sandra Blacquiere", prepared by Locus Surveys Ltd., dated September 30, 1998 as Drawing No. 98411, said point having co-ordinates E. 370893.687, N. 414244.336;

THENCE on an azimuth of 163° 13' 06" along the west boundary of Route No. 20 for the distance of one hundred and thirty-seven point five five feet (137.55") to a point marked 3010 having co-ordinates E. 370933.400, N. 414112.648;

THENCE on a azimuth of 251° 44' 27" for the distance of ninety-six point zero six feet (96.06') to a point marked 3011 having co-ordinates E. 370842.178, N. 414082.551;

THENCE on an azimuth of 344° 03' 58" for the distance of one hundred and forty point zero two feet (140.02') to a point marked 1470 having co-ordinates E. 370803.740, N. 414217.187;

THENCE on an azimuth of 73° 12' 16" for the distance of ninety-three point nine five feet (93.95') to a point marked 3009 being the point or place of commencement and having an area of 0.30 acres a little more or less.

Further particulars and the above-noted Survey Plan are available at the Office of Donald

Schurman, Solicitor for David Blacquiere and Sandra Blacquiere.

ANY PERSON claiming adverse title or interest in the said lands is to file notice of the same with the Prothonotary of the Supreme Court in the Law Courts Building at Summerside in Prince County, Prince Edward Island on or before the 1st day of March, 1999.

AND FURTHER TAKE NOTICE that if no claim to the said lands, adverse to that of David Blacquiere and Sandra Blacquiere, is filed on or before the 1st day of March, A.D. 1999, a Certificate of Title certifying that David Blacquiere and Sandra Blacquiere are the legal and beneficial owner is fee simple of the said lands, will be granted pursuant to the provisions of the Quieting of Titles Act.

DATED at Summerside this 19th day of January, A.D. 1999.

DONALD SCHURMAN  
Barrister & Solicitor  
21 Harvard Street  
Summerside, P.E.I.  
C1N 1P3

05

**CRIMINAL CODE OF CANADA  
QUALIFIED TECHNICIANS**

Under authority vested in me by Section 254(1) of the Criminal Code of Canada, I hereby designate:

Flood, Cst. John Brendon  
Misener, Cst. Greg P.  
Corish, Cst. Dale Alan  
McMahon, Cst. Shawn

as "Qualified Technicians", qualified to operate an approved instrument in respect of breath samples within the meaning of Section 254(1) of the Criminal Code of Canada.

Dated this 20th day of January, 1999.

J. WESTON MacALEER  
Attorney General

Province of Prince Edward Island

05

**NOTICE OF APPLICATION FOR  
LEAVE TO SURRENDER CHARTER**

CANADA  
PROVINCE OF  
PRINCE EDWARD ISLAND

IN THE MATTER of the Companies Act being Chap. C-14 of the Revised Statutes of Prince Edward Island, 1988, and amendments thereto, and of the application of Wigmore Insurance Agency Ltd. For a surrender of its Charter.

WIGMORE INSURANCE AGENCY LTD., body corporate, duly incorporated under the provisions of the Companies Act of the Province of Prince Edward Island hereby gives notice pursuant to the Companies Act of the Province of Prince Edward Island that it intends to make an application to the Director of Corporations for Leave to Surrender the Charter of the said company as and from a date to be fixed.

DATED at Charlottetown, Queens County, Prince Edward Island, this 22nd day of January, 1999.

JOHN W. HENNESSEY  
Foster, O'Keefe  
Barristers & Solicitors  
129 Water Street, P.O. Box 38  
Charlottetown PE C1A 7K2  
Solicitor for the Applicant

05

#### NOTICE OF DISSOLUTION

Partnership Act  
R.S.P.E.I. 1988, Cap. P-1

Public Notice is hereby given that a Notice of Dissolution has been filed under the Partnership Act for each of the following:

#### ABEGWEIT CRESTING

Owner: Thompson & Moore Ltd.  
Registration Date: January 21, 1999

#### AVONLEA VILLAGE

Owner: Raspberry Cordial Inc.  
Registration Date: January 22, 1999

#### GAMEWORLD

Owner: Modoud Mohseni  
Registration Date: January 21, 1999

#### J & N DENTAL SERVICES

Owner: Nicole Whitty  
Registration Date: January 19, 1999

05

#### NOTICE OF REGISTRATION

Partnership Act  
R.S.P.E.I. 1988, Cap. P-1, s.52 and s.54(1)

Public Notice is hereby given that the following Statutory Declarations have been filed under the Partnership Act:

#### ABEGWEIT OUTFITTING CO.

Owner: Thompson & Moore Ltd.  
P.O. Box 1174  
Cornwall, PE C0A 1H0  
Registration Date: January 22, 1999

#### ADVANCED REPAIR TECHNOLOGY

Owner: Trevor MacDonald  
15 Newland Crescent  
Charlottetown, PE C1A 4H4  
Registration Date: January 18, 1999

#### AVONLEA VILLAGE

Owner: Linkletter (P.E.I.) Ltd.  
101 Watts Avenue  
Charlottetown, PE C1E 2B7  
Registration Date: January 22, 1999

#### ANTIQUES 'N THINGS

Owner: Clifton Holdings Inc.  
RR 6  
Kensington, PE C0B 1M0  
Registration Date: January 22, 1999

#### CANADIAN CULINARY INSTITUTE

Owner: Holland College  
140 Weymouth Street  
Charlottetown, PE C1A 4Z1  
Registration Date: January 20, 1999

#### CONFEDERATION MOTORS

Owner: Terry L. Sock  
Box 1058  
Cornwall, PE C0A 1H0  
Registration Date: January 25, 1999

#### CULINARY INSTITUTE OF CANADA

Owner: Holland College  
140 Weymouth Street  
Charlottetown, PE C1A 4Z1  
Registration Date: January 20, 1999

#### DIAMOND BLADE

Owner: Gordon and Tracy Douglas  
119 MacKinley Crescent  
Cornwall, PE C0A 1H0  
Registration Date: January 22, 1999

#### ESSENCE OF THYME



Owner: Stefan Czapalay  
644 Water Street  
Summerside, PE C1N 5W8  
Registration Date: January 22, 1999

**57 WHATEVER**

Owner: Anthony I. Veder  
42 University Avenue  
Charlottetown, PE C1A 4K6  
Registration Date: January 22, 1999

**FUNDY'S BUSINESS FUSION DES  
AFFAIRES**

Owner: Fundy Cable Ltd./Ltee  
199 Chesley Drive  
Saint John, NB E2K 4S9  
Registration Date: January 22, 1999

**FUSION DATA**

Owner: Fundy Cable Ltd./Ltee  
199 Chesley Drive  
Saint John, NB E2K 4S9  
Registration Date: January 22, 1999

**FUSION INTERNET**

Owner: Fundy Cable Ltd./Ltee  
199 Chesley Drive  
Saint John, NB E2K 4S9  
Registration Date: January 22, 1999

**FUSION VOICE**

Owner: Fundy Cable Ltd./Ltee  
199 Chesley Drive  
Saint John, NB E2K 4S9  
Registration Date: January 22, 1999

**GAMEWORLD**

Owner: Sandra Mohseni  
124 Rosedale Avenue  
Halifax, NS B3N 2J7  
Registration Date: January 21, 1999

**GRANVILLE AUTO CENTER**

Owner: Centennial Motors Ltd.  
610 South Drive  
Summerside, PE C1N 3Z7  
Registration Date: January 18, 1999

**ISLAND ORTHODONTICS**

Owner: Nicole E. Whitty  
19 Queens Road  
Cornwall, PE C0A 1H0

84 Dufferin Avenue  
Saint John, NB E2K 2T8  
Registration Date: January 22, 1999

**LINGO FOR BUSINESS D'AFFAIRES**

Owner: Fundy Cable Ltd./Ltee  
199 Chesley Drive  
Saint John, NB E2K 4S9  
Registration Date: January 22, 1999

**MEDECO OF CANADA**

Owner: Assa Abloy of Canada Ltd./Assa  
Abloy du Canada Ltee.  
3475 14th Avenue  
Markham, ON L3R 0H4  
Registration Date: January 21, 1999

**ROSE GARDEN ANTIQUES &  
COLLECTIBLES**

Owner: Rosemary Cantin  
107 Newson Court  
Summerside, PE C1N 5H8  
Registration Date: January 20, 1999

**SANDYRAE FARMS**

Owner: Daniel A. MacKinnon  
RR 1  
Montague, PE C0A 1R0  
Registration Date: January 22, 1999

**SARGENT OF CANADA**

Owner: Assa Abloy of Canada Ltd./Assa  
Abloy du Canada Ltee.  
3475 14th Avenue  
Markham, ON L3R 0H4  
Registration Date: January 21, 1999

**T. ALLEN & ASSOCIATES**

Owner: Tracey Allen  
10 Doc Blanchard Crescent  
Charlottetown, PE C1A 9K3  
Registration Date: January 21, 1999

05

**NOTICE OF GRANTING  
LETTERS PATENT**

Companies Act  
R.S.P.E.I. 1988, Cap. C-14, s.11

Robert H. Young

Public Notice is hereby given that under the Companies Act Letters Patent have been issued by the Minister of Community Services & Attorney General to:

100176 P.E.I. INC.  
BDC Place, 119 Kent Street, Suite 600  
Charlottetown, PE C1A 1N3  
Incorporation Date: January 20, 1999

GARMAC INVESTMENTS LTD.  
494 Granville Street  
Summerside, PE C1N 4K4  
Incorporation Date: January 21, 1999

LIVINGSTON ESTATES INC.  
68 Kensington Road  
Charlottetown, PE C1A 5J2  
Incorporation Date: January 20, 1999

MAMMOUTH ENTERPRISES LTD.  
33 Glencove Drive  
Stratford, PE C1A 7T4  
Incorporation Date: January 21, 1999

MARITIME BEEF DEVELOPMENT AND  
MARKETING GROUP INC.  
420 University Avenue  
Charlottetown, PE  
Incorporation Date: January 18, 1999

MINI-MILLS LTD.  
RR 1  
Belfast, PE C0A 1A0  
Incorporation Date: January 15, 1999

SYSCOM INC.  
106 Kensington Road  
Charlottetown, PE C1A 5J5  
Incorporation Date: January 19, 1999

been issued by the Minister of Community Services & Attorney General to:

STEPHEN LANK ENTERPRISES INC.  
Purpose: To increase the authorized capital of the Company.

Effective Date: January 18, 1999  
05

---

**NOTICE OF GRANTING  
SUPPLEMENTARY LETTERS PATENT**  
Companies Act  
R.S.P.E.I. 1988, Cap. C-14, s.18, s.3

Public Notice is hereby given that under the Companies Act supplementary letters patent have

**NOTICE OF CHANGE  
OF CORPORATE NAME**

Companies Act  
R.S.P.E.I. 1988, CAP. C-14, S. 81.1

Public Notice is hereby given that under the Companies Act the following corporation has changed its corporate name:

EASTERN QUEENS BUSINESS  
DEVELOPMENT ASSOCIATION INC.  
Former Name

STRATFORD AND AREA BUSINESS  
ASSOCIATION INC.

New Name  
Effective Date: January 13, 1999  
05

**PROCLAMATION**

CANADA  
PROVINCE OF  
PRINCE EDWARD ISLAND

*(Great Seal)*

ELIZABETH THE SECOND, by the Grace of God of the United Kingdom, Canada and Her other Realms and Territories, QUEEN, Head of the Commonwealth, Defender of the Faith.

Hon. NORMAN H. CARRUTHERS  
Administrator

TO ALL TO WHOM these presents shall come or whom the same may in any wise concern:

GREETING

A PROCLAMATION

WHEREAS in and by section 2 of Chapter 6 of the Acts passed by the Legislature of Prince Edward Island in the 2nd Session thereof held in the year 1998 and in the forty-seventh year of Our Reign intituled "An Act to Amend the Rental of Residential Property Act" it is enacted as follows:

"This Act comes into force on a date as may be fixed by proclamation of the Lieutenant Governor in Council.",

AND WHEREAS it is deemed expedient that the said Act, Stats. P.E.I. 1998, c. 6 should come into force on the 19th day of January, 1999,

NOW KNOW YE that We, by and with the advice and consent of our Executive Council for Prince Edward Island, do by this Our Proclamation ORDER AND DECLARE that the said Act being "An Act to Amend the Rental of Residential Property Act" passed in the forty-seventh year of Our Reign shall come into force on the nineteenth day of January, one thousand nine hundred and ninety-nine of which all persons concerned are to take notice and govern themselves accordingly.

IN TESTIMONY WHEREOF We have caused these Our Letters to be made Patent and the Great Seal of Prince Edward Island to be hereunto affixed.

WITNESS the Honourable Norman H. Carruthers, Administrator of the Province of Prince Edward Island, at Charlottetown this nineteenth day of January in the year of Our Lord one thousand nine hundred and ninety-nine and in the forty-seventh year of Our Reign.

By Command,

LYNN E. ELLSWORTH  
Clerk of the Executive Council

05

**INDEX TO NEW MATTER  
January 30th, 1999**

Executor's Notices:

Lannan, Albert Francis . . . . .	105
MacMillan, Grace Jean . . . . .	105
MacMillan, H. Noel . . . . .	105
Mahar, Francis W. . . . .	105
Mills, Russell . . . . .	105
Morash, Diane . . . . .	105
Rose, Trent P. . . . .	105

Administrator's Notices:

Harrington, Luella E. . . . .	106
-------------------------------	-----

MacNeill, Jean .....	106	57 Whatever .....	127
MacNeill, Malcolm (Sr.) .....	106	Fundy's Business Fusion des Affaires .	128
Matheson, George P. ....	106	Fusion Data .....	128
Matheson, Mary Ann .....	106	Fusion Internet .....	128
Public Notice of Pending Road Closure ..	115	Fusion Voice .....	128
Board Order		Gameworld .....	128
PEI Marketing Council		Granville Auto Center .....	128
Price Determination Order		Island Orthodontics .....	128
MC99-1 .....	117	Lingo for Business D'Affaires .....	128
PEI Potato Board		Medeco of Canada .....	128
Detention and Search of Vehicles Order		Rose Garden Antiques &	
PB99-2 .....	118	Collectibles .....	128
Notices of Tax Sales:		Sandyrae Farms .....	128
Property of Neil Bent .....	124	Sargent of Canada .....	128
Property of Loman Campbell .....	124	T.Allen & Associates .....	128
Property of Lila D. Clark .....	124	Notice of Granting Letters Patent:	
Property of Allen and Kelly Clements .	124	100176 P.E.I. Inc. ....	128
Property of Gerald A. Craig .....	125	Garmac Investments Ltd. ....	129
Property of Geraldine W. Gallant .....	125	Livingston Estates Inc. ....	129
Notice Under the Quieting Titles Act:			
Land of David Blacquiere and			
Sandra Blacquiere .....	125		
The Criminal Code of Canada			
Qualified Technicians:			
Flood, Cst. John Brendon .....	126		
Misener, Cst. Greg P. ....	126		
Corish, Cst. Dale Alan .....	126		
McMahon, Cst. Shawn .....	126		
Notice of Application for			
Leave to Surrender Charter:			
Wigmore Insurance Agency Ltd. ....	126		
Notice of Dissolution of Partnership:			
Abegweit Cresting .....	127		
Avonlea Village .....	127		
Gameworld .....	127		
J & N Dental Services .....	127		
Notice of Registration of Partnership:			
Abegweit Outfitting Co. ....	127		
Advanced Repair Technology .....	127		
Avonlea Village .....	127		
Antiques 'N Things .....	127		
Canadian Culinary Institute .....	127		
Confederation Motors .....	127		
Culinary Institute of Canada .....	127		
Diamond Blade .....	127		
Essence of Thyme .....	127		

---

---

Mammoth Enterprises Ltd. . . . .	129
Maritime Beef Development and Marketing Group Inc. . . . .	129
Mini-Mills Ltd. . . . .	129
Syscom Inc. . . . .	129
Notice of Granting	
Supplementary Letters Patent:	
Stephen Lank Enterprises Inc. . . . .	129
Notice of Change of Corporate Name:	
Stratford and Area Business Association Inc. . . . .	129
Proclamation:	
An Act to Amend the Rental of Residential Property Act . . . . .	129

---

---

The ROYAL GAZETTE is issued every Saturday from the office of Beryl J. Bujosevich, Queen's Printer, P. O. Box 2000, Charlottetown, P.E.I., C1A 7N8

All copy must be received by the Tuesday preceding day of publication. The subscription rate is \$45.00 per annum, postpaid; single copies \$1.00 each, postpaid or \$ .75 each, over the counter.

---

**PART II**  
**REGULATIONS**

---

**ERRATUM**

**NOTICE**  
**RELATING TO**  
**PLANNING ACT REGULATIONS**  
**AMENDMENT**

Notice is hereby given of an error in the Planning Act Regulations Amendment appearing on page 2, Part II of Volume CXXV- No. 3 of the Royal Gazette dated January 16, 1999. The statutory citation should have indicated that the regulations were made pursuant to subsection 8(1) of the *Planning Act* (not section 8.1) R.S.P.E.I. 1988, Cap. P-8. Order-in-Council EC1999-11 of 5 January 1999 has been reissued to correct this error.

Lynn E. Ellsworth  
Clerk of the Executive Council

---

---

---

**PART II**  
**REGULATIONS INDEX**

Chapter Number	Title	Original Order Reference	Amendment	Authorizing Order and Date	Page
P-8	<b>Planning Act</b> Regulations	EC601/77	ERRATUM (to correct EC1999-11 of Jan. 5/99)		5