

Canada – Saskatchewan Water Supply Expansion Program

Application Guide – On-Farm Infrastructure (Tier 1)

To ensure that your application is complete and contains the information required for assessing the proposal, please follow the instructions below in answering Parts A to C of the Canada-Saskatchewan Water Supply Expansion program (CSWSEP) application form. If there is insufficient space on the application form to respond to the questions, please attach additional pages as necessary.

ALL project proposals will be reviewed for compliance with the screening criteria of the program. Proposals which do not meet the screening criteria will be rejected. Projects which meet the screening criteria will then be rated for the benefits it provides to you, others and the environment. Only those projects which best meet the rating criteria will be approved for funding. As such, it is in the best interest of the applicant to fully complete all questions.

Part A:

Complete all boxes in Part A which apply.

- List **ALL** applicants in the Applicant Name box
- Provide either your Social Insurance, Business or GST number
- Include your mailing address, telephone number(s) and other contact numbers, if applicable
- Include the legal land descriptions for your residence and project
- Give the name and number of the municipality in which your project will be constructed

Part B:

Question 1

- Check the box that best describes your farm/ranch operation.
- Specify how much land you are currently farming (in acres) including owned, leased and rented land.

Question 2

- Check appropriate boxes and complete the table. **Example:**

Livestock Use <input checked="" type="checkbox"/> Yes <input type="checkbox"/> No			Irrigation <input type="checkbox"/> Yes <input checked="" type="checkbox"/> No			Other Water Uses <input checked="" type="checkbox"/> Yes <input type="checkbox"/> No	
Livestock Type	Current Number	Future Number	Type of Crop Irrigated	Present Acres Irrigated	Future Acres Irrigated	Description of Water Use	Present Requirements (Volume in gallons per day)
Beef	85	125				Commercial	
Dairy						Crop Spraying	3000
Hogs						Greenhouse	
Poultry						Processing	
Other (Specify type)						Other (Specify type)	

NOTE: The “Future Number” means the anticipated size of your herd in the future. *e.g.:* You now have 85 cows and you are increasing by 40 to a total number of 125 cows.

- Check “yes” or “no”. If “yes”, please provide number of users.

Question 3

Check all boxes that describe your water-related problem. *e.g.:* If your existing well is not able to supply adequate water for your house and livestock requirements, check Unreliable Supply.

Check all boxes that describe the intended use of your supply: *e.g.:* If your project is for a proposed expansion of your livestock herd, check New Development/Expansion.

Question 4

- a) Check “yes” or “no”. If “no”, provide details. *e.g.:* I have previously constructed a surface run-off dugout but in years of low run-off, we experience water shortages.
- b) Check “yes” or “no”. If “yes”, provide date completed.
- c) Check “yes” or “no”. If “yes”, do you have the Water License/Permit #? Check “yes” or “no”. If yes, provide the Water License/Permit #.

NOTE: There are no licensing requirements for uses of 5.0 dam³ or less. However, anything defined as works (e.g. dams) requires approval with the exception of domestic dugouts and wells. If you are not sure, it is the applicant’s responsibility to contact the local provincial water licensing agency.

Question 5

- a) Check the box(es) which best describes your project.
- b) Provide a detailed description of your project. *e.g.:* My proposal is to construct a 260 foot drilled well. I will contract a licensed well driller to do an e-log test hole to 300 feet. Subject to satisfactory test results, the contractor will install a 260 foot drilled well with 5” diameter PVC casing and 10 feet of stainless steel well screen. The hole opening outside the well casing will be grouted between ground level and the top of the water bearing zone to provide aquifer protection. The existing well will be sealed off and abandoned.

The well, when completed, will allow me to provide water, year round, for my proposed livestock expansion and for 10 days of crop spraying.

NOTE: Your project description should describe activities which will protect the environment and the water supply as shown in this example.

Question 6

Provide details on the benefits that will be derived by you, others and/or the environment. *e.g.:* The development of a reliable supply of good quality water will make the proposed expansion of my livestock operation possible and improve farm income. The old well, which is in poor condition, will be properly sealed and abandoned to protect the water supply.

Question 7

- a) Provide a sketch showing the approximate location of the proposed project and its relative position with respect to the listed features if located on the same parcel. **Please provide as much detail as possible.**

Example: Show approximate distances where possible.

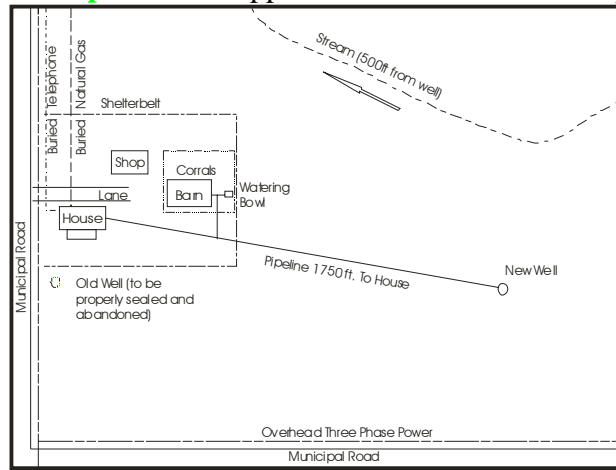

NOTE: To be environmentally sustainable, the projects must be constructed a safe distance away from potential contaminant sources such as septic fields, barns, corrals, manure storage, municipal lagoons and landfill sites, to name a few.

- b) If applicable, estimate the distance between the project and the nearest natural water body (river, stream, lake or permanent wetland).

Question 8

Check “yes” or “no”. If “yes”, provide details. *e.g.:* Does this proposal affect another landowner’s property or water supply either during construction or after it is completed?

Question 9

- a) List the main project components and estimated cost – provide as much detail as possible. *e.g.:* size, depth, etc.

Example:

Project Components	Estimated Costs (\$)
1) Electric log test hole to 300 feet	\$ 2,400.00
2) 260 foot drilled well with 5” dia PVC casing and 10 feet of stainless	
3) Steel well screen	\$ 8,900.00
4) Grouting	\$ 200.00
5)	
Total Project Cost	\$11,500.00

NOTE: If you are doing more than one project, you must complete an application form for each.

- b) Provide proposed start date and completion date to confirm that the project has a reasonable work plan.

- c) Provide an estimate of your financial commitment and an estimate of funding being requested through this program.

NOTE: Financial assistance is 1/3 of eligible costs to a maximum of **\$5,000.00**.

List any other sources of funding that may contribute to this project. *e.g.: Ducks Unlimited, Sask Power, Canada-Saskatchewan Farm Stewardship Program, etc.*

NOTE: The sum of money from all sources should not exceed the Total Estimated Project Costs given in Question 9 a).

Part C:

ALL applicants listed in Part A must sign and date. *If there are two applicants, both must sign and date the application.*

Please read Part C and Part D thoroughly before you sign so that you understand the conditions for Financial Assistance. If you have any questions, please call 1-800-667-8567 or the nearest PFRA District Office.