

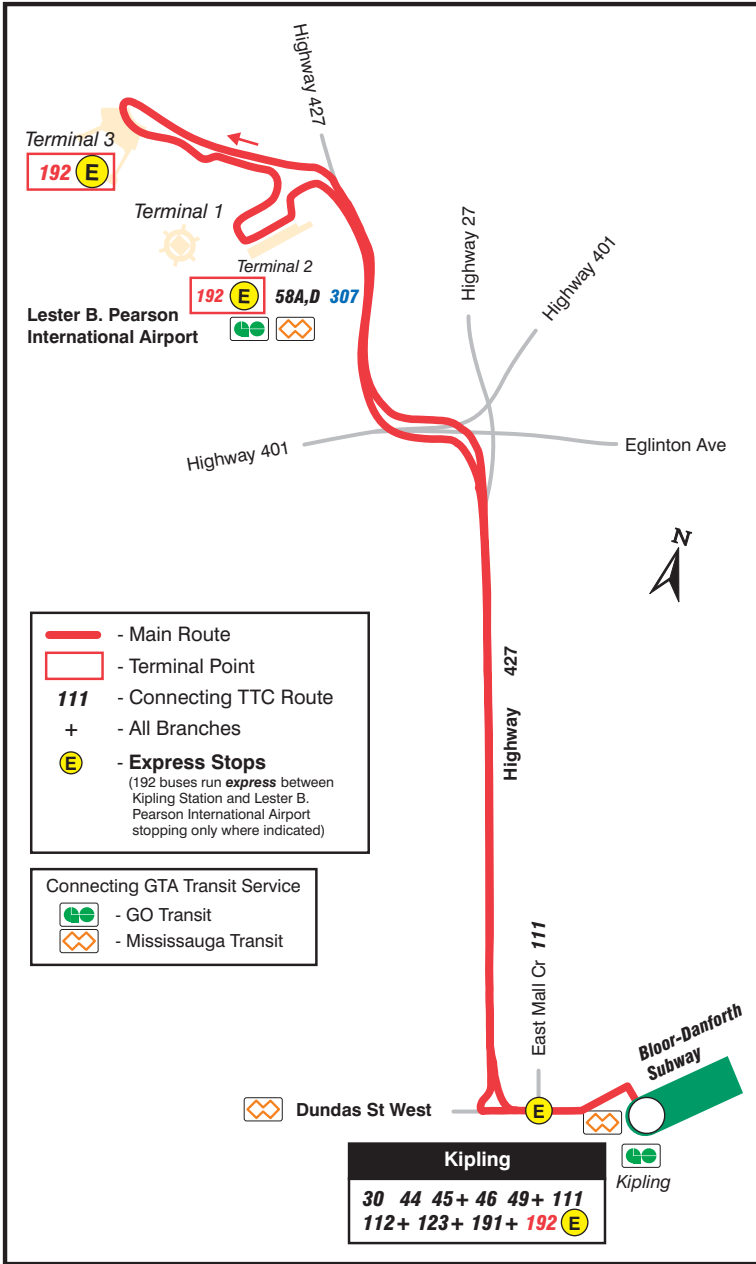

192 Airport Rocket



Effective February 17, 2002



Service reliability improvement

The schedule will be changed, to improve the reliability of the service. Departure times from the airport will be changed slightly. There will be no change to departure times from Kipling Station, or to the overall service levels.

Trips depart Kipling Station at:

*5:40 a.m., *6:25, *7:10, *7:55, 8:40, 9:25, 10:10, 10:55, 11:40 a.m., 12:25 p.m., 12:47, 1:10, 1:32, 1:55, 2:17, 2:40, 3:02, 3:25, 3:47, 4:10, 4:32, 4:55, 5:17, 5:40, 6:02, 6:25, 6:47, 7:10, 7:32, 7:55, 8:17, 8:40, 9:03, 9:25, 9:48, 10:10, 10:55, 11:40 p.m., 12:25 a.m.

Trips depart from Terminal 3 (arrivals level) at:

*5:52 a.m., *6:37, *7:22, *8:07, 8:52, 9:38, 10:23, 11:08, 11:53 a.m., 12:38 p.m., 1:00, 1:23, 1:45, 2:08, 2:30, 2:53, 3:15, 3:38, 4:00, 4:23, 4:45, 5:08, 5:30, 5:53, 6:15, 6:38, 7:00, 7:23, 7:45, 8:08, 8:29, 8:50, 9:13, 9:35, 9:58, 10:20, 11:05, 11:50 p.m., 12:35 a.m.

Trips depart from Terminal 2 (arrivals level) three minutes after Terminal 3.

*These trips operate Monday to Saturday only. All other trips operate every day.

Service Summary

192 - Kipling Station ↔ Air Terminals 2 & 3				
	Monday-Friday	Saturday	Sunday	
☀ First Trip	Northbound Southbound 5:40 a.m. 5:52 a.m.	☀ First Trip Northbound Southbound 5:40 a.m. 5:52 a.m.	Northbound Southbound 8:40 a.m. 8:52 a.m.	Northbound Southbound 8:40 a.m. 8:52 a.m.
6 am-9 am	every 45 min	6 am-8 am	every 45 min	every 45 min
9 am-3 pm	every 22-23 min	8 am-12 noon	every 22-23 min	every 45 min
3 pm-7 pm	every 22-23 min	12 noon-7 pm	every 22-23 min	every 22-23 min
7 pm-10 pm	every 22-23 min	7 pm - 10 pm	every 22-23 min	every 22-23 min
10 pm-1 am	every 45 min	10 pm- 1 am	every 45 min	every 45 min
🌙 Last Trip	Northbound Southbound 12:25 a.m. 12:35 a.m.	🌙 Last Trip	Northbound Southbound 12:25 a.m. 12:35 a.m.	Northbound Southbound 12:25 a.m. 12:35 a.m.

Times shown are approximate, and are a guide only.

- This map available at:**
- Internet: www.ttc.ca, click Service, select your route.
 - Faxback: Call 416-393-4636, Press 1, enter your route number.
 - Infopost: At major bus & streetcar stops and transfer points.

How to TTC to where you're going?
Call 416-393-4636. Operator assistance (8:00 a.m. - 6:00 p.m.); recorded and fax information 24 hours, seven days a week.

Request Stop Program
Allows women travelling alone on buses between 9:00 p.m. - 5:00 a.m. to ask the driver to let them get off the bus at locations between the regular TTC stops.

TTC's Blue Night Network
Service is provided from approximately 1:30 a.m. to 5:00 a.m. on a basic network of routes throughout Toronto, at stops with reflective blue bands. Service is provided every 30 minutes or better.

Need TTC Maps & Information?

www.ttc.ca   **416-393-INFO**

192-AK