

## CURVED CHUTE CORRAL

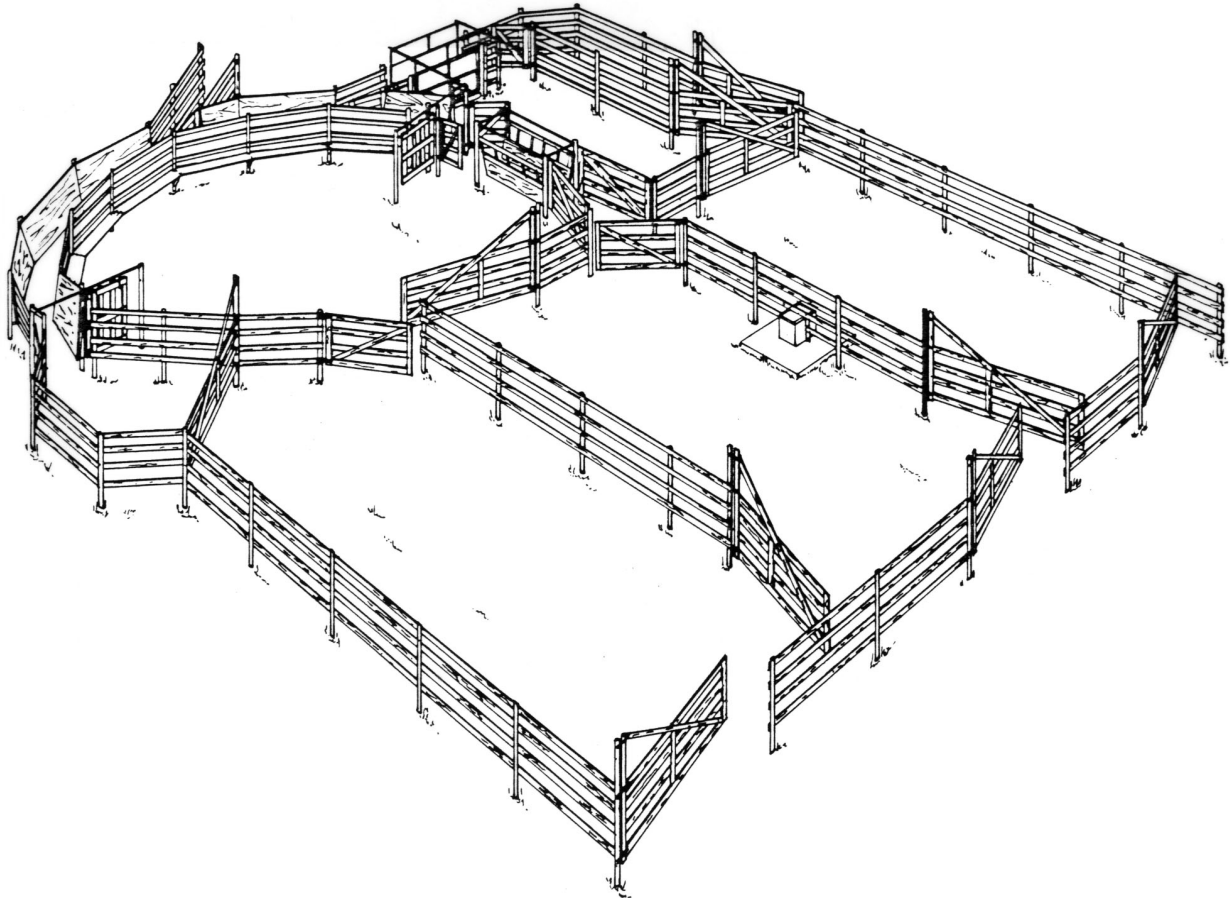

This plan is a handling facility for cow-calf operators and feedlot operations. A loading chute, squeeze, headgate, and scale is incorporated in this facility. The scale and scale cage is offset from the main working chute.

The curved, wedged chute is an effective method for moving cattle. It can handle all sizes of cattle from mature cows to 400-pound calves. At the headgate exit it is possible to sort in four different directions.

The loading chute can be located anywhere along the curved working chute or after the scale.

Six inch top diameter pressure treated posts 8'-0" long are placed at 8'-0" centers on the outside radius of 20'-11" for both wedged and straight wall chutes. For wedge shaped chutes, the inside radius is 17'-4" and for straight wall chutes the inside radius is 17'-8". For narrowing the inside width of a straight wall chute for handling young cattle, filler panels can be used. Construct with 4' x 8' plywood sheathing nailed to a 2 x 6 frame.

The catwalk is placed to help inspection, treatment, and prodding of animals through the chute.

Handling facilities should be located in a dry, well drained area.

DEVELOPED BY SASKATCHEWAN AGRICULTURE

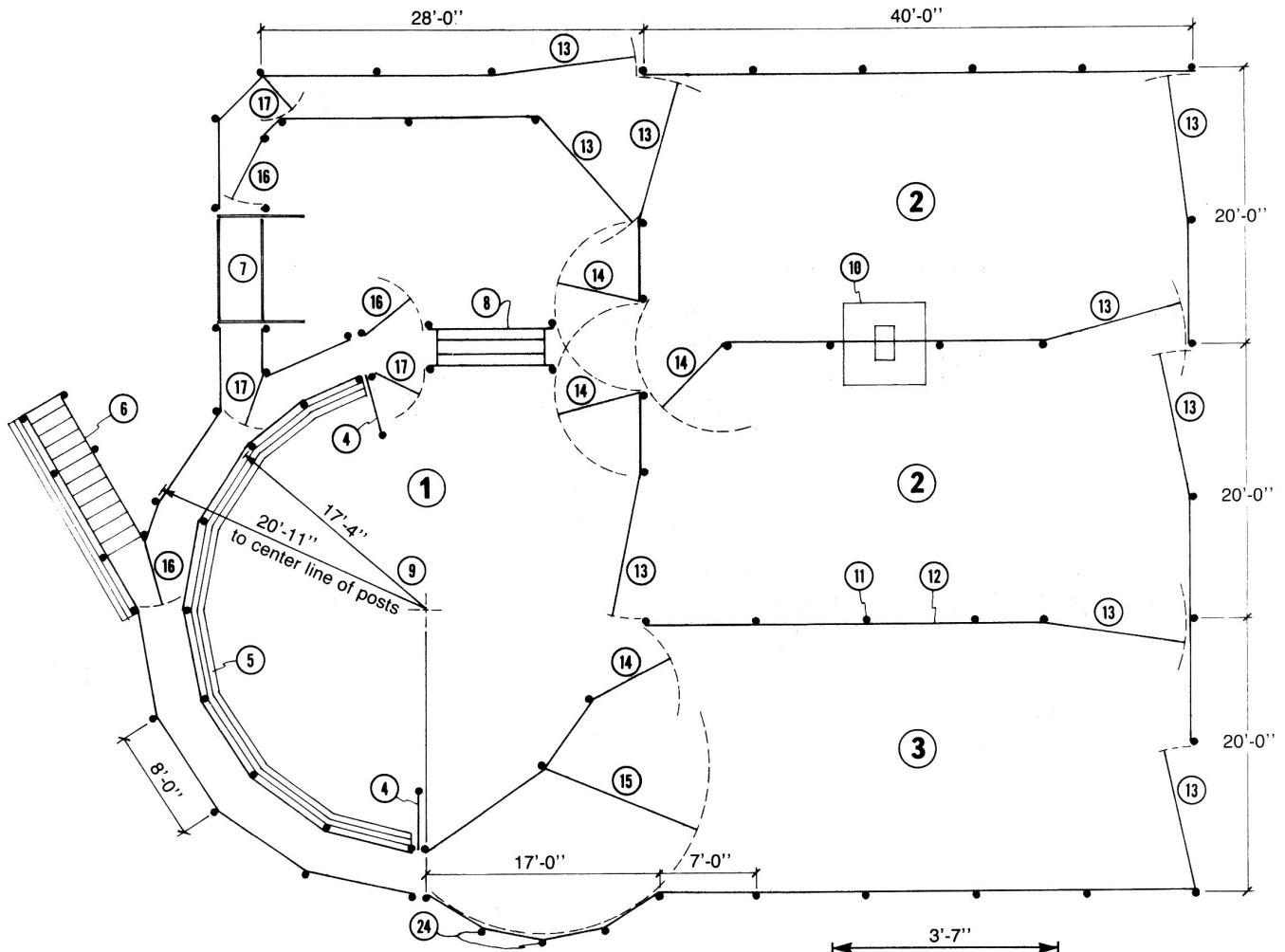

**Corral and Chute Plan**

- 1 Working area – water hydrant and building for medical supplies and treatment equipment may be located here
- 2 Holding pen – 40 head
- 3 Crowding pen – 50 head
- 4 blocking gate – see 315-04
- 5 catwalk
- 6 loading chute
- 7 scale and scale cage – see 315-06
- 8 cattle squeeze and headgate
- 9 if wedged chute is not desired, place posts 39" o.c. apart using 17'-8" radius for inside post centers
- 10 waterer and concrete pad
- 11 6" top Ø x 8'-0" long pressure treated posts
- 12 4 rail fence – 5'-0" high, see 315-01
- 13 10'-0" gate
- 14 6'-0" gate
- 15 12'-0" crowding gate – see 315-02
- 16 4'-0" gate
- 17 gate – size as required
- 18 2" x 6" chute rails
- 19 4' x 8' x 3/4" pressure treated plywood
- 20 2" x 4" x 4' long wedge – shape nailers at each post

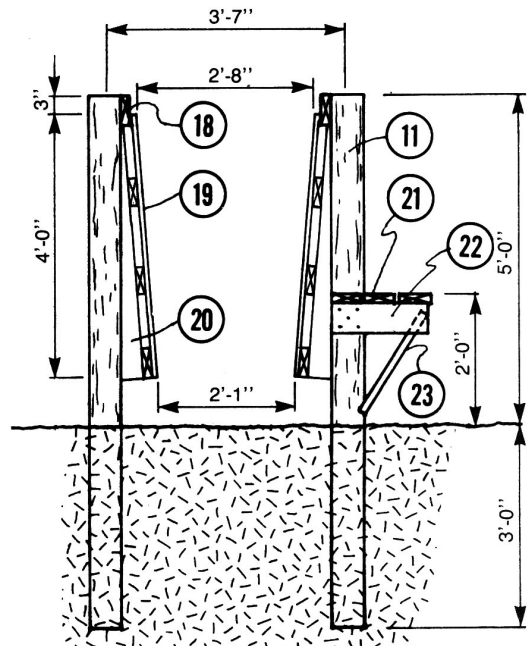

**Working Chute Cross-Section**

- 21 2" x 6" catwalk planks
- 22 2" x 6" x 18" struts each side of post
- 23 2" x 6" brace
- 24 Crowding gate pin points