

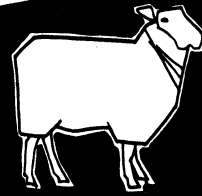

BRITISH  
COLUMBIA

Ministry of Agriculture, Food and Fisheries

Agricultural Building Systems Handbook



PLAN

352-24

# WALK THROUGH SHEEP FEEDER

COMPLETE INSTRUCTIONS

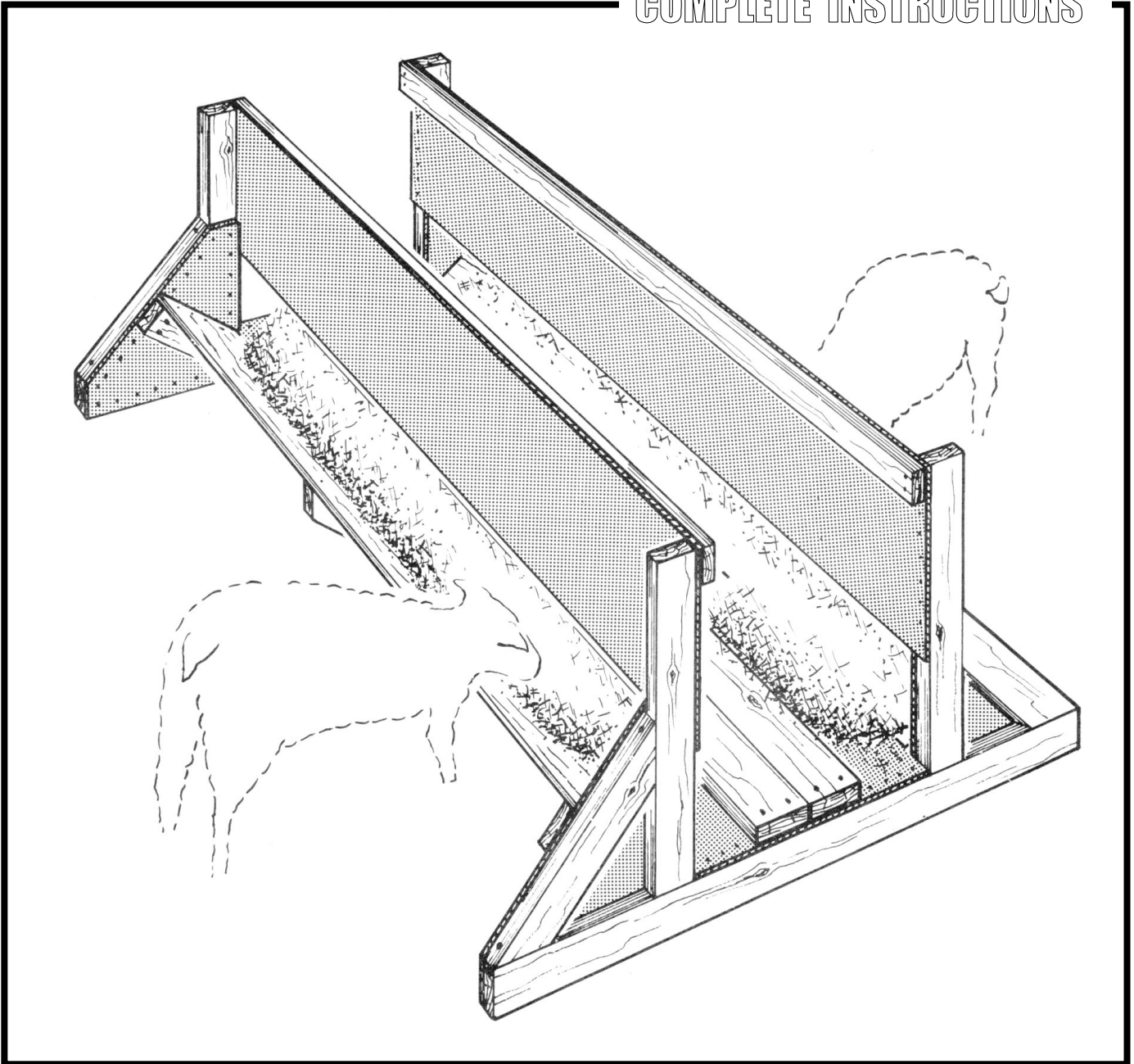

DEVELOPED BY CANADA PLAN SERVICE

# WALK THROUGH SHEEP FEEDER

CPS  
 PLAN 4622 NEW 84:07

This walk through sheep feeder is assembled in portable units 8 ft long. The sections may be placed end to end to provide a continuous hay and grain feeder. The feeder may be placed to divide the barn into pens, either lengthwise or across the bedded area. Two pieces of 2 x 6 inch planking are fastened to the floor of the feeder; this provides a walkway for the operator for feeding and observation of the flock.

Each 8 ft section provides feeding space for 6 to 8 ewes at a time one each side.

Some advantages of this feeder are as follow:

1. There is space underneath for prying the unit out of the bedded pack if necessary.
2. The feeder lengths are short and versatile for arranging a combined pen and feeding area within the barn.
3. The feeder acts as a walkway, and eliminates walking among the sheep for feeding.
4. The feeder is easy to clean.

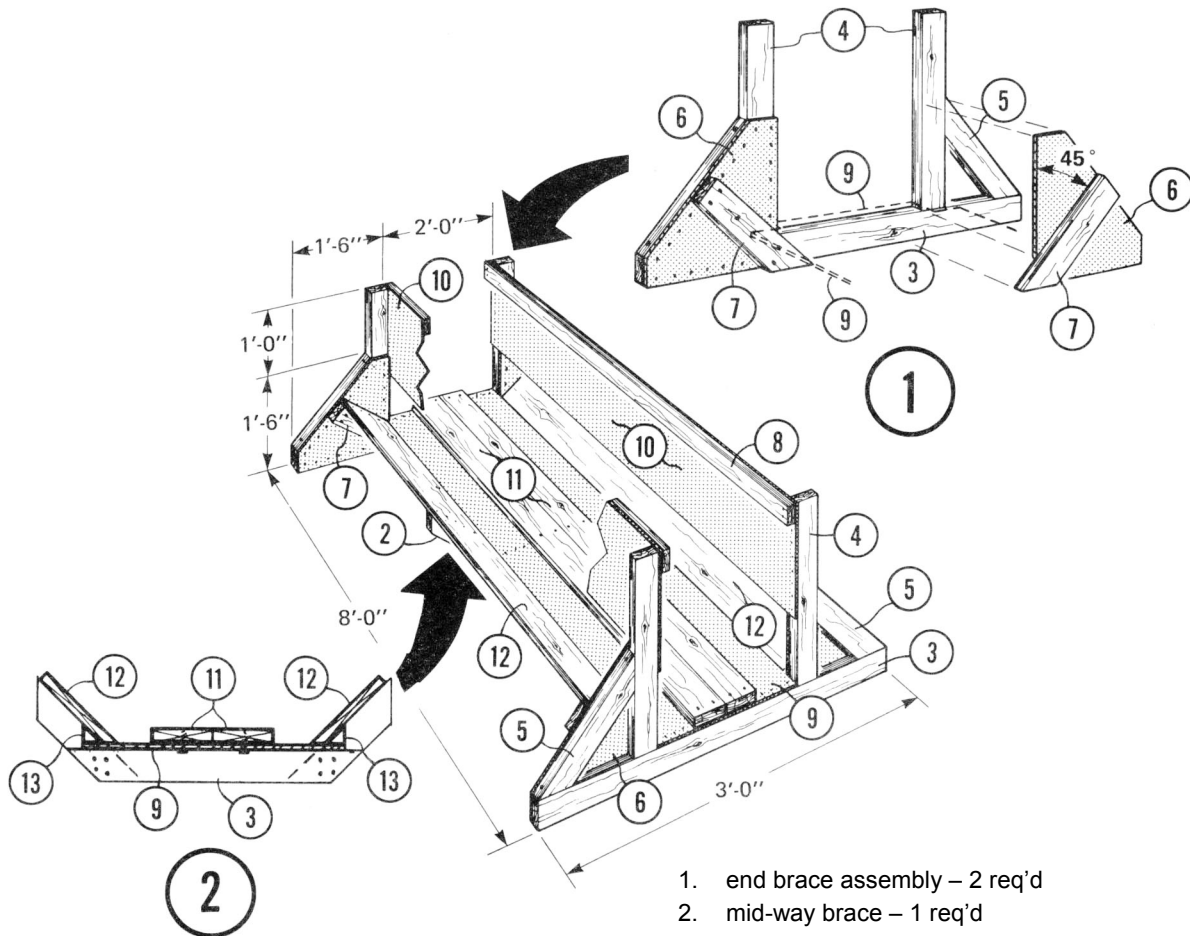

1. end brace assembly – 2 req'd
2. mid-way brace – 1 req'd
3. sill, 2" x 4"
4. post, 2" x 4" x 2'-6"
5. brace, 2" x 4" x 1'-8"
6. gusset from 3/8" plywood
7. cleat, 2" x 4" x 1'-3"
8. rail, 2" x 4" x 8'-0"
9. floor, 3/8" x 2'-0" x 8'-0" plywood, notched around ①
10. side, 3/8" x 12" x 8'-0" plywood
11. walk plank, 2 - 2" x 6" x 8'-0"
12. trough, 1" x 10" x 7'-8" plank, nail to ⑦ & ⑬
13. blocking, 2" x 2" x 7'-8" cut diagonally, nailed to ⑨