

SHEARING FACILITIES

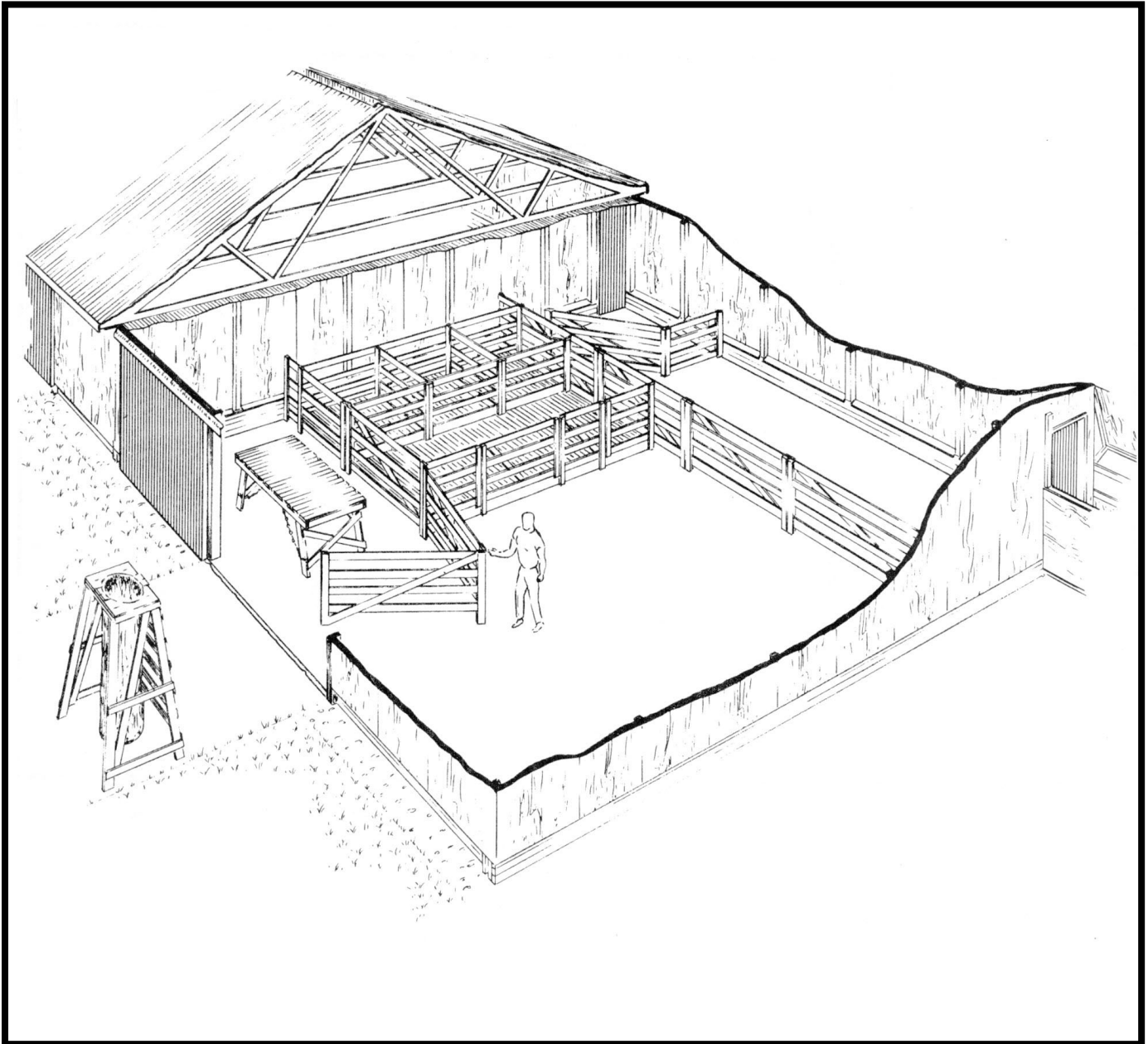

DEVELOPED BY CANADA PLAN SERVICE

353-51

SHEARING FACILITIES

CPS

PLAN 4511

NEW 8:76

This leaflet shows a floor plan arrangement for converting the claiming section of the lambing unit Plan 351-24 (CPS 4311) into a temporary shearing area. All fence panels and the slotted floor sections are portable so that they can be stored easily after shearing is finished.

Slotted floor panels in the catch-pens and shearing-pen help to keep the wool from getting soiled by manure during the shearing.

The arrangement is laid out for three shearers to work at the same time. Sheep in the holding-pen are worked into the three small catch-pens. Here the shearer catches each sheep, and after shearing releases it into the holding-pen on the other side. The sheared sheep can be held in the building or let out, depending on the weather.

The wool is sorted on a table - Leaflet 353-53 (CPS M4552) located nearby. After sorting, the wool is packed in a bag hung from a packing frame - Leaflet 353-54 (CPS 4553) outside the door.

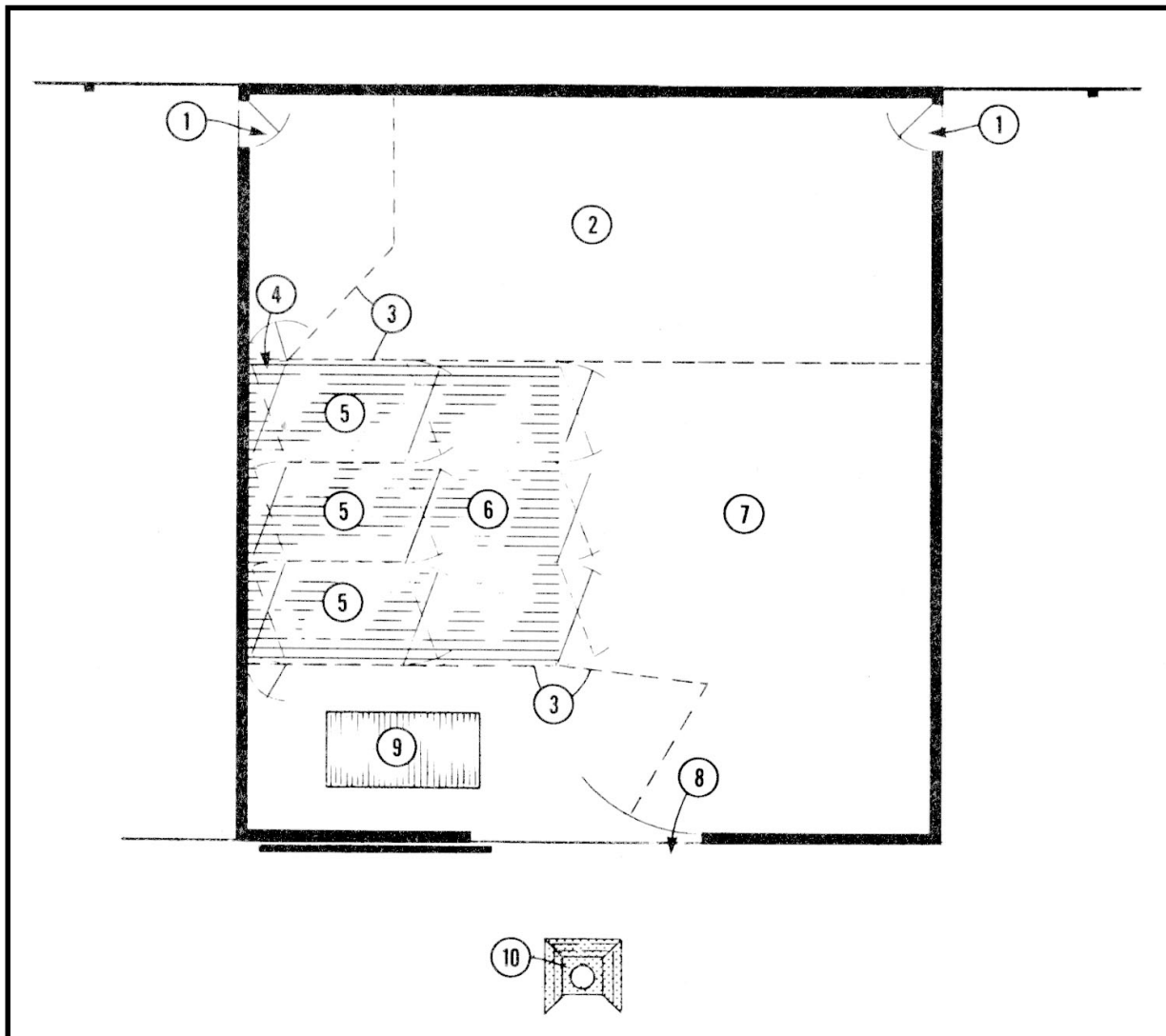

1. sheep enter from adjacent pens
2. holding pen 36' x 14'
3. portable fence sections
4. sheep enter 2' sorting alley
5. catch pens each 6' x 5'-8" on shearing floor panels, see leaflet 4552
6. shearing area 8' x 16' on shearing floor panels, see Leaflet 353-53 (CPS 4552)
7. shorn sheep holding pen, optional
8. sheep exit
9. fleece sorting table, see Leaflet 353-53 (CPS 4552)
10. fleece packing frame, see Leaflet 353-54 (CPS 4553)