



Province of British Columbia  
Ministry of Forests  
FOREST SERVICE

EXHIBIT A

Date JANUARY 9, 1981

Ref. Map 92 C/9

Base T.F.L. 22

Scale 1 : 15,840

RECREATION PROJECT 900-1-268

Map Of

Outlined Area hectares ±

Forest Region VANCOUVER

U.T.M. Grid	Zone	East	North	Reg.	Compt.	L
	10	400300	5382000	06	003	D

District 6

Land District RENFREW

MANAGEMENT UNIT		TIMBER SUPPLY AREA		Pulpwood Agreement	Cascades	
Type	0	Number	28			East
Number	64	Block		West		C
Block		Sub-B				

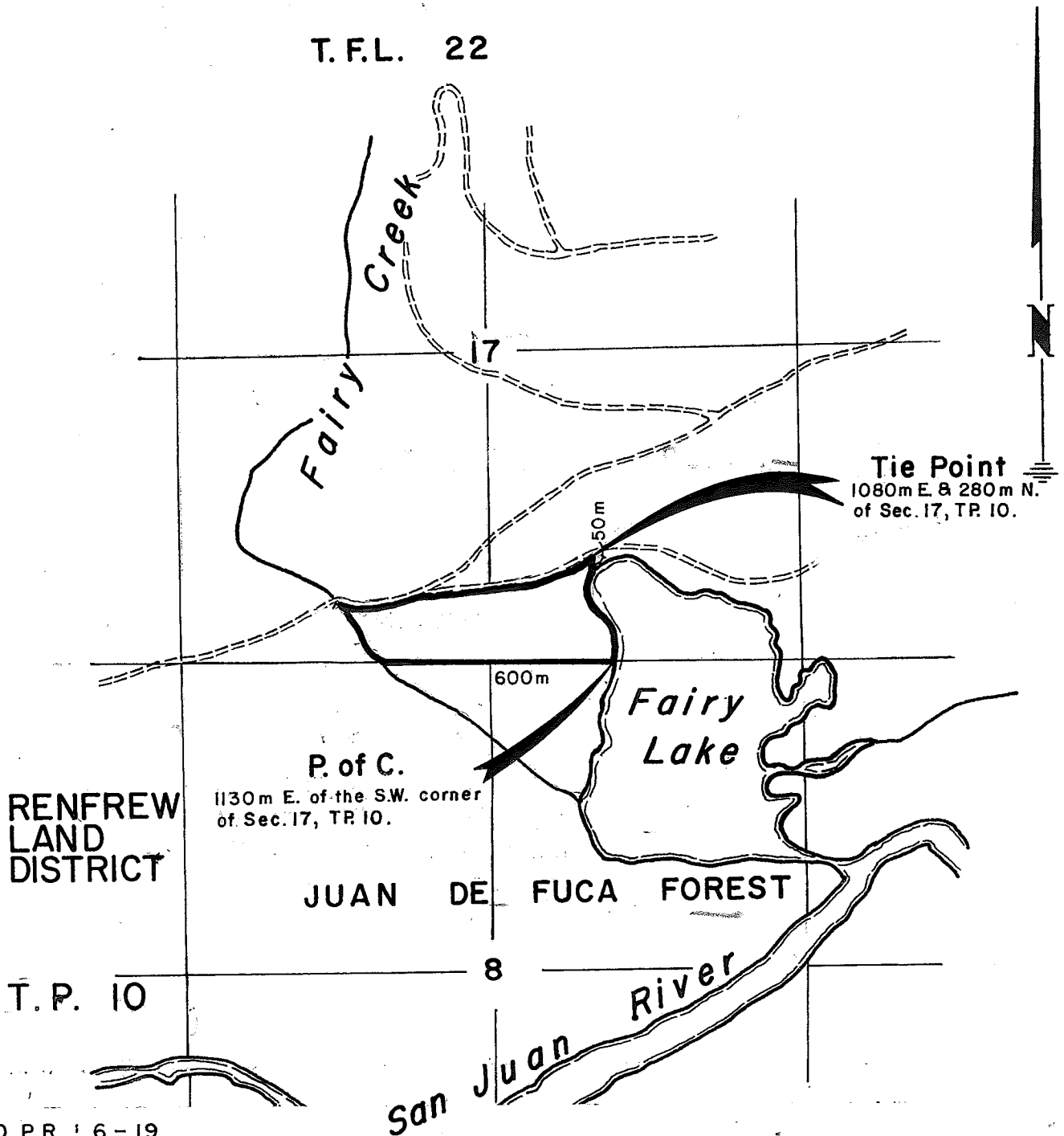

Commencing at a point on the north western shoreline of Fairy Lake, said point being 1130 metres east of the southwest corner of Section 17, Township 10, Renfrew land District, thence west 600 metres to Fairy Creek, thence north westerly following Fairy Creek to a road, thence following the southern boundary of the road for 600 metres more or less to a point 1080 metres East & 280 metres north of the southwest corner of Section 17, Township 10, thence south 50 metres to the northwestern shoreline of Fairy Lake, thence in a general southerly direction to the point of commencement.