

900-282



Province of British Columbia
Ministry of Forests
FOREST SERVICE

EXHIBIT A

Date February 3, 1980

Ref. Map 92 B-12

Base 92 B-12g forest cover

Scale 1 : 20,000

KOKSILAH RIVER

M.F.R.S. 21-2

Map Of

Outlined Area hectares ± Forest Region VANCOUVER

U.T.M. Zone East North Reg. Compt. L District 21
Grid 10449100539080007033C Land District VICTORIA

MANAGEMENT UNIT		TIMBER SUPPLY AREA		Pulpwood Agreement	Cascades	
Type	E	Number	28			East
Number		Block		West		C
Block		Sub-B				

SAVE AND EXCEPTING C.N.R. R/W.

No encroachment to be made upon C.N.R. R/W.

VANCOUVER

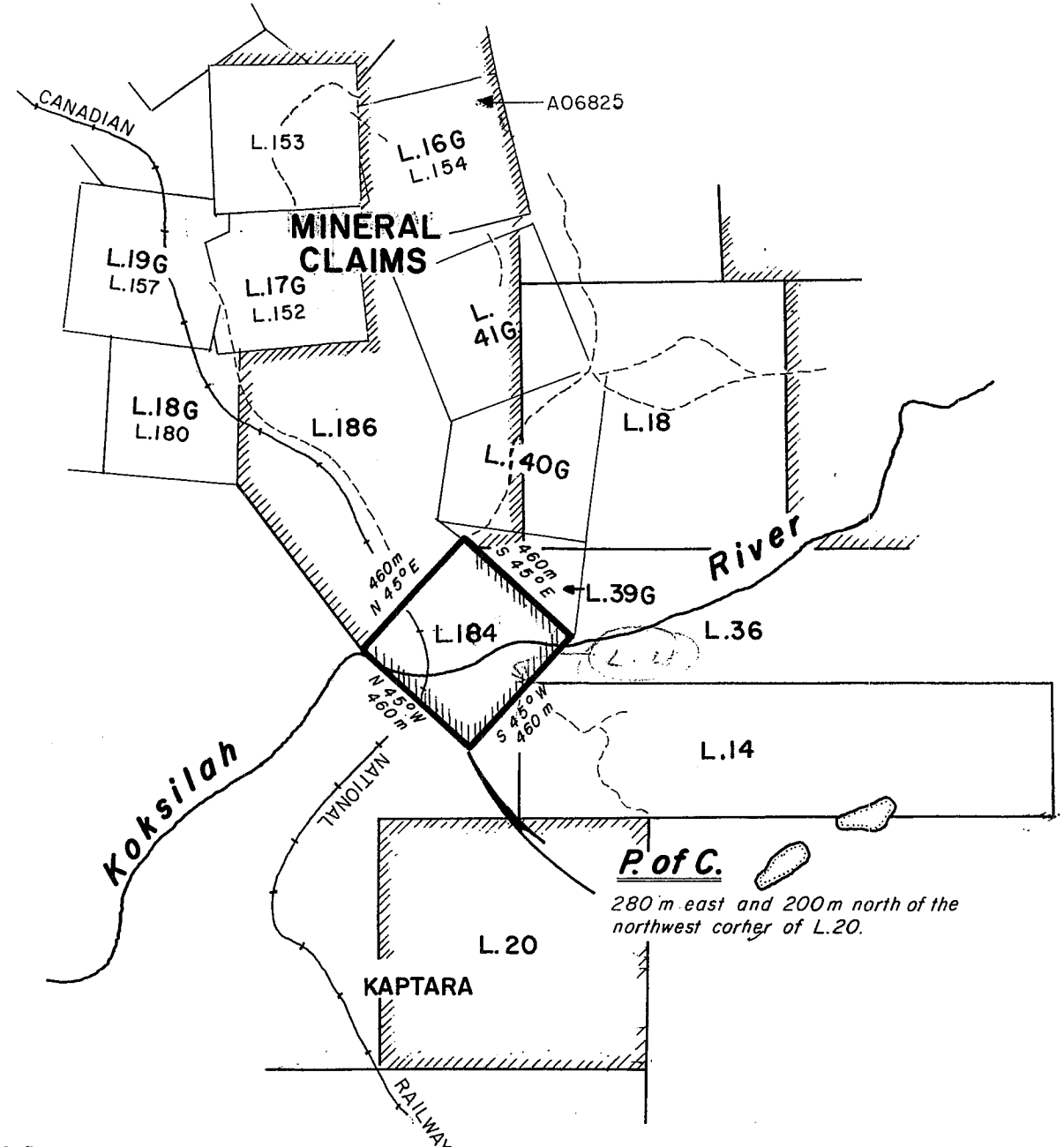

900-1-282

LEGAL DESCRIPTION

ISLAND

Commencing at a point 280 metres east and 200 metres north of the northwest corner of Lot 20, Helmeken Land District; thence north 45 degrees west 460 metres; thence north 45 degrees east 460 metres; thence south 45 degrees west 200 metres to the north boundary of Lot 14; thence west 30 metres along the northern boundary of Lot 14 to the northwest corner of Lot 14; thence south 30 metres; thence south 45 degrees west 220 metres to the point of commencement. Save and excepting Canadian National Railway right of way.

L. 20