



Province of British Columbia
Ministry of Forests
FOREST SERVICE
POINT

EXHIBIT A

Date January 8, 1980
Ref. Map 92 C/15 *92C/96*
Base T.F.L. 21
Scale 1 : 20,000

Map Of **M.F.R.S. 88-21 Sarita Lake Picnic Site 900-274**

Outlined Area _____ hectares ± Forest Region Vancouver
U.T.M. Zone East North Reg. Compt. L District 25
Grid 1036230005418600006015C Land District Barclay

MANAGEMENT UNIT		TIMBER SUPPLY AREA		Pulpwood Agreement	Cascades	
Type	Number	Block	Sub-B		East	West
Number						
Block						

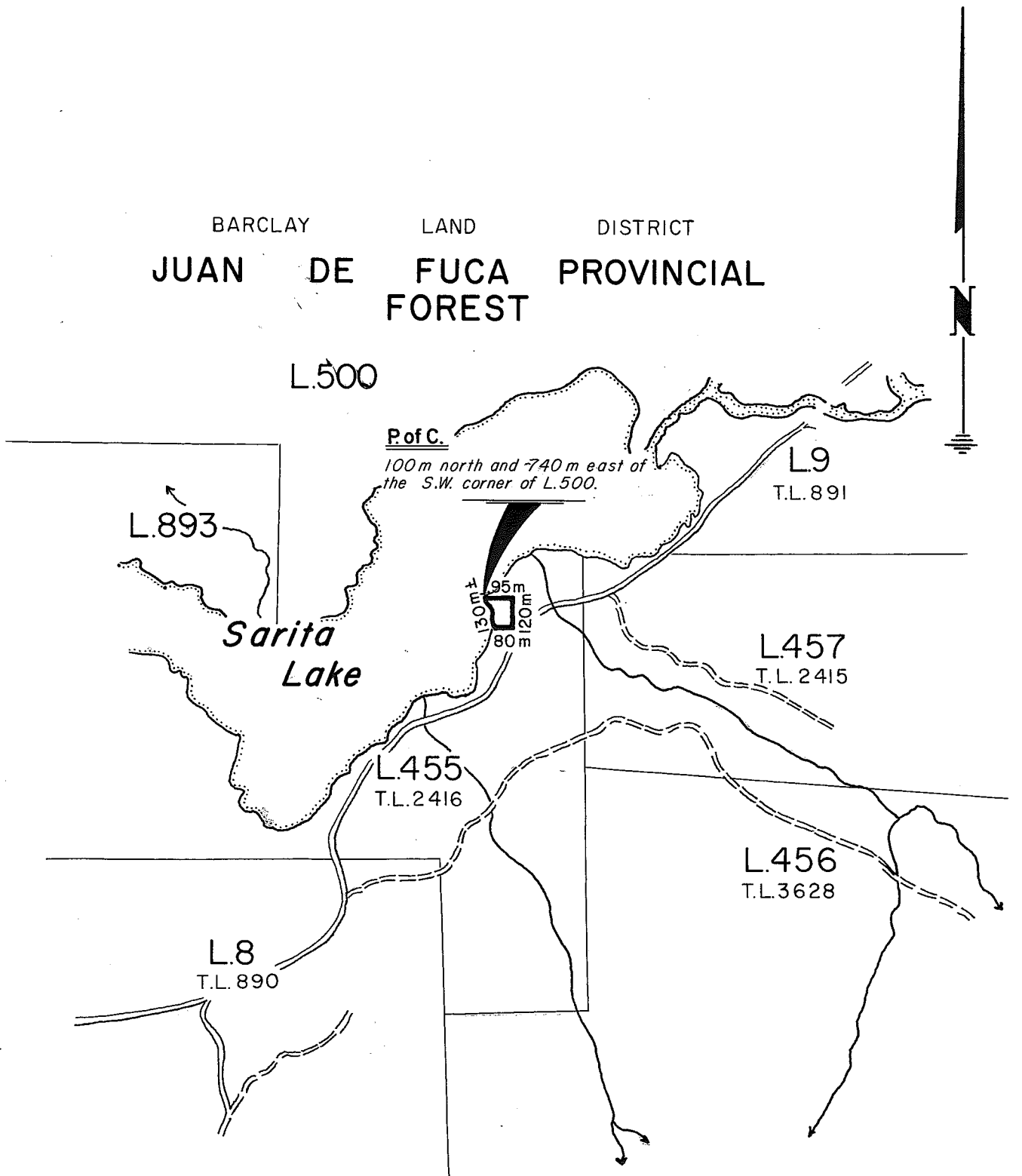

Commencing at a point on the shoreline of Sarita Lake, said point being 100 metres north and 740 metres east of the southwest corner of Lot 500, Barclay Land District; thence east 95 metres; thence south 120 metres; thence west 80 metres more or less to the shoreline of Sarita Lake; thence in a northerly direction along the shoreline of Sarita Lake to the point of commencement.