

Biggar

| Population | | |
|---|------------|-----------------------|
| Total Population (100 % data) | 16,500 | |
| Total Population (non-institutional) ⁽¹⁾ | 16,305 | |
| Home Language | | |
| | Population | % of Total Population |
| Single Responses | 15,455 | 93.7 |
| English | 15,295 | 92.7 |
| French | 0 | 0.0 |
| Non-official languages | 160 | 1.0 |
| Multiple Responses | 845 | 5.1 |
| Knowledge of Official Languages | | |
| English only | 15,810 | 95.8 |
| French only | 0 | 0.0 |
| Both English and French | 465 | 2.8 |
| Neither English nor French | 25 | 0.2 |
| Knowledge of Non-official Languages ⁽²⁾ | | |
| German | 1,250 | 7.6 |
| Ukrainian | 375 | 2.3 |
| Cree | 75 | 0.5 |
| Other | 325 | 2.0 |
| Ethnic Origin | | |
| Single origins | 7,470 | 45.3 |
| Canadian | 2,140 | 13.0 |
| British origins ⁽³⁾ | 1,380 | 8.4 |
| German | 2,125 | 12.9 |
| Ukrainian | 615 | 3.7 |
| Chinese | 0 | 0.0 |
| Aboriginal origins ⁽⁴⁾ | 245 | 1.5 |
| French origins ⁽⁵⁾ | 140 | 0.8 |
| Other single origins | 825 | 5.0 |
| Multiple origins ⁽⁶⁾ | 8,830 | 53.5 |
| Citizenship | | |
| Canadian citizenship ⁽⁷⁾ | 16,255 | 98.5 |
| Citizenship other than Canadian | 45 | 0.3 |
| Aboriginal Population | | |
| Total Aboriginal population | 615 | 3.7 |
| Single response | 605 | 3.7 |
| North American Indian | 245 | 1.5 |
| Metis single response | 350 | 2.1 |
| Inuit single response | 10 | 0.1 |
| Multiple Aboriginal response | 10 | 0.1 |
| Aboriginal responses not included elsewhere | 0 | 0.0 |
| Non-Aboriginal population | 15,690 | 95.1 |

(1) With the exception of "Total Population (100% data)", all characteristics exclude institutional residents and are based on weighted sample data (20%)

(2) Indicates the number of respondents reporting knowledge of these non-official languages.

(3) Includes the single responses of English, Irish, Scottish, Welsh and Other British, n.i.e.

(4) Includes the singles responses of Inuit, Metis and North American Indian

(5) Includes the single responses of French, Acadian and Quebecois

(6) A multiple response occurs when a respondent provides two or more ethnic origins.

(7) Includes Canadian citizenship by birth and Canadian citizenship by naturalization

Biggar

| Place of Birth | | |
|---|------------|---------------------------|
| | Population | % of Total Population |
| Non-immigrant population ⁽⁸⁾ | 15,860 | 96.1 |
| Born in Saskatchewan | 13,835 | 83.8 |
| Immigrant population | 420 | 2.5 |
| United States of America | 30 | 0.2 |
| Central and South America | 0 | 0.0 |
| Caribbean and Bermuda | 0 | 0.0 |
| United Kingdom | 115 | 0.7 |
| Other Europe ⁽⁹⁾ | 135 | 0.8 |
| Africa | 0 | 0.0 |
| India | 0 | 0.0 |
| Other Asia ⁽¹⁰⁾ | 20 | 0.1 |
| Oceania & Other ⁽¹¹⁾ | 115 | 0.7 |
| Non-permanent residents ⁽¹²⁾ | 20 | 0.1 |
| Total Immigrant Population by Period of Immigration | | |
| | Population | % of Total Population |
| Total immigrant population | 420 | 2.5 |
| | Population | % of Immigrant Population |
| By period of immigration | | |
| Before 1961 | 225 | 53.6 |
| 1961-1970 | 40 | 9.5 |
| 1971-1980 | 45 | 10.7 |
| 1981-1990 | 30 | 7.1 |
| 1991-1995 | 40 | 9.5 |
| 1996-2001 ⁽¹³⁾ | 40 | 9.5 |
| Age at Immigration | | |
| | Population | % of Total Population |
| 0-4 years | 115 | 27.4 |
| 5-9 years | 140 | 33.3 |
| 20 years and over | 170 | 40.5 |
| Mobility Status | | |
| | Population | % of Population |
| Total population 1 year and over ⁽¹⁴⁾ | 16,160 | |
| Non-movers | 14,675 | 90.8 |
| Movers | 1,480 | 9.2 |
| Non-migrants | 480 | 3.0 |
| Migrants | 1,000 | 6.2 |
| Internal migrants | 980 | 6.1 |
| Intraprovincial migrants | 745 | 4.6 |
| Interprovincial migrants | 235 | 1.5 |
| External migrants | 20 | 0.1 |
| | Population | % of Population |
| Total population 5 years and over ⁽¹⁴⁾ | 15,380 | |
| Non-movers | 10,875 | 70.7 |
| Movers | 4,500 | 29.3 |
| Non-migrants | 1,375 | 8.9 |
| Migrants | 3,130 | 20.4 |
| Internal migrants | 3,095 | 20.1 |
| Intraprovincial migrants | 2,460 | 16.0 |
| Interprovincial migrants | 635 | 4.1 |
| External migrants | 35 | 0.2 |

(8) Includes persons born outside the province of residence as well as persons born outside Canada who have Canadian citizenship by birth

(9) Excludes the United Kingdom

(10) "Other Asia" includes the Middle East and excludes India

(11) "Other" includes persons born in Canada who do not have Canadian citizenship by birth, but who do have a valid year for immigration

(12) Refers to persons who hold a student authorization, employment authorization or Minister's permit, or who are refugee claimants

(13) Includes the first five months of 2001.

(14) Population residing in Canada, excluding all persons in collective households and Canadians (military and government personnel) in households outside Canada

Biggar

| School Attendance | | |
|---|------------|--------------------------------|
| | Population | % of Population 15-24 Years |
| Total population 15-24 years | 2,090 | |
| Not attending school | 915 | 43.8 |
| Attending school full-time | 1,090 | 52.2 |
| Attending school part-time | 85 | 4.1 |
| Highest Level of Schooling | | |
| | Population | % of Population 20+ Years |
| Total Population 20 years and over | 11,235 | |
| Less than grade 9 ⁽¹⁵⁾ | 1,345 | 12.0 |
| Grades 9-13 | 4,340 | 38.6 |
| Without secondary certificate | 3,200 | 28.5 |
| With secondary certificate | 1,140 | 10.1 |
| Trades certificate or diploma | 1,775 | 15.8 |
| College ⁽¹⁶⁾ | 2,060 | 18.3 |
| Without certificate | 530 | 4.7 |
| With certificate ^{(16),(17)} | 1,530 | 13.6 |
| University - Without degree | 775 | 6.9 |
| University - Without certificate | 530 | 4.7 |
| University - With certificate ⁽¹⁷⁾ | 245 | 2.2 |
| University - With degree | 940 | 8.4 |
| Labour Force Activity | | |
| Both Sexes - 15 years and over | 12,645 | |
| In labour force | 9,100 | |
| Employed | 8,770 | |
| Unemployed | 325 | |
| Not in the labour force | 3,545 | |
| Unemployment rate % | 3.6 | |
| Employment to population ratio | 69.4 | |
| Participation Rate % | 72.0 | |
| Males - 15 years and over | 6,405 | |
| In labour force | 5,070 | |
| Employed | 4,920 | |
| Unemployed | 155 | |
| Not in the labour force | 1,340 | |
| Unemployment rate % | 3.1 | |
| Employment to population ratio | 76.8 | |
| Participation Rate % | 79.2 | |
| Females - 15 years and over | 6,235 | |
| In labour force | 4,030 | |
| Employed | 3,855 | |
| Unemployed | 175 | |
| Not in the labour force | 2,205 | |
| Unemployment rate % | 4.3 | |
| Employment to population ratio | 61.8 | |
| Participation Rate % | 64.6 | |
| With no children at home ⁽¹⁸⁾ | 52.7 | |
| With children at home ⁽¹⁸⁾ | 81.4 | |
| Under 6 years only ⁽¹⁸⁾ | 75.3 | |
| Some less than 6 years ^{(18),(19)} | 83.4 | |

(15) Includes "Never attended school or attended kindergarten only."

(16) Refers to courses completed at post-secondary non-university institutions which normally require a secondary school graduation certificate or equivalent for entrance, as well as to other courses in related or like institutions (such as private trade schools or adult vocational centres) which may not require secondary school graduation for entrance

(17) Includes "Other non-university certificate or diploma" and "Trades certificate or diploma"

(18) This participation rate is calculated for females 15 years and over in private households only

(19) Refers to females 15 years and over in private households with children under 6 years of age as well as children 6 years and over

Biggar

| Labour Force by Industry ⁽²¹⁾ | | |
|---|------------|---------------------|
| Total labour force 15 years and over | 9,105 | |
| Not applicable ⁽²⁰⁾ | 80 | |
| | | % of Experienced |
| | Population | Labour Force |
| All industries ^{(21),(22)} | 9,025 | 99.1 |
| Agriculture, forestry, fishing and hunting | 2,765 | 30.4 |
| Mining and oil and gas extraction | 255 | 2.8 |
| Utilities | 65 | 0.7 |
| Construction | 500 | 5.5 |
| Manufacturing | 500 | 5.5 |
| Wholesale trade | 285 | 3.1 |
| Retail trade | 760 | 8.3 |
| Transportation and warehousing | 610 | 6.7 |
| Information and cultural industries | 170 | 1.9 |
| Finance and insurance | 210 | 2.3 |
| Real estate and rental and leasing | 70 | 0.8 |
| Professional, scientific and technical services | 115 | 1.3 |
| Management of companies and enterprises | 0 | 0.0 |
| Admin and support, waste management and remediation services | 185 | 2.0 |
| Educational services | 585 | 6.4 |
| Healthcare and social assistance | 850 | 9.3 |
| Arts, entertainment and recreation | 100 | 1.1 |
| Accommodation and food services | 340 | 3.7 |
| Other services (except public administration) | 410 | 4.5 |
| Public administration | 235 | 2.6 |
| Male Labour Force by Major Occupation Groups ⁽²¹⁾ | | |
| Male labour force 15 years and over | 5,065 | |
| Not applicable ⁽²⁰⁾ | 20 | |
| | | % of Experienced |
| | Population | Male Labour Force |
| Males - All occupations (Major Groups) ^{(21),(22)} | 5,050 | 99.7 |
| Management occupations | 365 | 7.2 |
| Business, finance and administration occupations | 105 | 2.1 |
| Natural and applied sciences and related occupations | 120 | 2.4 |
| Health occupations | 30 | 0.6 |
| Occ in social science, education, government service and religion | 170 | 3.4 |
| Occupations in art, culture, recreation and sport | 40 | 0.8 |
| Sales and service occupations | 455 | 9.0 |
| Trades, transport and equipment operators and related occupations | 1,505 | 29.7 |
| Occupations unique to primary industry | 2,030 | 40.1 |
| Occupations unique to processing, manufacturing and utilities | 230 | 4.5 |
| Female Labour Force by Major Occupation Groups ⁽²¹⁾ | | |
| Female labour force 15 years and over | 4,035 | |
| Not applicable ⁽²⁰⁾ | 60 | |
| | | % of Experienced |
| | Population | Female Labour Force |
| Females - All occupations (Major Groups) ^{(21),(22)} | 3,975 | 98.5 |
| Management occupations | 195 | 4.8 |
| Business, finance and administration occupations | 700 | 17.3 |
| Natural and applied sciences and related occupations | 55 | 1.4 |
| Health occupations | 450 | 11.2 |
| Occ in social science, education, government service and religion | 310 | 7.7 |
| Occupations in art, culture, recreation and sport | 125 | 3.1 |
| Sales and service occupations | 1,185 | 29.4 |
| Trades, transport and equipment operators and related occupations | 170 | 4.2 |
| Occupations unique to primary industry | 740 | 18.3 |
| Occupations unique to processing, manufacturing and utilities | 50 | 1.2 |

(20) The "Not applicable" category refers to unemployed persons 15 years and over who have never worked or who had worked only prior to January 1, 2000. For these persons, the industry, occupation and class of worker questions did not apply.

(21) Occupation major groups and industry division totals include computer assignment of the "Not Stated" categories. These assignments are based on selected socio-economic characteristics.

(22) This category is also referred to as the "Experienced labour force"

Biggar

| Labour Force by Sex and Class of Worker | | |
|---|------------|------------------|
| Total labour force 15 years and over | 9,105 | |
| Not applicable ⁽²⁰⁾ | 80 | |
| | | % of Experienced |
| | Population | Labour Force |
| Males - All classes of worker ⁽²²⁾ | 5,050 | 55.5 |
| Paid workers | 3,525 | 38.7 |
| Employees | 3,070 | 33.7 |
| Self-employed (incorporated) | 455 | 5.0 |
| Self-employed (unincorporated) | 1,445 | 15.9 |
| Unpaid family workers | 75 | 0.8 |
| Females - All classes of worker ⁽²²⁾ | 3,970 | 43.6 |
| Paid workers | 3,190 | 35.0 |
| Employees | 3,005 | 33.0 |
| Self-employed (incorporated) | 195 | 2.1 |
| Self-employed (unincorporated) | 620 | 6.8 |
| Unpaid family workers | 160 | 1.8 |
| Labour Force by Sex and Place of Work | | |
| Total employed labour force 15 years and over | 8,775 | |
| | | % of Employed |
| | Population | Labour Force |
| Males in employed labour force | 4,915 | 56.0 |
| Usual place of work | 2,425 | 27.6 |
| In census subdivision of residence | 780 | 8.9 |
| In different census subdivision | 1,645 | 18.7 |
| In same census division | 860 | 9.8 |
| At home | 1,815 | 20.7 |
| Outside Canada | 20 | 0.2 |
| No usual place of work | 660 | 7.5 |
| Females in employed labour force | 3,860 | 44.0 |
| Usual place of work | 2,590 | 29.5 |
| In census subdivision of residence | 915 | 10.4 |
| In different census subdivision | 1,675 | 19.1 |
| In same census division | 855 | 9.7 |
| At home | 1,130 | 12.9 |
| Outside Canada | 0 | 0.0 |
| No usual place of work | 140 | 1.6 |

(20) The "Not applicable" category refers to unemployed persons 15 years and over who have never worked or who had worked only prior to January 1, 2000. For these persons, the industry, occupation and class of worker questions did not apply

(22) This category is also referred to as the "Experienced labour force"

Biggar

| Dwelling Characteristics | | |
|--|---------------------|---------------------------------------|
| Total number of occupied private dwellings | 6,105 | |
| Average number of rooms per dwelling | 7.0 | |
| Average number of bedrooms per dwelling | 3.0 | |
| Average value of dwelling \$ ⁽²³⁾ | 77,367 | |
| Dwelling by Need of Repair | | |
| | Number of Dwellings | % of Total Occupied Private Dwellings |
| Regular maintenance only | 3,015 | 49.4 |
| Minor repairs | 2,380 | 39.0 |
| Major repairs | 715 | 11.7 |
| Dwellings by Period of Construction | | |
| | Number of Dwellings | % of Total Occupied Private Dwellings |
| Before 1946 | 1,430 | 23.4 |
| 1946-1960 | 875 | 14.3 |
| 1961-1970 | 820 | 13.4 |
| 1971-1980 | 1,740 | 28.5 |
| 1981-1985 | 590 | 9.7 |
| 1986-1990 | 225 | 3.7 |
| 1991-1995 | 100 | 1.6 |
| 1996-2001 ⁽²⁴⁾ | 330 | 5.4 |
| Household Characteristics | | |
| Total number of private households | 6,105 | |
| Tenant one-family households | 900 | |
| Without additional persons ⁽²⁵⁾ | 425 | |
| Average gross rent \$ ⁽²⁶⁾ | 526 | |
| Gross rent >=30% of household income ⁽²⁵⁾ | 80 | |
| Owner one-family households | 5,205 | |
| Without additional persons ⁽²⁷⁾ | 2,755 | |
| Average major payments for owners \$ ⁽²⁸⁾ | 607 | |
| Owner's major payments >=30% of household income ⁽²⁷⁾ | 225 | |

(23) Applies to owner-occupied non-farm, non-reserve dwellings only

(24) Includes the first five months only of 2001.

(25) Includes households in tenant-occupied non-farm, non-reserve dwellings with household income greater than \$0 in 2000

(26) Applies to tenant-occupied non-farm, non-reserve dwellings only

(27) Includes households in owner-occupied non-farm, non-reserve dwellings with household income greater than \$0 in 2000

(28) Applies to owner-occupied non-farm, non-reserve dwellings only

Biggar

| Employment Income (2000) by Sex and Work Activity | | |
|---|--------|-----------------------------|
| Males | | |
| Worked full year, full time ⁽²⁹⁾ | 3,105 | |
| Average employment income \$ | 33,675 | |
| Standard error of average employment income \$ | 941 | |
| Worked part year of part time ⁽³⁰⁾ | 1,790 | |
| Average employment income \$ | 17,351 | |
| Standard error of average employment income \$ | 1,045 | |
| Females | | |
| Worked full year, full time ⁽²⁹⁾ | 1,710 | |
| Average employment income \$ | 24,807 | |
| Standard error of average employment income \$ | 842 | |
| Worked part year of part time ⁽³⁰⁾ | 2,175 | |
| Average employment income \$ | 11,666 | |
| Standard error of average employment income \$ | 505 | |
| Compositions of Total Income ⁽²⁹⁾ | | |
| Total % | 100.0 | |
| Employment income % | 72.8 | |
| Government transfer payments % | 15.6 | |
| Other income % | 11.5 | |
| Total Income (2000) by Sex | | |
| Total Population 15 years and over with income | 11,790 | % of Population with Income |
| Males 15 years and over with income | 6,040 | 51.2 |
| Under \$1,000 ⁽³¹⁾ | 220 | 1.9 |
| \$ 1,000 - \$ 2,999 | 265 | 2.2 |
| \$ 3,000 - \$ 4,999 | 200 | 1.7 |
| \$ 5,000 - \$ 6,999 | 295 | 2.5 |
| \$ 7,000 - \$ 9,999 | 310 | 2.6 |
| \$10,000 - \$11,999 | 240 | 2.0 |
| \$12,000 - \$14,999 | 345 | 2.9 |
| \$15,000 - \$19,999 | 645 | 5.5 |
| \$20,000 - \$24,999 | 485 | 4.1 |
| \$25,000 - \$29,999 | 450 | 3.8 |
| \$30,000 - \$34,999 | 560 | 4.7 |
| \$35,000 - \$39,999 | 345 | 2.9 |
| \$40,000 - \$44,999 | 330 | 2.8 |
| \$45,000 - \$49,999 | 290 | 2.5 |
| \$50,000 - \$59,999 | 485 | 4.1 |
| \$60,000 and over | 590 | 5.0 |
| Average income \$ ⁽³²⁾ | 29,455 | |
| Median income \$ ⁽³²⁾ | 25,057 | |
| Standard error of average income \$ - | 637 | |
| Females 15 years and over with income | 5,750 | 48.8 |
| Under \$1,000 ⁽³¹⁾ | 195 | 1.7 |
| \$ 1,000 - \$ 2,999 | 320 | 2.7 |
| \$ 3,000 - \$ 4,999 | 270 | 2.3 |
| \$ 5,000 - \$ 6,999 | 425 | 3.6 |
| \$ 7,000 - \$ 9,999 | 520 | 4.4 |
| \$10,000 - \$11,999 | 365 | 3.1 |
| \$12,000 - \$14,999 | 705 | 6.0 |
| \$15,000 - \$19,999 | 885 | 7.5 |
| \$20,000 - \$24,999 | 570 | 4.8 |
| \$25,000 - \$29,999 | 465 | 3.9 |
| \$30,000 - \$34,999 | 345 | 2.9 |
| \$35,000 - \$39,999 | 205 | 1.7 |
| \$40,000 - \$44,999 | 120 | 1.0 |
| \$45,000 - \$49,999 | 100 | 0.8 |
| \$50,000 - \$59,999 | 170 | 1.4 |
| \$60,000 and over | 85 | 0.7 |
| Average income \$ ⁽³²⁾ | 18,627 | |
| Median income \$ ⁽³²⁾ | 15,254 | |
| Standard error of average income \$ - | 401 | |

(29) Worked 49-52 weeks in 2000, mostly full-time

(30) Worked 49-52 weeks in 2000, mostly part-time, or worked less than 49 weeks

(31) Includes loss.

(32) For persons with income.

Biggar

| Family Income (2000) | | |
|--|--------|----------------------------------|
| Total number of census families | 4,485 | |
| | | % of Total Census Families |
| Census Family income | | |
| Under \$10,000 | 150 | 3.3 |
| \$10,000 - \$19,999 | 245 | 5.5 |
| \$20,000 - \$29,999 | 605 | 13.5 |
| \$30,000 - \$39,999 | 655 | 14.6 |
| \$40,000 - \$49,999 | 630 | 14.0 |
| \$50,000 - \$59,999 | 635 | 14.2 |
| \$60,000 - \$69,999 | 485 | 10.8 |
| \$70,000 - \$79,999 | 405 | 9.0 |
| \$80,000 - \$89,999 | 210 | 4.7 |
| \$90,000 - \$99,999 | 110 | 2.5 |
| \$100,000 and over | 360 | 8.0 |
| Average family income \$ | 54,150 | |
| Median family income \$ | 49,690 | |
| Standard error of average family income \$ | 999 | |
| Incidence of Low Income (2000)⁽³³⁾ | | |
| Total number of economic families ⁽³³⁾ | 4,505 | |
| Low income economic families ⁽³³⁾ | 410 | |
| Incidence of low income % ^{(33),(34)} | 9.1 | |
| All unattached individuals ⁽³³⁾ | 1,740 | |
| Low income unattached individuals ⁽³³⁾ | 500 | |
| Incidence of low income % ^{(33),(34)} | 28.7 | |
| Total population in private households ⁽³³⁾ | 15,700 | |
| Persons in low income family units ⁽³³⁾ | 1,760 | |
| Incidence of low income % ^{(33),(34)} | 11.2 | |
| Household Income (2000) | | |
| Total number of private households | 6,105 | |
| | | % of Private Households |
| Household income | | |
| Under \$10,000 | 345 | 5.7 |
| \$10,000 - \$19,999 | 965 | 15.8 |
| \$20,000 - \$29,999 | 850 | 13.9 |
| \$30,000 - \$39,999 | 770 | 12.6 |
| \$40,000 - \$49,999 | 775 | 12.7 |
| \$50,000 - \$59,999 | 730 | 12.0 |
| \$60,000 - \$69,999 | 525 | 8.6 |
| \$70,000 - \$79,999 | 410 | 6.7 |
| \$80,000 - \$89,999 | 225 | 3.7 |
| \$90,000 - \$99,999 | 110 | 1.8 |
| \$100,000 and over | 390 | 6.4 |
| Average family income \$ | 46,638 | |
| Median family income \$ | 41,480 | |
| Standard error of average family income \$ | 864 | |

(33) See appendix for universe covered and for definitions of concepts and terms

(34) Calculations based on unrounded data.



Constituency of Biggar

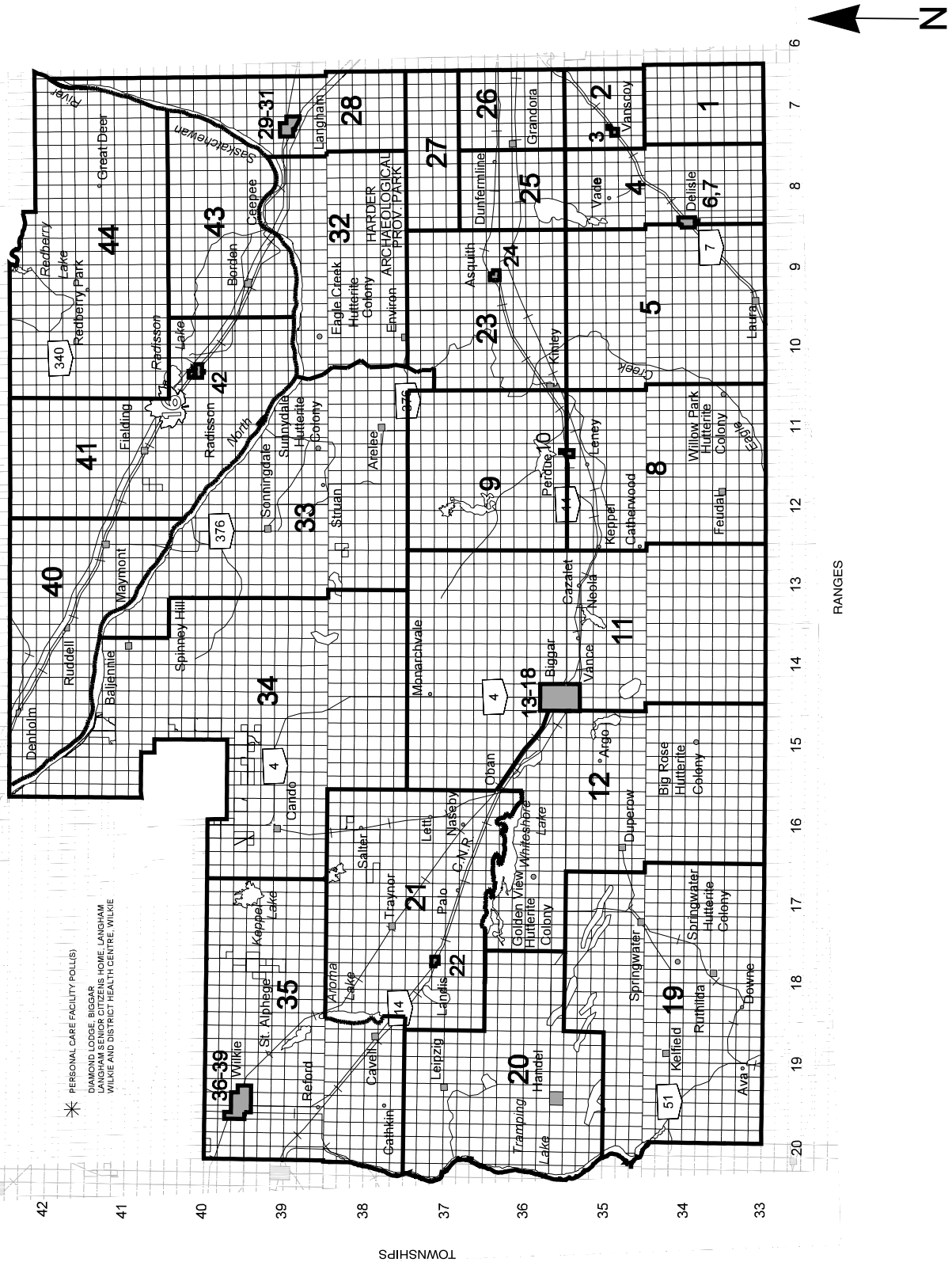

* PERSONAL CARE FACILITY (POLLS)
 DIAMOND LODGE, BIGGAR
 LANGHAM SENIOR CITIZENS HOME, LANGHAM
 WILKE AND DISTRICT HEALTH CENTRE, WILKE

SdIHSMOJ

NOTE: FIRST EDITION

CONSTITUENCY BOUNDARIES ARE DRAWN
 PURSUANT TO THE REPRESENTATION ACT, 2002
 PUBLISHED BY THE OFFICE OF THE CHIEF ELECTORAL OFFICER
 URBAN MUNICIPAL BOUNDARIES AS OF APRIL 1, 2002

© 2002 INFORMATION SERVICES CORPORATION OF SASKATCHEWAN



TOWN OF BIGGAR

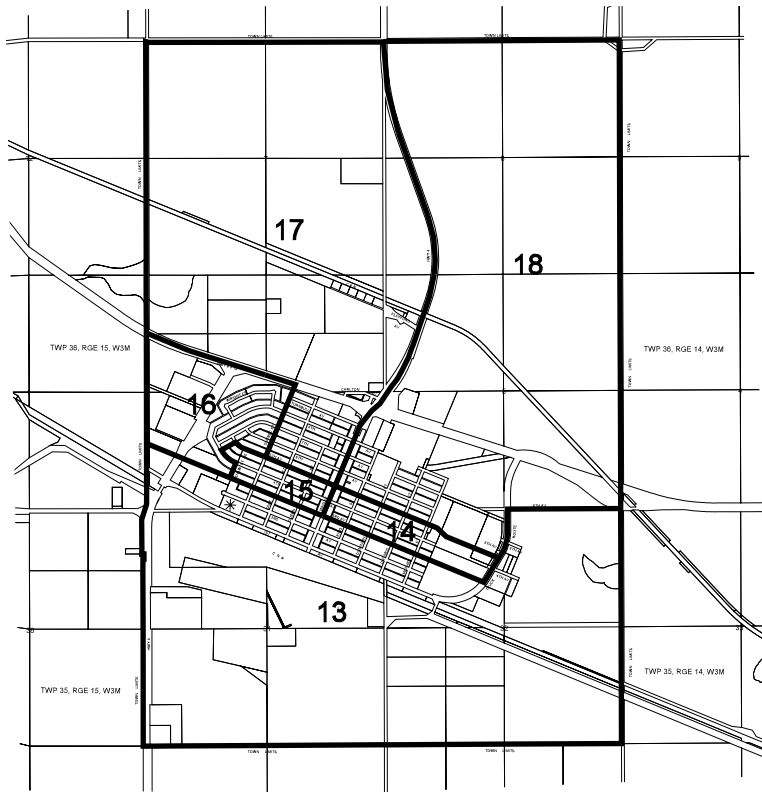

TOWN OF LANGHAM

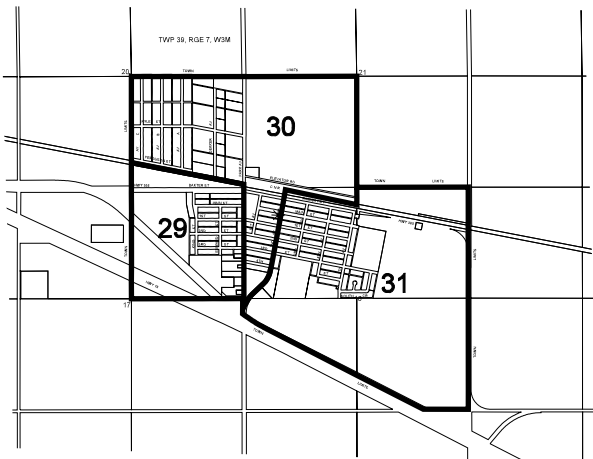

TOWN OF WILKIE

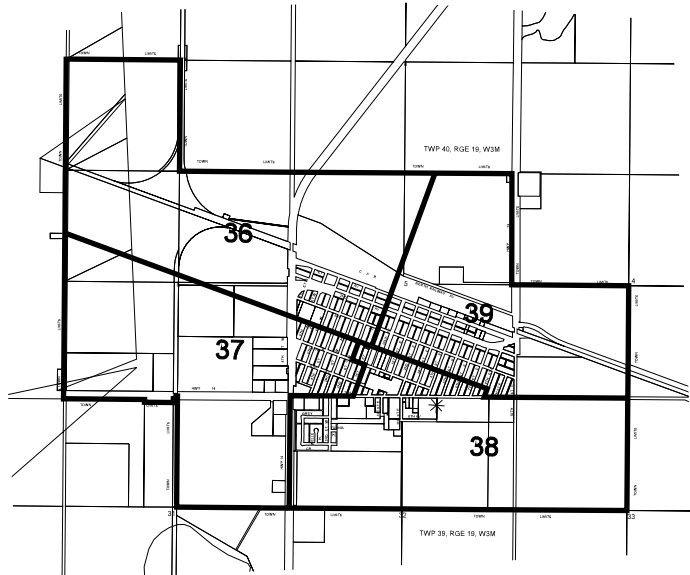

NOTE: FIRST EDITION

CONSTITUENCY BOUNDARIES ARE DRAWN
PURSUANT TO THE REPRESENTATION ACT, 2002
PUBLISHED BY THE OFFICE OF THE CHIEF ELECTORAL OFFICER
URBAN MUNICIPAL BOUNDARIES AS OF APRIL 1, 2002

© 2002 INFORMATION SERVICES CORPORATION OF SASKATCHEWAN