

## Martensville

Population		
Total Population (100 % data)	16,781	
Total Population (non-institutional) <sup>(1)</sup>	16,715	
Home Language		
	Population	% of Total Population
Single Responses	15,525	92.5
English	15,300	91.2
French	0	0.0
Non-official languages	225	1.3
Multiple Responses	1,190	7.1
Knowledge of Official Languages		
English only	16,215	96.6
French only	0	0.0
Both English and French	495	2.9
Neither English nor French	10	0.1
Knowledge of Non-official Languages <sup>(2)</sup>		
German	3,150	18.8
Ukrainian	95	0.6
Cree	0	0.0
Other	200	1.2
Ethnic Origin		
Single origins	8,640	51.5
Canadian	2,310	13.8
British origins <sup>(3)</sup>	685	4.1
German	3,870	23.1
Ukrainian	275	1.6
Chinese	10	0.1
Aboriginal origins <sup>(4)</sup>	190	1.1
French origins <sup>(5)</sup>	175	1.0
Other single origins	1,125	6.7
Multiple origins <sup>(6)</sup>	8,075	48.1
Citizenship		
Canadian citizenship <sup>(7)</sup>	16,570	98.7
Citizenship other than Canadian	140	0.8
Aboriginal Population		
Total Aboriginal population	565	3.4
Single response	555	3.3
North American Indian	205	1.2
Metis single response	340	2.0
Inuit single response	10	0.1
Multiple Aboriginal response	10	0.1
Aboriginal responses not included elsewhere	0	0.0
Non-Aboriginal population	16,150	96.2

(1) With the exception of "Total Population (100% data)", all characteristics exclude institutional residents and are based on weighted sample data (20%)

(2) Indicates the number of respondents reporting knowledge of these non-official languages.

(3) Includes the single responses of English, Irish, Scottish, Welsh and Other British, n.i.e.

(4) Includes the singles responses of Inuit, Metis and North American Indian

(5) Includes the single responses of French, Acadian and Quebecois

(6) A multiple response occurs when a respondent provides two or more ethnic origins.

(7) Includes Canadian citizenship by birth and Canadian citizenship by naturalization

## Martensville

Place of Birth		
	Population	% of Total Population
Non-immigrant population <sup>(8)</sup>	16,335	97.3
Born in Saskatchewan	13,945	83.1
Immigrant population	375	2.2
United States of America	65	0.4
Central and South America	25	0.1
Caribbean and Bermuda	0	0.0
United Kingdom	90	0.5
Other Europe <sup>(9)</sup>	85	0.5
Africa	25	0.1
India	0	0.0
Other Asia <sup>(10)</sup>	10	0.1
Oceania & Other <sup>(11)</sup>	80	0.5
Non-permanent residents <sup>(12)</sup>	0	0.0
Total Immigrant Population by Period of Immigration		
	Population	% of Total Population
Total immigrant population	380	2.3
	Population	% of Immigrant Population
By period of immigration		
Before 1961	105	27.6
1961-1970	70	18.4
1971-1980	55	14.5
1981-1990	55	14.5
1991-1995	15	3.9
1996-2001 <sup>(13)</sup>	75	19.7
Age at Immigration		
	Population	% of Total Population
0-4 years	65	17.1
5-9 years	115	30.3
20 years and over	195	51.3
Mobility Status		
	Population	% of Population 1 Year & Over
Total population 1 year and over <sup>(14)</sup>	16,495	
Non-movers	14,425	87.5
Movers	2,065	12.5
Non-migrants	855	5.2
Migrants	1,210	7.3
Internal migrants	1,180	7.2
Intraprovincial migrants	975	5.9
Interprovincial migrants	205	1.2
External migrants	35	0.2
	Population	% of Population 5 Years & Over
Total population 5 years and over <sup>(14)</sup>	15,395	
Non-movers	8,735	56.7
Movers	6,660	43.3
Non-migrants	2,295	14.9
Migrants	4,365	28.4
Internal migrants	4,280	27.8
Intraprovincial migrants	3,530	22.9
Interprovincial migrants	755	4.9
External migrants	80	0.5

(8) Includes persons born outside the province of residence as well as persons born outside Canada who have Canadian citizenship by birth

(9) Excludes the United Kingdom

(10) "Other Asia" includes the Middle East and excludes India

(11) "Other" includes persons born in Canada who do not have Canadian citizenship by birth, but who do have a valid year for immigration

(12) Refers to persons who hold a student authorization, employment authorization or Minister's permit, or who are refugee claimants

(13) Includes the first five months of 2001.

(14) Population residing in Canada, excluding all persons in collective households and Canadians (military and government personnel) in households outside Canada

## Martensville

School Attendance		
	Population	% of Population 15-24 Years
Total population 15-24 years	2,710	
Not attending school	1,210	44.6
Attending school full-time	1,410	52.0
Attending school part-time	90	3.3
Highest Level of Schooling		
	Population	% of Population 20+ Years
Total Population 20 years and over	10,600	
Less than grade 9 <sup>(15)</sup>	1,535	14.5
Grades 9-13	3,545	33.4
Without secondary certificate	2,260	21.3
With secondary certificate	1,280	12.1
Trades certificate or diploma	1,585	15.0
College <sup>(16)</sup>	2,335	22.0
Without certificate	715	6.7
With certificate <sup>(16),(17)</sup>	1,620	15.3
University - Without degree	650	6.1
University - Without certificate	490	4.6
University - With certificate <sup>(17)</sup>	155	1.5
University - With degree	950	9.0
Labour Force Activity		
Both Sexes - 15 years and over	12,210	
In labour force	9,270	
Employed	8,825	
Unemployed	440	
Not in the labour force	2,945	
Unemployment rate %	4.7	
Employment to population ratio	72.3	
Participation Rate %	76.0	
Males - 15 years and over	6,195	
In labour force	5,165	
Employed	4,935	
Unemployed	225	
Not in the labour force	1,035	
Unemployment rate %	4.4	
Employment to population ratio	79.7	
Participation Rate %	83.4	
Females - 15 years and over	6,015	
In labour force	4,105	
Employed	3,890	
Unemployed	215	
Not in the labour force	1,905	
Unemployment rate %	5.2	
Employment to population ratio	64.7	
Participation Rate %	68.2	
With no children at home <sup>(18)</sup>	56.7	
With children at home <sup>(18)</sup>	78.4	
Under 6 years only <sup>(18)</sup>	69.3	
Some less than 6 years <sup>(18),(19)</sup>	82.2	

(15) Includes "Never attended school or attended kindergarten only."

(16) Refers to courses completed at post-secondary non-university institutions which normally require a secondary school graduation certificate or equivalent for entrance, as well as to other courses in related or like institutions (such as private trade schools or adult vocational centres) which may not require secondary school graduation for entrance

(17) Includes "Other non-university certificate or diploma" and "Trades certificate or diploma"

(18) This participation rate is calculated for females 15 years and over in private households only

(19) Refers to females 15 years and over in private households with children under 6 years of age as well as children 6 years and over

## Martensville

Labour Force by Industry <sup>(21)</sup>		
Total labour force 15 years and over	9,270	
Not applicable <sup>(20)</sup>	60	
		% of Experienced
	Population	Labour Force
All industries <sup>(21),(22)</sup>	9,205	99.3
Agriculture, forestry, fishing and hunting	1,105	11.9
Mining and oil and gas extraction	70	0.8
Utilities	20	0.2
Construction	925	10.0
Manufacturing	1,005	10.8
Wholesale trade	605	6.5
Retail trade	810	8.7
Transportation and warehousing	715	7.7
Information and cultural industries	120	1.3
Finance and insurance	215	2.3
Real estate and rental and leasing	85	0.9
Professional, scientific and technical services	265	2.9
Management of companies and enterprises	0	0.0
Admin and support, waste management and remediation services	190	2.0
Educational services	525	5.7
Healthcare and social assistance	910	9.8
Arts, entertainment and recreation	95	1.0
Accommodation and food services	625	6.7
Other services (except public administration)	550	5.9
Public administration	375	4.0
Male Labour Force by Major Occupation Groups <sup>(21)</sup>		
Male labour force 15 years and over	5,165	
Not applicable <sup>(20)</sup>	35	
		% of Experienced
	Population	Male Labour Force
Males - All occupations (Major Groups) <sup>(21),(22)</sup>	5,130	99.3
Management occupations	445	8.6
Business, finance and administration occupations	285	5.5
Natural and applied sciences and related occupations	235	4.5
Health occupations	95	1.8
Occ in social science, education, government service and religion	140	2.7
Occupations in art, culture, recreation and sport	40	0.8
Sales and service occupations	820	15.9
Trades, transport and equipment operators and related occupations	1,985	38.4
Occupations unique to primary industry	730	14.1
Occupations unique to processing, manufacturing and utilities	360	7.0
Female Labour Force by Major Occupation Groups <sup>(21)</sup>		
Female labour force 15 years and over	4,105	
Not applicable <sup>(20)</sup>	25	
		% of Experienced
	Population	Female Labour Force
Females - All occupations (Major Groups) <sup>(21),(22)</sup>	4,080	99.4
Management occupations	200	4.9
Business, finance and administration occupations	910	22.2
Natural and applied sciences and related occupations	55	1.3
Health occupations	380	9.3
Occ in social science, education, government service and religion	360	8.8
Occupations in art, culture, recreation and sport	85	2.1
Sales and service occupations	1,415	34.5
Trades, transport and equipment operators and related occupations	135	3.3
Occupations unique to primary industry	410	10.0
Occupations unique to processing, manufacturing and utilities	125	3.0

(20) The "Not applicable" category refers to unemployed persons 15 years and over who have never worked or who had worked only prior to January 1, 2000. For these persons, the industry, occupation and class of worker questions did not apply.

(21) Occupation major groups and industry division totals include computer assignment of the "Not Stated" categories. These assignments are based on selected socio-economic characteristics.

(22) This category is also referred to as the "Experienced labour force"

## Martensville

Labour Force by Sex and Class of Worker		
Total labour force 15 years and over	9,270	
Not applicable <sup>(20)</sup>	60	
		% of Experienced
	Population	Labour Force
Males - All classes of worker <sup>(22)</sup>	5,130	55.3
Paid workers	4,240	45.7
Employees	4,010	43.3
Self-employed (incorporated)	230	2.5
Self-employed (unincorporated)	870	9.4
Unpaid family workers	15	0.2
Females - All classes of worker <sup>(22)</sup>	4,080	44.0
Paid workers	3,555	38.3
Employees	3,435	37.1
Self-employed (incorporated)	120	1.3
Self-employed (unincorporated)	440	4.7
Unpaid family workers	80	0.9
Labour Force by Sex and Place of Work		
Total employed labour force 15 years and over	8,825	
		% of Employed
	Population	Labour Force
Males in employed labour force	4,935	55.9
Usual place of work	3,320	37.6
In census subdivision of residence	540	6.1
In different census subdivision	2,775	31.4
In same census division	2,370	26.9
At home	690	7.8
Outside Canada	20	0.2
No usual place of work	910	10.3
Females in employed labour force	3,890	44.1
Usual place of work	3,090	35.0
In census subdivision of residence	595	6.7
In different census subdivision	2,500	28.3
In same census division	2,180	24.7
At home	595	6.7
Outside Canada	10	0.1
No usual place of work	200	2.3

(20) The "Not applicable" category refers to unemployed persons 15 years and over who have never worked or who had worked only prior to January 1, 2000. For these persons, the industry, occupation and class of worker questions did not apply

(22) This category is also referred to as the "Experienced labour force"

## Martensville

Dwelling Characteristics		
Total number of occupied private dwellings	5,275	
Average number of rooms per dwelling	7.5	
Average number of bedrooms per dwelling	3.3	
Average value of dwelling \$ <sup>(23)</sup>	119,194	
Dwelling by Need of Repair		
	Number of Dwellings	% of Total Occupied Private Dwellings
Regular maintenance only	3,230	61.2
Minor repairs	1,670	31.7
Major repairs	375	7.1
Dwellings by Period of Construction		
	Number of Dwellings	% of Total Occupied Private Dwellings
Before 1946	530	10.0
1946-1960	420	8.0
1961-1970	515	9.8
1971-1980	1,490	28.2
1981-1985	665	12.6
1986-1990	425	8.1
1991-1995	305	5.8
1996-2001 <sup>(24)</sup>	920	17.4
Household Characteristics		
Total number of private households	5,275	
Tenant one-family households	715	
Without additional persons <sup>(25)</sup>	445	
Average gross rent \$ <sup>(26)</sup>	582	
Gross rent >=30% of household income <sup>(25)</sup>	105	
Owner one-family households	4,555	
Without additional persons <sup>(27)</sup>	3,480	
Average major payments for owners \$ <sup>(28)</sup>	832	
Owner's major payments >=30% of household income <sup>(27)</sup>	440	

(23) Applies to owner-occupied non-farm, non-reserve dwellings only

(24) Includes the first five months only of 2001.

(25) Includes households in tenant-occupied non-farm, non-reserve dwellings with household income greater than \$0 in 2000

(26) Applies to tenant-occupied non-farm, non-reserve dwellings only

(27) Includes households in owner-occupied non-farm, non-reserve dwellings with household income greater than \$0 in 2000

(28) Applies to owner-occupied non-farm, non-reserve dwellings only

## Martensville

Employment Income (2000) by Sex and Work Activity		
Males		
Worked full year, full time <sup>(29)</sup>	3,415	
Average employment income \$	39,889	
Standard error of average employment income \$	1,012	
Worked part year of part time <sup>(30)</sup>	1,875	
Average employment income \$	17,951	
Standard error of average employment income \$	1,005	
Females		
Worked full year, full time <sup>(29)</sup>	1,855	
Average employment income \$	25,659	
Standard error of average employment income \$	673	
Worked part year of part time <sup>(30)</sup>	2,420	
Average employment income \$	12,526	
Standard error of average employment income \$	517	
Compositions of Total Income <sup>(29)</sup>		
Total %	100.0	
Employment income %	83.4	
Government transfer payments %	10.2	
Other income %	6.4	
Total Income (2000) by Sex		
Total Population 15 years and over with income	11,620	% of Population with Income
Males 15 years and over with income	5,955	51.2
Under \$1,000 <sup>(31)</sup>	235	2.0
\$ 1,000 - \$ 2,999	240	2.1
\$ 3,000 - \$ 4,999	165	1.4
\$ 5,000 - \$ 6,999	200	1.7
\$ 7,000 - \$ 9,999	165	1.4
\$10,000 - \$11,999	185	1.6
\$12,000 - \$14,999	225	1.9
\$15,000 - \$19,999	580	5.0
\$20,000 - \$24,999	475	4.1
\$25,000 - \$29,999	405	3.5
\$30,000 - \$34,999	755	6.5
\$35,000 - \$39,999	450	3.9
\$40,000 - \$44,999	420	3.6
\$45,000 - \$49,999	345	3.0
\$50,000 - \$59,999	500	4.3
\$60,000 and over	600	5.2
Average income \$ <sup>(32)</sup>	33,001	
Median income \$ <sup>(32)</sup>	30,437	
Standard error of average income \$ -	769	
Females 15 years and over with income	5,665	48.8
Under \$1,000 <sup>(31)</sup>	300	2.6
\$ 1,000 - \$ 2,999	400	3.4
\$ 3,000 - \$ 4,999	395	3.4
\$ 5,000 - \$ 6,999	330	2.8
\$ 7,000 - \$ 9,999	590	5.1
\$10,000 - \$11,999	370	3.2
\$12,000 - \$14,999	630	5.4
\$15,000 - \$19,999	615	5.3
\$20,000 - \$24,999	540	4.6
\$25,000 - \$29,999	470	4.0
\$30,000 - \$34,999	310	2.7
\$35,000 - \$39,999	220	1.9
\$40,000 - \$44,999	125	1.1
\$45,000 - \$49,999	80	0.7
\$50,000 - \$59,999	185	1.6
\$60,000 and over	110	0.9
Average income \$ <sup>(32)</sup>	18,014	
Median income \$ <sup>(32)</sup>	14,009	
Standard error of average income \$ -	407	

(29) Worked 49-52 weeks in 2000, mostly full-time

(30) Worked 49-52 weeks in 2000, mostly part-time, or worked less than 49 weeks

(31) Includes loss.

(32) For persons with income.

## Martensville

<b>Family Income (2000)</b>		
Total number of census families	4,665	
		% of Total Census Families
Census Family income		
Under \$10,000	125	2.7
\$10,000 - \$19,999	155	3.3
\$20,000 - \$29,999	560	12.0
\$30,000 - \$39,999	555	11.9
\$40,000 - \$49,999	660	14.1
\$50,000 - \$59,999	765	16.4
\$60,000 - \$69,999	545	11.7
\$70,000 - \$79,999	350	7.5
\$80,000 - \$89,999	275	5.9
\$90,000 - \$99,999	200	4.3
\$100,000 and over	465	10.0
Average family income \$	59,486	
Median family income \$	52,979	
Standard error of average family income \$	1,160	
<b>Incidence of Low Income (2000)<sup>(33)</sup></b>		
Total number of economic families <sup>(33)</sup>	4,610	
Low income economic families <sup>(33)</sup>	250	
Incidence of low income % <sup>(33),(34)</sup>	5.4	
All unattached individuals <sup>(33)</sup>	795	
Low income unattached individuals <sup>(33)</sup>	250	
Incidence of low income % <sup>(33),(34)</sup>	31.6	
Total population in private households <sup>(33)</sup>	16,655	
Persons in low income family units <sup>(33)</sup>	1,135	
Incidence of low income % <sup>(33),(34)</sup>	6.8	
<b>Household Income (2000)</b>		
Total number of private households	5,270	
		% of Private Households
Household income		
Under \$10,000	190	3.6
\$10,000 - \$19,999	375	7.1
\$20,000 - \$29,999	645	12.2
\$30,000 - \$39,999	630	12.0
\$40,000 - \$49,999	720	13.7
\$50,000 - \$59,999	795	15.1
\$60,000 - \$69,999	560	10.6
\$70,000 - \$79,999	360	6.8
\$80,000 - \$89,999	280	5.3
\$90,000 - \$99,999	225	4.3
\$100,000 and over	500	9.5
Average family income \$	56,586	
Median family income \$	50,698	
Standard error of average family income \$	1,100	

(33) See appendix for universe covered and for definitions of concepts and terms

(34) Calculations based on unrounded data.





# Constituency of Martensville

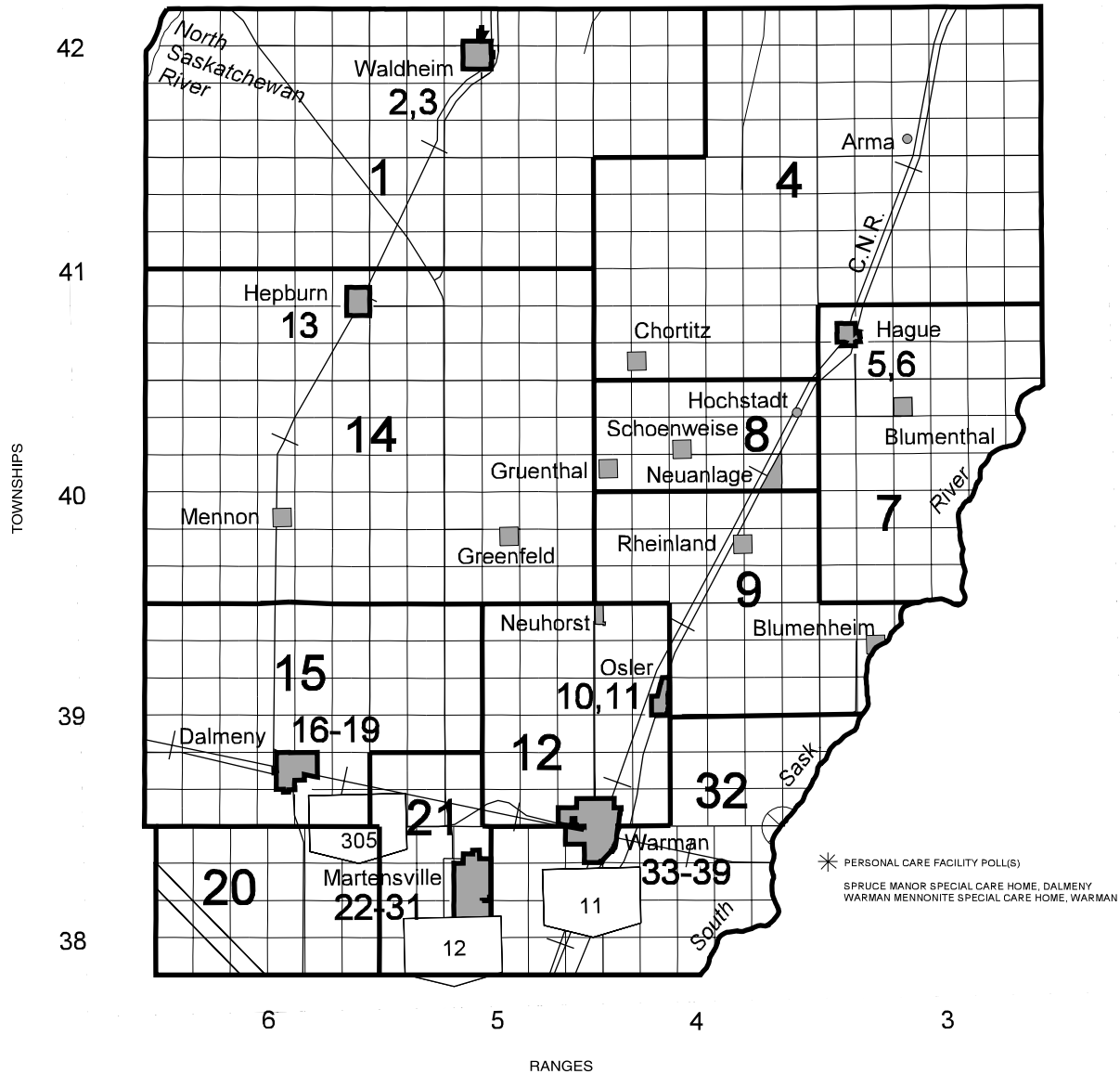



TOWN OF DALMENY

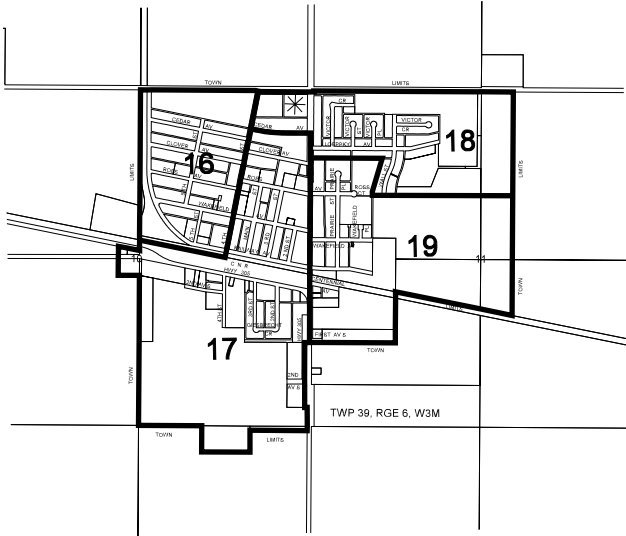

TOWN OF MARTENSVILLE

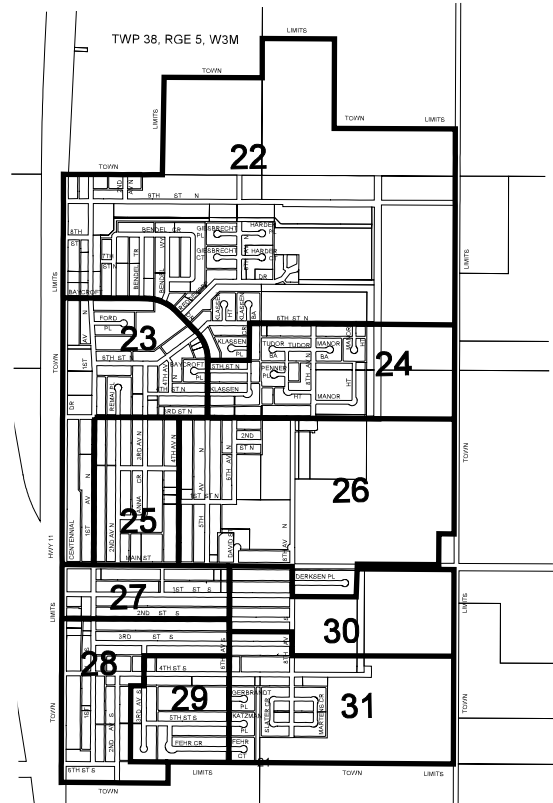

TOWN OF WARMAN

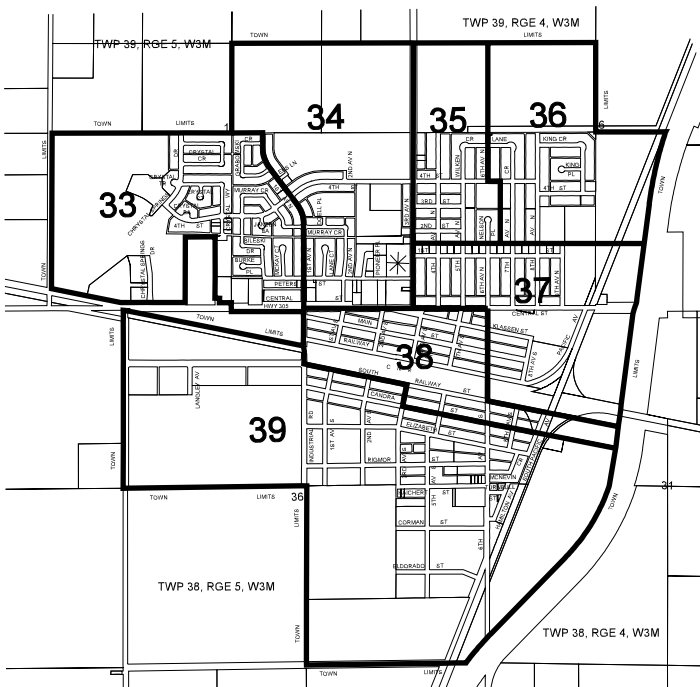

NOTE: FIRST EDITION  
 CONSTITUENCY BOUNDARIES ARE DRAWN  
 PURSUANT TO THE REPRESENTATION ACT, 2002  
 PUBLISHED BY THE OFFICE OF THE CHIEF ELECTORAL OFFICER  
 URBAN MUNICIPAL BOUNDARIES AS OF APRIL 1, 2002  
 © 2002 INFORMATION SERVICES CORPORATION OF SASKATCHEWAN