

## Thunder Creek

Population		
Total Population (100 % data)	16,821	
Total Population (non-institutional) <sup>(1)</sup>	16,700	
Home Language		
	Population	% of Total Population
Single Responses	16,140	96.0
English	16,000	95.1
French	0	0.0
Non-official languages	135	0.8
Multiple Responses	565	3.4
Knowledge of Official Languages		
English only	16,215	96.4
French only	0	0.0
Both English and French	445	2.6
Neither English nor French	45	0.3
Knowledge of Non-official Languages <sup>(2)</sup>		
German	1,285	7.6
Ukrainian	65	0.4
Cree	10	0.1
Other	270	1.6
Ethnic Origin		
Single origins	7,885	46.9
Canadian	2,380	14.1
British origins <sup>(3)</sup>	1,575	9.4
German	2,570	15.3
Ukrainian	160	1.0
Chinese	40	0.2
Aboriginal origins <sup>(4)</sup>	65	0.4
French origins <sup>(5)</sup>	135	0.8
Other single origins	960	5.7
Multiple origins <sup>(6)</sup>	8,820	52.4
Citizenship		
Canadian citizenship <sup>(7)</sup>	16,530	98.3
Citizenship other than Canadian	170	1.0
Aboriginal Population		
Total Aboriginal population	290	1.7
Single response	275	1.6
North American Indian	65	0.4
Metis single response	210	1.2
Inuit single response	0	0.0
Multiple Aboriginal response	0	0.0
Aboriginal responses not included elsewhere	15	0.1
Non-Aboriginal population	16,410	97.6

(1) With the exception of "Total Population (100% data)", all characteristics exclude institutional residents and are based on weighted sample data (20%)

(2) Indicates the number of respondents reporting knowledge of these non-official languages.

(3) Includes the single responses of English, Irish, Scottish, Welsh and Other British, n.i.e.

(4) Includes the singles responses of Inuit, Metis and North American Indian

(5) Includes the single responses of French, Acadian and Quebecois

(6) A multiple response occurs when a respondent provides two or more ethnic origins.

(7) Includes Canadian citizenship by birth and Canadian citizenship by naturalization

## Thunder Creek

Place of Birth		
	Population	% of Total Population
Non-immigrant population <sup>(8)</sup>	16,115	95.8
Born in Saskatchewan	13,790	82.0
Immigrant population	530	3.2
United States of America	140	0.8
Central and South America	15	0.1
Caribbean and Bermuda	0	0.0
United Kingdom	105	0.6
Other Europe <sup>(9)</sup>	160	1.0
Africa	0	0.0
India	0	0.0
Other Asia <sup>(10)</sup>	10	0.1
Oceania & Other <sup>(11)</sup>	100	0.6
Non-permanent residents <sup>(12)</sup>	60	0.4
Total Immigrant Population by Period of Immigration		
	Population	% of Total Population
Total immigrant population	530	3.2
	Population	% of Immigrant Population
By period of immigration		
Before 1961	275	51.9
1961-1970	40	7.5
1971-1980	85	16.0
1981-1990	50	9.4
1991-1995	40	7.5
1996-2001 <sup>(13)</sup>	40	7.5
Age at Immigration		
	Population	% of Total Population
0-4 years	105	19.8
5-9 years	155	29.2
20 years and over	270	50.9
Mobility Status		
	Population	% of Population
Total population 1 year and over <sup>(14)</sup>	16,545	
Non-movers	14,965	90.5
Movers	1,580	9.5
Non-migrants	380	2.3
Migrants	1,195	7.2
Internal migrants	1,105	6.7
Intraprovincial migrants	790	4.8
Interprovincial migrants	315	1.9
External migrants	95	0.6
	Population	% of Population
Total population 5 years and over <sup>(14)</sup>	15,890	
Non-movers	11,120	70.0
Movers	4,765	30.0
Non-migrants	1,465	9.2
Migrants	3,305	20.8
Internal migrants	3,155	19.9
Intraprovincial migrants	2,275	14.3
Interprovincial migrants	880	5.5
External migrants	145	0.9

(8) Includes persons born outside the province of residence as well as persons born outside Canada who have Canadian citizenship by birth

(9) Excludes the United Kingdom

(10) "Other Asia" includes the Middle East and excludes India

(11) "Other" includes persons born in Canada who do not have Canadian citizenship by birth, but who do have a valid year for immigration

(12) Refers to persons who hold a student authorization, employment authorization or Minister's permit, or who are refugee claimants

(13) Includes the first five months of 2001.

(14) Population residing in Canada, excluding all persons in collective households and Canadians (military and government personnel) in households outside Canada

## Thunder Creek

School Attendance		
	Population	% of Population 15-24 Years
Total population 15-24 years	2,300	
Not attending school	860	37.4
Attending school full-time	1,330	57.8
Attending school part-time	115	5.0
Highest Level of Schooling		
	Population	% of Population 20+ Years
Total Population 20 years and over	11,925	
Less than grade 9 <sup>(15)</sup>	1,160	9.7
Grades 9-13	4,830	40.5
Without secondary certificate	3,455	29.0
With secondary certificate	1,375	11.5
Trades certificate or diploma	1,720	14.4
College <sup>(16)</sup>	2,320	19.5
Without certificate	735	6.2
With certificate <sup>(16),(17)</sup>	1,585	13.3
University - Without degree	905	7.6
University - Without certificate	480	4.0
University - With certificate <sup>(17)</sup>	430	3.6
University - With degree	990	8.3
Labour Force Activity		
Both Sexes - 15 years and over	13,460	
In labour force	9,280	
Employed	8,960	
Unemployed	325	
Not in the labour force	4,175	
Unemployment rate %	3.5	
Employment to population ratio	66.6	
Participation Rate %	69.0	
Males - 15 years and over	6,910	
In labour force	5,195	
Employed	5,020	
Unemployed	175	
Not in the labour force	1,715	
Unemployment rate %	3.4	
Employment to population ratio	72.6	
Participation Rate %	75.2	
Females - 15 years and over	6,545	
In labour force	4,085	
Employed	3,940	
Unemployed	145	
Not in the labour force	2,460	
Unemployment rate %	3.5	
Employment to population ratio	60.2	
Participation Rate %	62.4	
With no children at home <sup>(18)</sup>	51.2	
With children at home <sup>(18)</sup>	81.5	
Under 6 years only <sup>(18)</sup>	67.5	
Some less than 6 years <sup>(18),(19)</sup>	84.8	

(15) Includes "Never attended school or attended kindergarten only."

(16) Refers to courses completed at post-secondary non-university institutions which normally require a secondary school graduation certificate or equivalent for entrance, as well as to other courses in related or like institutions (such as private trade schools or adult vocational centres) which may not require secondary school graduation for entrance

(17) Includes "Other non-university certificate or diploma" and "Trades certificate or diploma"

(18) This participation rate is calculated for females 15 years and over in private households only

(19) Refers to females 15 years and over in private households with children under 6 years of age as well as children 6 years and over

## Thunder Creek

<b>Labour Force by Industry<sup>(21)</sup></b>			
Total labour force 15 years and over	9,285		
Not applicable <sup>(20)</sup>	70		
		Population	% of Experienced Labour Force
All industries <sup>(21),(22)</sup>	9,215		99.2
Agriculture, forestry, fishing and hunting	2,860		30.8
Mining and oil and gas extraction	135		1.5
Utilities	35		0.4
Construction	510		5.5
Manufacturing	435		4.7
Wholesale trade	300		3.2
Retail trade	760		8.2
Transportation and warehousing	465		5.0
Information and cultural industries	80		0.9
Finance and insurance	375		4.0
Real estate and rental and leasing	115		1.2
Professional, scientific and technical services	110		1.2
Management of companies and enterprises	0		0.0
Admin and support, waste management and remediation services	145		1.6
Educational services	690		7.4
Healthcare and social assistance	770		8.3
Arts, entertainment and recreation	105		1.1
Accommodation and food services	490		5.3
Other services (except public administration)	425		4.6
Public administration	425		4.6
<b>Male Labour Force by Major Occupation Groups<sup>(21)</sup></b>			
Male labour force 15 years and over	5,195		
Not applicable <sup>(20)</sup>	30		
		Population	% of Experienced Male Labour Force
Males - All occupations (Major Groups) <sup>(21),(22)</sup>	5,165		99.4
Management occupations	415		8.0
Business, finance and administration occupations	250		4.8
Natural and applied sciences and related occupations	145		2.8
Health occupations	65		1.3
Occ in social science, education, government service and religion	210		4.0
Occupations in art, culture, recreation and sport	65		1.3
Sales and service occupations	480		9.2
Trades, transport and equipment operators and related occupations	1,270		24.4
Occupations unique to primary industry	2,125		40.9
Occupations unique to processing, manufacturing and utilities	150		2.9
<b>Female Labour Force by Major Occupation Groups<sup>(21)</sup></b>			
Female labour force 15 years and over	4,085		
Not applicable <sup>(20)</sup>	35		
		Population	% of Experienced Female Labour Force
Females - All occupations (Major Groups) <sup>(21),(22)</sup>	4,045		99.0
Management occupations	270		6.6
Business, finance and administration occupations	960		23.5
Natural and applied sciences and related occupations	35		0.9
Health occupations	385		9.4
Occ in social science, education, government service and religion	285		7.0
Occupations in art, culture, recreation and sport	80		2.0
Sales and service occupations	1,095		26.8
Trades, transport and equipment operators and related occupations	145		3.5
Occupations unique to primary industry	750		18.4
Occupations unique to processing, manufacturing and utilities	50		1.2

(20) The "Not applicable" category refers to unemployed persons 15 years and over who have never worked or who had worked only prior to January 1, 2000. For these persons, the industry, occupation and class of worker questions did not apply.

(21) Occupation major groups and industry division totals include computer assignment of the "Not Stated" categories. These assignments are based on selected socio-economic characteristics.

(22) This category is also referred to as the "Experienced labour force"

## Thunder Creek

Labour Force by Sex and Class of Worker		
Total labour force 15 years and over	9,285	
Not applicable <sup>(20)</sup>	70	
		% of Experienced
	Population	Labour Force
Males - All classes of worker <sup>(22)</sup>	5,170	55.7
Paid workers	3,365	36.2
Employees	2,965	31.9
Self-employed (incorporated)	400	4.3
Self-employed (unincorporated)	1,770	19.1
Unpaid family workers	40	0.4
Females - All classes of worker <sup>(22)</sup>	4,050	43.6
Paid workers	3,255	35.1
Employees	3,085	33.2
Self-employed (incorporated)	170	1.8
Self-employed (unincorporated)	620	6.7
Unpaid family workers	170	1.8
Labour Force by Sex and Place of Work		
Total employed labour force 15 years and over	8,960	
		% of Employed
	Population	Labour Force
Males in employed labour force	5,020	56.0
Usual place of work	2,435	27.2
In census subdivision of residence	720	8.0
In different census subdivision	1,715	19.1
In same census division	1,335	14.9
At home	1,995	22.3
Outside Canada	10	0.1
No usual place of work	585	6.5
Females in employed labour force	3,940	44.0
Usual place of work	2,735	30.5
In census subdivision of residence	885	9.9
In different census subdivision	1,850	20.6
In same census division	1,495	16.7
At home	1,095	12.2
Outside Canada	0	0.0
No usual place of work	110	1.2

(20) The "Not applicable" category refers to unemployed persons 15 years and over who have never worked or who had worked only prior to January 1, 2000. For these persons, the industry, occupation and class of worker questions did not apply

(22) This category is also referred to as the "Experienced labour force"

## Thunder Creek

Dwelling Characteristics		
Total number of occupied private dwellings	6,385	
Average number of rooms per dwelling	7.0	
Average number of bedrooms per dwelling	3.1	
Average value of dwelling \$ <sup>(23)</sup>	75,350	
Dwelling by Need of Repair		
	Number of Dwellings	% of Total Occupied Private Dwellings
Regular maintenance only	3,460	54.2
Minor repairs	2,150	33.7
Major repairs	770	12.1
Dwellings by Period of Construction		
	Number of Dwellings	% of Total Occupied Private Dwellings
Before 1946	1,420	22.2
1946-1960	975	15.3
1961-1970	1,100	17.2
1971-1980	1,480	23.2
1981-1985	690	10.8
1986-1990	255	4.0
1991-1995	195	3.1
1996-2001 <sup>(24)</sup>	285	4.5
Household Characteristics		
Total number of private households	6,385	
Tenant one-family households	750	
Without additional persons <sup>(25)</sup>	320	
Average gross rent \$ <sup>(26)</sup>	586	
Gross rent >=30% of household income <sup>(25)</sup>	50	
Owner one-family households	5,635	
Without additional persons <sup>(27)</sup>	3,250	
Average major payments for owners \$ <sup>(28)</sup>	587	
Owner's major payments >=30% of household income <sup>(27)</sup>	250	

(23) Applies to owner-occupied non-farm, non-reserve dwellings only

(24) Includes the first five months only of 2001.

(25) Includes households in tenant-occupied non-farm, non-reserve dwellings with household income greater than \$0 in 2000

(26) Applies to tenant-occupied non-farm, non-reserve dwellings only

(27) Includes households in owner-occupied non-farm, non-reserve dwellings with household income greater than \$0 in 2000

(28) Applies to owner-occupied non-farm, non-reserve dwellings only

## Thunder Creek

Employment Income (2000) by Sex and Work Activity		
Males		
Worked full year, full time <sup>(29)</sup>	3,230	
Average employment income \$	35,259	
Standard error of average employment income \$	1,238	
Worked part year of part time <sup>(30)</sup>	2,010	
Average employment income \$	15,865	
Standard error of average employment income \$	826	
Females		
Worked full year, full time <sup>(29)</sup>	1,920	
Average employment income \$	26,000	
Standard error of average employment income \$	1,028	
Worked part year of part time <sup>(30)</sup>	2,265	
Average employment income \$	12,630	
Standard error of average employment income \$	561	
Compositions of Total Income <sup>(29)</sup>		
Total %	100.0	
Employment income %	72.2	
Government transfer payments %	15.4	
Other income %	12.3	
Total Income (2000) by Sex		
Total Population 15 years and over with income	12,600	% of Population with Income
Males 15 years and over with income	6,510	51.7
Under \$1,000 <sup>(31)</sup>	330	2.6
\$ 1,000 - \$ 2,999	230	1.8
\$ 3,000 - \$ 4,999	240	1.9
\$ 5,000 - \$ 6,999	215	1.7
\$ 7,000 - \$ 9,999	330	2.6
\$10,000 - \$11,999	285	2.3
\$12,000 - \$14,999	450	3.6
\$15,000 - \$19,999	580	4.6
\$20,000 - \$24,999	610	4.8
\$25,000 - \$29,999	590	4.7
\$30,000 - \$34,999	425	3.4
\$35,000 - \$39,999	510	4.0
\$40,000 - \$44,999	345	2.7
\$45,000 - \$49,999	210	1.7
\$50,000 - \$59,999	405	3.2
\$60,000 and over	760	6.0
Average income \$ <sup>(32)</sup>	30,344	
Median income \$ <sup>(32)</sup>	24,851	
Standard error of average income \$ -	745	
Females 15 years and over with income	6,090	48.3
Under \$1,000 <sup>(31)</sup>	260	2.1
\$ 1,000 - \$ 2,999	295	2.3
\$ 3,000 - \$ 4,999	230	1.8
\$ 5,000 - \$ 6,999	375	3.0
\$ 7,000 - \$ 9,999	715	5.7
\$10,000 - \$11,999	430	3.4
\$12,000 - \$14,999	720	5.7
\$15,000 - \$19,999	830	6.6
\$20,000 - \$24,999	545	4.3
\$25,000 - \$29,999	450	3.6
\$30,000 - \$34,999	365	2.9
\$35,000 - \$39,999	230	1.8
\$40,000 - \$44,999	190	1.5
\$45,000 - \$49,999	130	1.0
\$50,000 - \$59,999	195	1.5
\$60,000 and over	120	1.0
Average income \$ <sup>(32)</sup>	19,288	
Median income \$ <sup>(32)</sup>	15,040	
Standard error of average income \$ -	460	

(29) Worked 49-52 weeks in 2000, mostly full-time

(30) Worked 49-52 weeks in 2000, mostly part-time, or worked less than 49 weeks

(31) Includes loss.

(32) For persons with income.

## Thunder Creek

<b>Family Income (2000)</b>		
Total number of census families	4,840	
		% of Total Census Families
Census Family income		
Under \$10,000	135	2.8
\$10,000 - \$19,999	265	5.5
\$20,000 - \$29,999	635	13.1
\$30,000 - \$39,999	880	18.2
\$40,000 - \$49,999	615	12.7
\$50,000 - \$59,999	575	11.9
\$60,000 - \$69,999	470	9.7
\$70,000 - \$79,999	295	6.1
\$80,000 - \$89,999	310	6.4
\$90,000 - \$99,999	245	5.1
\$100,000 and over	415	8.6
Average family income \$	56,116	
Median family income \$	47,688	
Standard error of average family income \$	1,191	
<b>Incidence of Low Income (2000)<sup>(33)</sup></b>		
Total number of economic families <sup>(33)</sup>	4,835	
Low income economic families <sup>(33)</sup>	340	
Incidence of low income % <sup>(33),(34)</sup>	7.1	
All unattached individuals <sup>(33)</sup>	1,660	
Low income unattached individuals <sup>(33)</sup>	425	
Incidence of low income % <sup>(33),(34)</sup>	25.4	
Total population in private households <sup>(33)</sup>	16,200	
Persons in low income family units <sup>(33)</sup>	1,510	
Incidence of low income % <sup>(33),(34)</sup>	9.3	
<b>Household Income (2000)</b>		
Total number of private households	6,385	
		% of Private Households
Household income		
Under \$10,000	290	4.5
\$10,000 - \$19,999	840	13.2
\$20,000 - \$29,999	965	15.1
\$30,000 - \$39,999	1,055	16.5
\$40,000 - \$49,999	720	11.3
\$50,000 - \$59,999	665	10.4
\$60,000 - \$69,999	490	7.7
\$70,000 - \$79,999	310	4.9
\$80,000 - \$89,999	360	5.6
\$90,000 - \$99,999	240	3.8
\$100,000 and over	455	7.1
Average family income \$	49,268	
Median family income \$	40,351	
Standard error of average family income \$	1,016	

(33) See appendix for universe covered and for definitions of concepts and terms

(34) Calculations based on unrounded data.





# Constituency of Thunder Creek

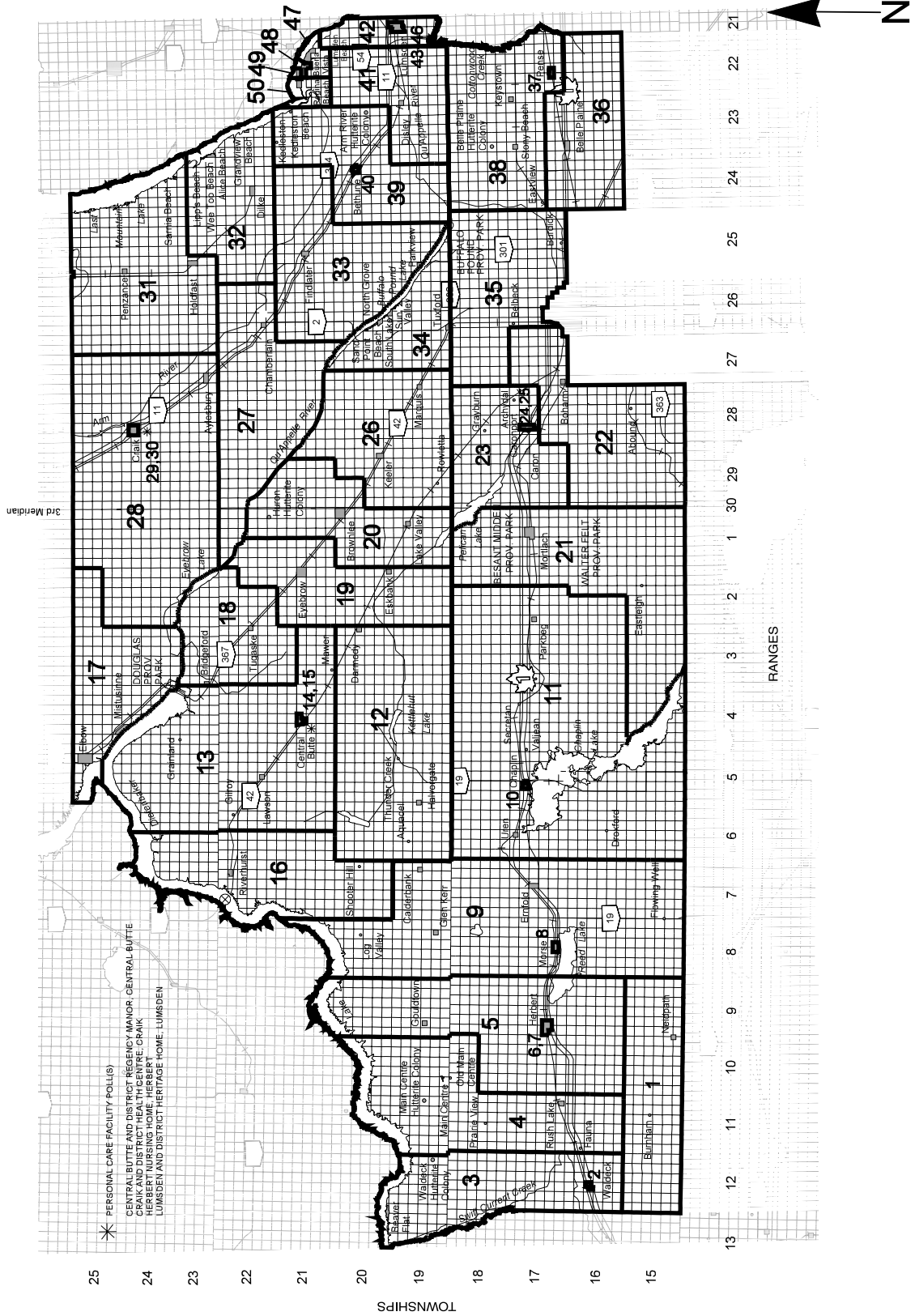

\* PERSONAL CARE FACILITY (POLIS)  
 CENTRAL BUTTE AND DISTRICT REGENCY MANOR, CENTRAL BUTTE  
 CRAIK AND DISTRICT HEALTH CENTRE, CRAIK  
 HERBERT NURSING HOME, HERBERT  
 LUMSDEN AND DISTRICT HERITAGE HOME, LUMSDEN

NOTE: FIRST EDITION  
 CONSTITUENCY BOUNDARIES ARE DRAWN  
 PURSUANT TO THE REPRESENTATION ACT, 2002  
 PUBLISHED BY THE OFFICE OF THE CHIEF ELECTORAL OFFICER  
 URBAN MUNICIPAL BOUNDARIES AS OF APRIL 1, 2002  
 © 2002 INFORMATION SERVICES CORPORATION OF SASKATCHEWAN



# Constituency of Thunder Creek



TOWN OF REGINA BEACH

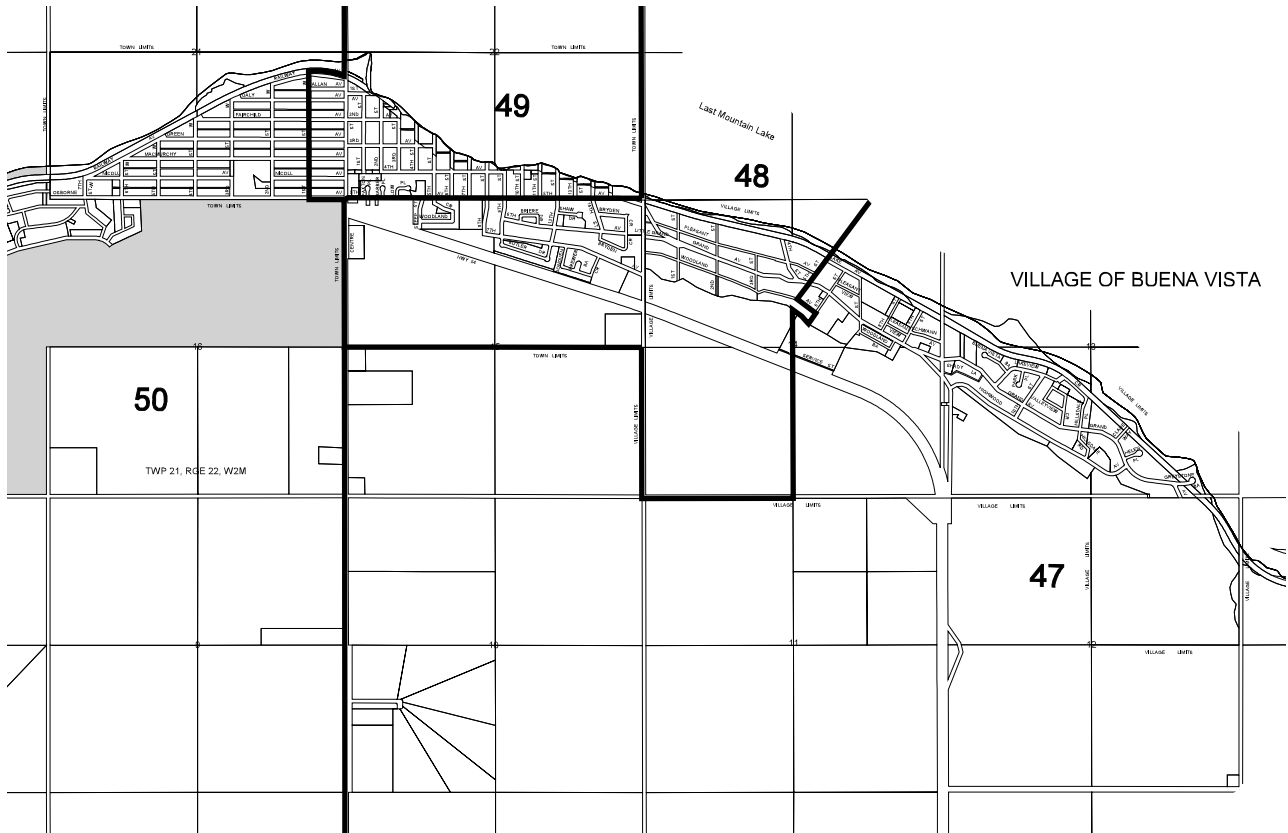

TOWN OF HERBERT

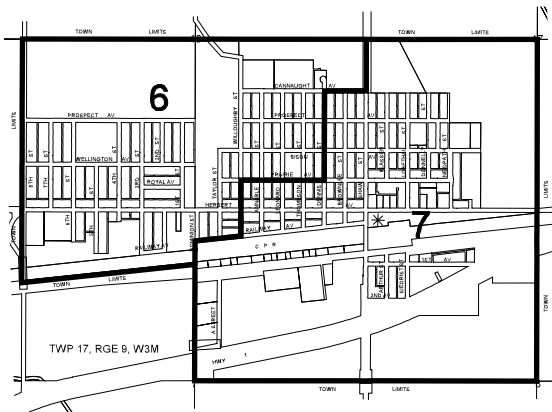

TOWN OF LUMSDEN

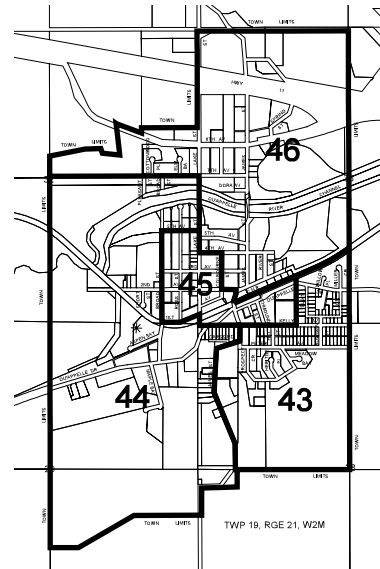

NOTE: FIRST EDITION

CONSTITUENCY BOUNDARIES ARE DRAWN PURSUANT TO THE REPRESENTATION ACT, 2002 PUBLISHED BY THE OFFICE OF THE CHIEF ELECTORAL OFFICER URBAN MUNICIPAL BOUNDARIES AS OF APRIL 1, 2002

© 2002 INFORMATION SERVICES CORPORATION OF SASKATCHEWAN