

Wood River

Population		
Total Population (100 % data)	16,623	
Total Population (non-institutional) ⁽¹⁾	16,390	
Home Language		
	Population	% of Total Population
Single Responses	14,770	88.9
English	14,380	86.5
French	205	1.2
Non-official languages	180	1.1
Multiple Responses	1,620	9.7
Knowledge of Official Languages		
English only	14,160	85.2
French only	20	0.1
Both English and French	2,125	12.8
Neither English nor French	80	0.5
Knowledge of Non-official Languages ⁽²⁾		
German	1,280	7.7
Ukrainian	115	0.7
Cree	0	0.0
Other	155	0.9
Ethnic Origin		
Single origins	7,760	46.7
Canadian	2,100	12.6
British origins ⁽³⁾	1,090	6.6
German	2,085	12.5
Ukrainian	295	1.8
Chinese	0	0.0
Aboriginal origins ⁽⁴⁾	80	0.5
French origins ⁽⁵⁾	980	5.9
Other single origins	1,130	6.8
Multiple origins ⁽⁶⁾	8,630	51.9
Citizenship		
Canadian citizenship ⁽⁷⁾	16,305	98.1
Citizenship other than Canadian	80	0.5
Aboriginal Population		
Total Aboriginal population	275	1.7
Single response	265	1.6
North American Indian	50	0.3
Metis single response	215	1.3
Inuit single response	0	0.0
Multiple Aboriginal response	0	0.0
Aboriginal responses not included elsewhere	10	0.1
Non-Aboriginal population	16,115	96.9

(1) With the exception of "Total Population (100% data)", all characteristics exclude institutional residents and are based on weighted sample data (20%)

(2) Indicates the number of respondents reporting knowledge of these non-official languages.

(3) Includes the single responses of English, Irish, Scottish, Welsh and Other British, n.i.e.

(4) Includes the singles responses of Inuit, Metis and North American Indian

(5) Includes the single responses of French, Acadian and Quebecois

(6) A multiple response occurs when a respondent provides two or more ethnic origins.

(7) Includes Canadian citizenship by birth and Canadian citizenship by naturalization

Wood River

Place of Birth		
	Population	% of Total Population
Non-immigrant population ⁽⁸⁾	16,010	96.3
Born in Saskatchewan	14,620	88.0
Immigrant population	370	2.2
United States of America	200	1.2
Central and South America	0	0.0
Caribbean and Bermuda	0	0.0
United Kingdom	85	0.5
Other Europe ⁽⁹⁾	55	0.3
Africa	0	0.0
India	0	0.0
Other Asia ⁽¹⁰⁾	10	0.1
Oceania & Other ⁽¹¹⁾	30	0.2
Non-permanent residents ⁽¹²⁾	10	0.1
Total Immigrant Population by Period of Immigration		
	Population	% of Total Population
Total immigrant population	370	2.2
	Population	% of Immigrant Population
By period of immigration		
Before 1961	115	31.1
1961-1970	120	32.4
1971-1980	55	14.9
1981-1990	55	14.9
1991-1995	35	9.5
1996-2001 ⁽¹³⁾	0	0.0
Age at Immigration		
	Population	% of Total Population
0-4 years	40	10.8
5-9 years	60	16.2
20 years and over	270	73.0
Mobility Status		
	Population	% of Population
Total population 1 year and over ⁽¹⁴⁾	16,270	
Non-movers	15,035	92.4
Movers	1,235	7.6
Non-migrants	630	3.9
Migrants	605	3.7
Internal migrants	590	3.6
Intraprovincial migrants	450	2.8
Interprovincial migrants	140	0.9
External migrants	10	0.1
	Population	% of Population
Total population 5 years and over ⁽¹⁴⁾	15,535	
Non-movers	12,275	79.0
Movers	3,260	21.0
Non-migrants	1,275	8.2
Migrants	1,980	12.7
Internal migrants	1,965	12.6
Intraprovincial migrants	1,500	9.7
Interprovincial migrants	465	3.0
External migrants	15	0.1

(8) Includes persons born outside the province of residence as well as persons born outside Canada who have Canadian citizenship by birth

(9) Excludes the United Kingdom

(10) "Other Asia" includes the Middle East and excludes India

(11) "Other" includes persons born in Canada who do not have Canadian citizenship by birth, but who do have a valid year for immigration

(12) Refers to persons who hold a student authorization, employment authorization or Minister's permit, or who are refugee claimants

(13) Includes the first five months of 2001.

(14) Population residing in Canada, excluding all persons in collective households and Canadians (military and government personnel) in households outside Canada

Wood River

School Attendance		
	Population	% of Population 15-24 Years
Total population 15-24 years	2,125	
Not attending school	965	45.4
Attending school full-time	1,100	51.8
Attending school part-time	55	2.6
Highest Level of Schooling		
	Population	% of Population 20+ Years
Total Population 20 years and over	11,885	
Less than grade 9 ⁽¹⁵⁾	1,580	13.3
Grades 9-13	5,040	42.4
Without secondary certificate	3,515	29.6
With secondary certificate	1,525	12.8
Trades certificate or diploma	1,585	13.3
College ⁽¹⁶⁾	2,000	16.8
Without certificate	665	5.6
With certificate ^{(16),(17)}	1,335	11.2
University - Without degree	805	6.8
University - Without certificate	410	3.4
University - With certificate ⁽¹⁷⁾	395	3.3
University - With degree	870	7.3
Labour Force Activity		
Both Sexes - 15 years and over	13,280	
In labour force	9,685	
Employed	9,465	
Unemployed	215	
Not in the labour force	3,600	
Unemployment rate %	2.2	
Employment to population ratio	71.3	
Participation Rate %	72.9	
Males - 15 years and over	6,750	
In labour force	5,530	
Employed	5,415	
Unemployed	115	
Not in the labour force	1,220	
Unemployment rate %	2.1	
Employment to population ratio	80.2	
Participation Rate %	81.9	
Females - 15 years and over	6,535	
In labour force	4,155	
Employed	4,050	
Unemployed	100	
Not in the labour force	2,380	
Unemployment rate %	2.4	
Employment to population ratio	62.0	
Participation Rate %	63.6	
With no children at home ⁽¹⁸⁾	53.4	
With children at home ⁽¹⁸⁾	86.4	
Under 6 years only ⁽¹⁸⁾	78.7	
Some less than 6 years ^{(18),(19)}	88.6	

(15) Includes "Never attended school or attended kindergarten only."

(16) Refers to courses completed at post-secondary non-university institutions which normally require a secondary school graduation certificate or equivalent for entrance, as well as to other courses in related or like institutions (such as private trade schools or adult vocational centres) which may not require secondary school graduation for entrance

(17) Includes "Other non-university certificate or diploma" and "Trades certificate or diploma"

(18) This participation rate is calculated for females 15 years and over in private households only

(19) Refers to females 15 years and over in private households with children under 6 years of age as well as children 6 years and over

Wood River

Labour Force by Industry⁽²¹⁾			
Total labour force 15 years and over		9,680	
Not applicable ⁽²⁰⁾		55	
			% of Experienced
	Population		Labour Force
All industries ^{(21),(22)}	9,625		99.4
Agriculture, forestry, fishing and hunting	4,645		48.0
Mining and oil and gas extraction	115		1.2
Utilities	80		0.8
Construction	325		3.4
Manufacturing	280		2.9
Wholesale trade	340		3.5
Retail trade	700		7.2
Transportation and warehousing	325		3.4
Information and cultural industries	40		0.4
Finance and insurance	315		3.3
Real estate and rental and leasing	35		0.4
Professional, scientific and technical services	170		1.8
Management of companies and enterprises	0		0.0
Admin and support, waste management and remediation services	135		1.4
Educational services	595		6.1
Healthcare and social assistance	635		6.6
Arts, entertainment and recreation	65		0.7
Accommodation and food services	340		3.5
Other services (except public administration)	310		3.2
Public administration	185		1.9
Male Labour Force by Major Occupation Groups⁽²¹⁾			
Male labour force 15 years and over		5,530	
Not applicable ⁽²⁰⁾		20	
			% of Experienced
	Population		Male Labour Force
Males - All occupations (Major Groups) ^{(21),(22)}	5,505		99.5
Management occupations	285		5.2
Business, finance and administration occupations	90		1.6
Natural and applied sciences and related occupations	85		1.5
Health occupations	45		0.8
Occ in social science, education, government service and religion	90		1.6
Occupations in art, culture, recreation and sport	40		0.7
Sales and service occupations	415		7.5
Trades, transport and equipment operators and related occupations	960		17.4
Occupations unique to primary industry	3,370		60.9
Occupations unique to processing, manufacturing and utilities	125		2.3
Female Labour Force by Major Occupation Groups⁽²¹⁾			
Female labour force 15 years and over		4,150	
Not applicable ⁽²⁰⁾		30	
			% of Experienced
	Population		Female Labour Force
Females - All occupations (Major Groups) ^{(21),(22)}	4,120		99.3
Management occupations	160		3.9
Business, finance and administration occupations	760		18.3
Natural and applied sciences and related occupations	10		0.2
Health occupations	385		9.3
Occ in social science, education, government service and religion	265		6.4
Occupations in art, culture, recreation and sport	85		2.0
Sales and service occupations	1,020		24.6
Trades, transport and equipment operators and related occupations	80		1.9
Occupations unique to primary industry	1,320		31.8
Occupations unique to processing, manufacturing and utilities	40		1.0

(20) The "Not applicable" category refers to unemployed persons 15 years and over who have never worked or who had worked only prior to January 1, 2000. For these persons, the industry, occupation and class of worker questions did not apply.

(21) Occupation major groups and industry division totals include computer assignment of the "Not Stated" categories. These assignments are based on selected socio-economic characteristics.

(22) This category is also referred to as the "Experienced labour force"

Wood River

Labour Force by Sex and Class of Worker		
Total labour force 15 years and over	9,680	
Not applicable ⁽²⁰⁾	55	
		% of Experienced
	Population	Labour Force
Males - All classes of worker ⁽²²⁾	5,505	56.9
Paid workers	2,870	29.6
Employees	2,250	23.2
Self-employed (incorporated)	615	6.4
Self-employed (unincorporated)	2,560	26.4
Unpaid family workers	70	0.7
Females - All classes of worker ⁽²²⁾	4,120	42.6
Paid workers	2,950	30.5
Employees	2,730	28.2
Self-employed (incorporated)	220	2.3
Self-employed (unincorporated)	815	8.4
Unpaid family workers	360	3.7
Labour Force by Sex and Place of Work		
Total employed labour force 15 years and over	9,465	
		% of Employed
	Population	Labour Force
Males in employed labour force	5,415	57.2
Usual place of work	1,800	19.0
In census subdivision of residence	1,110	11.7
In different census subdivision	690	7.3
In same census division	465	4.9
At home	3,175	33.5
Outside Canada	10	0.1
No usual place of work	430	4.5
Females in employed labour force	4,050	42.8
Usual place of work	2,210	23.3
In census subdivision of residence	1,240	13.1
In different census subdivision	980	10.4
In same census division	665	7.0
At home	1,725	18.2
Outside Canada	0	0.0
No usual place of work	110	1.2

(20) The "Not applicable" category refers to unemployed persons 15 years and over who have never worked or who had worked only prior to January 1, 2000. For these persons, the industry, occupation and class of worker questions did not apply

(22) This category is also referred to as the "Experienced labour force"

Wood River

Dwelling Characteristics		
Total number of occupied private dwellings	6,540	
Average number of rooms per dwelling	7.1	
Average number of bedrooms per dwelling	3.1	
Average value of dwelling \$ ⁽²³⁾	50,829	
Dwelling by Need of Repair		
	Number of Dwellings	% of Total Occupied Private Dwellings
Regular maintenance only	3,325	50.8
Minor repairs	2,435	37.2
Major repairs	780	11.9
Dwellings by Period of Construction		
	Number of Dwellings	% of Total Occupied Private Dwellings
Before 1946	1,905	29.1
1946-1960	1,135	17.4
1961-1970	1,150	17.6
1971-1980	1,320	20.2
1981-1985	605	9.3
1986-1990	175	2.7
1991-1995	85	1.3
1996-2001 ⁽²⁴⁾	170	2.6
Household Characteristics		
Total number of private households	6,545	
Tenant one-family households	970	
Without additional persons ⁽²⁵⁾	270	
Average gross rent \$ ⁽²⁶⁾	389	
Gross rent >=30% of household income ⁽²⁵⁾	40	
Owner one-family households	5,570	
Without additional persons ⁽²⁷⁾	2,360	
Average major payments for owners \$ ⁽²⁸⁾	458	
Owner's major payments >=30% of household income ⁽²⁷⁾	165	

(23) Applies to owner-occupied non-farm, non-reserve dwellings only

(24) Includes the first five months only of 2001.

(25) Includes households in tenant-occupied non-farm, non-reserve dwellings with household income greater than \$0 in 2000

(26) Applies to tenant-occupied non-farm, non-reserve dwellings only

(27) Includes households in owner-occupied non-farm, non-reserve dwellings with household income greater than \$0 in 2000

(28) Applies to owner-occupied non-farm, non-reserve dwellings only

Wood River

Employment Income (2000) by Sex and Work Activity		
Males		
Worked full year, full time ⁽²⁹⁾	3,535	
Average employment income \$	26,232	
Standard error of average employment income \$	884	
Worked part year of part time ⁽³⁰⁾	1,730	
Average employment income \$	14,500	
Standard error of average employment income \$	815	
Females		
Worked full year, full time ⁽²⁹⁾	1,885	
Average employment income \$	22,809	
Standard error of average employment income \$	718	
Worked part year of part time ⁽³⁰⁾	2,265	
Average employment income \$	11,190	
Standard error of average employment income \$	502	
Compositions of Total Income ⁽²⁹⁾		
Total %	100.0	
Employment income %	67.6	
Government transfer payments %	18.8	
Other income %	13.6	
Total Income (2000) by Sex		
Total Population 15 years and over with income	12,400	% of Population with Income
Males 15 years and over with income	6,370	51.4
Under \$1,000 ⁽³¹⁾	290	2.3
\$ 1,000 - \$ 2,999	265	2.1
\$ 3,000 - \$ 4,999	190	1.5
\$ 5,000 - \$ 6,999	285	2.3
\$ 7,000 - \$ 9,999	365	2.9
\$10,000 - \$11,999	335	2.7
\$12,000 - \$14,999	390	3.1
\$15,000 - \$19,999	870	7.0
\$20,000 - \$24,999	690	5.6
\$25,000 - \$29,999	555	4.5
\$30,000 - \$34,999	535	4.3
\$35,000 - \$39,999	330	2.7
\$40,000 - \$44,999	325	2.6
\$45,000 - \$49,999	195	1.6
\$50,000 - \$59,999	250	2.0
\$60,000 and over	490	4.0
Average income \$ ⁽³²⁾	26,113	
Median income \$ ⁽³²⁾	20,830	
Standard error of average income \$ -	598	
Females 15 years and over with income	6,030	48.6
Under \$1,000 ⁽³¹⁾	255	2.1
\$ 1,000 - \$ 2,999	260	2.1
\$ 3,000 - \$ 4,999	270	2.2
\$ 5,000 - \$ 6,999	340	2.7
\$ 7,000 - \$ 9,999	575	4.6
\$10,000 - \$11,999	370	3.0
\$12,000 - \$14,999	875	7.1
\$15,000 - \$19,999	885	7.1
\$20,000 - \$24,999	605	4.9
\$25,000 - \$29,999	545	4.4
\$30,000 - \$34,999	355	2.9
\$35,000 - \$39,999	175	1.4
\$40,000 - \$44,999	140	1.1
\$45,000 - \$49,999	100	0.8
\$50,000 - \$59,999	155	1.3
\$60,000 and over	130	1.0
Average income \$ ⁽³²⁾	19,107	
Median income \$ ⁽³²⁾	15,296	
Standard error of average income \$ -	426	

(29) Worked 49-52 weeks in 2000, mostly full-time

(30) Worked 49-52 weeks in 2000, mostly part-time, or worked less than 49 weeks

(31) Includes loss.

(32) For persons with income.

Source: Statistics Canada, 2001 Census of Population

Wood River

Family Income (2000)		
Total number of census families	4,540	
		% of Total Census Families
Census Family income		
Under \$10,000	180	4.0
\$10,000 - \$19,999	305	6.7
\$20,000 - \$29,999	860	18.9
\$30,000 - \$39,999	775	17.1
\$40,000 - \$49,999	590	13.0
\$50,000 - \$59,999	460	10.1
\$60,000 - \$69,999	485	10.7
\$70,000 - \$79,999	290	6.4
\$80,000 - \$89,999	230	5.1
\$90,000 - \$99,999	150	3.3
\$100,000 and over	220	4.8
Average family income \$	49,215	
Median family income \$	41,891	
Standard error of average family income \$	981	
Incidence of Low Income (2000)⁽³³⁾		
Total number of economic families ⁽³³⁾	4,555	
Low income economic families ⁽³³⁾	500	
Incidence of low income % ^{(33),(34)}	10.9	
All unattached individuals ⁽³³⁾	2,080	
Low income unattached individuals ⁽³³⁾	450	
Incidence of low income % ^{(33),(34)}	21.6	
Total population in private households ⁽³³⁾	15,655	
Persons in low income family units ⁽³³⁾	2,105	
Incidence of low income % ^{(33),(34)}	13.5	
Household Income (2000)		
Total number of private households	6,540	
		% of Private Households
Household income		
Under \$10,000	360	5.5
\$10,000 - \$19,999	1,115	17.0
\$20,000 - \$29,999	1,220	18.7
\$30,000 - \$39,999	1,020	15.6
\$40,000 - \$49,999	745	11.4
\$50,000 - \$59,999	530	8.1
\$60,000 - \$69,999	540	8.3
\$70,000 - \$79,999	335	5.1
\$80,000 - \$89,999	235	3.6
\$90,000 - \$99,999	155	2.4
\$100,000 and over	285	4.4
Average family income \$	42,949	
Median family income \$	35,562	
Standard error of average family income \$	805	

(33) See appendix for universe covered and for definitions of concepts and terms

(34) Calculations based on unrounded data.



Constituency of Wood River

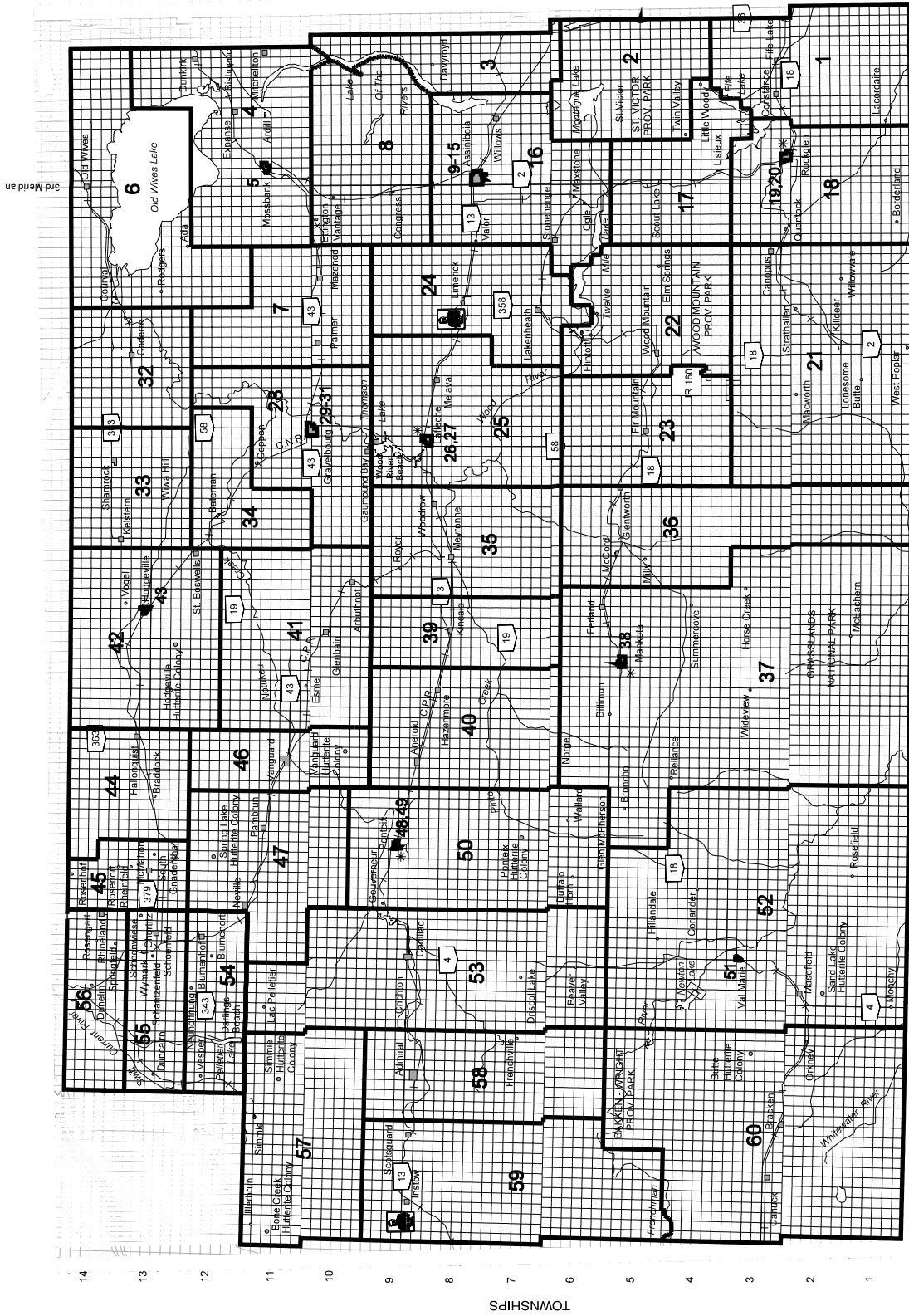
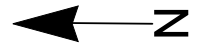

- PERSONAL CARE FACILITY POLLS
- ASSINIBOIA UNION HOSPITAL/ASSINIBOIA PIONEER LODGE (INTEGRATED FACILITY, ASSINIBOIA)
 - ROSS PAYANT CENTENNIAL NURSING HOME, ASSINIBOIA
 - ST. JOSEPH'S HOSPITAL/FOYER DYOVILLE HOME
 - UNION GRANGE DISTRICT HEALTH CENTRE
 - LAFLECHE DISTRICT HEALTH CENTRE, LA FLECHE
 - PAIRIE VIEW HEALTH CENTRE, MANKOTA
 - FOYER ST. JOSEPH NURSING HOME, PONTEIX
 - GRASSLANDS HEALTH CENTRE, ROCKGLEN

RANGES

14 13 12 11 10 9 8 7 6 5 4 3 2 1 18 17 16 15 14 13 12 11 10 9 8 7 6 5 4 3 2 1 28 29 30 1 2 3 4 5 6 7 8 9 10 11 12 13 14 15 16 17 18

TOWNSHIPS

NOTE: FIRST EDITION
 CONSTITUENCY BOUNDARIES ARE DRAWN PURSUANT TO THE REPRESENTATION ACT, 2002 PUBLISHED BY THE OFFICE OF THE CHIEF ELECTORAL OFFICER URBAN MUNICIPAL BOUNDARIES AS OF APRIL 1, 2002
 © 2002 INFORMATION SERVICES CORPORATION OF SASKATCHEWAN



Constituency of Wood River

TOWN OF ASSINIBOIA

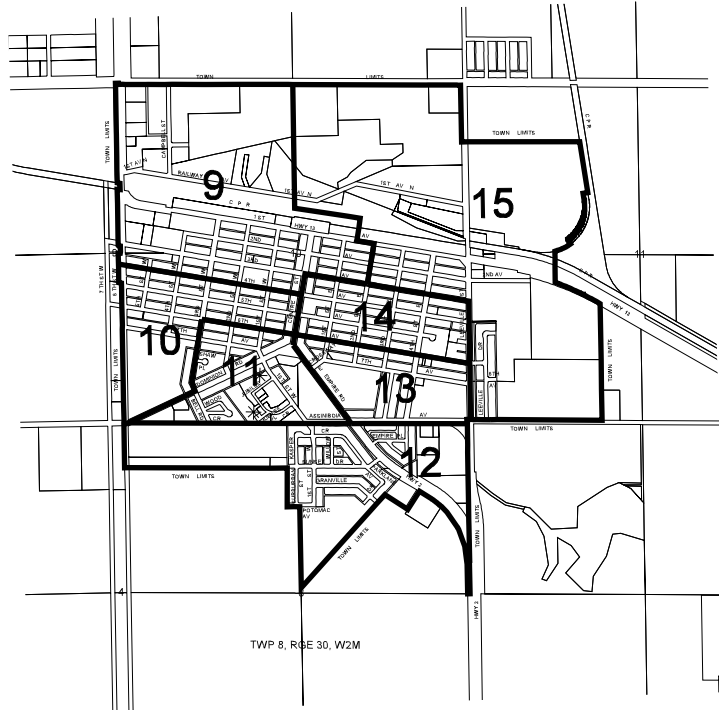

TOWN OF GRAVELBOURG

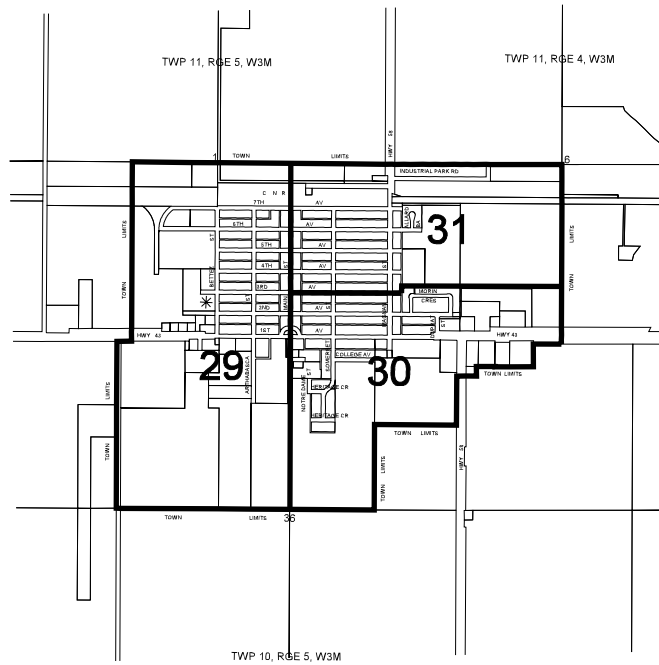

NOTE: FIRST EDITION

CONSTITUENCY BOUNDARIES ARE DRAWN PURSUANT TO THE REPRESENTATION ACT, 2002 PUBLISHED BY THE OFFICE OF THE CHIEF ELECTORAL OFFICER URBAN MUNICIPAL BOUNDARIES AS OF APRIL 1, 2002

© 2002 INFORMATION SERVICES CORPORATION OF SASKATCHEWAN