

0 800 mm  
1:40

1. grade
2. top of floor
3. top of plate
4. roof hatch - recommend prefabricated metal hatches available from grain bin manufacturers
5. door - 550 x 600mm
6. 9.5mm plywood siding nailed with 51mm spiral galv. nails @ 75mm oc
7. door - 550 x 1800mm
8. corner mould
9. 140 x 140 x 5400mm pressure treated skid
10. 38 x 140mm studs @ 300mm oc No.2 spruce or No. 2 Douglas fir 400mm oc
11. 38 x 140mm corner studs, nailed together with 125mm spiral galv. nails @ 1200mm oc (staggered)
12. diagonal corner brace at top of wall, see (6) sheet 2
13. flooring see (1) sheet 2
14. ALL DIMENSIONS IN THIS METRIC PLAN ARE IN MILLIMETRES (mm) UNLESS OTHERWISE SPECIFIED

**WARNING**  
This plan may require structural and other changes to meet local site conditions, climatic loads, user requirements and applicable building regulations (such as the Canadian Farm Building Code). Before construction, the user of this plan is responsible to ensure that all required changes are made.

revised and re-numbered (was 7200)				
SYM	REVISIONS	CHECKED	DATE	APPROVED
		PORTABLE GRANARY (45 M <sup>3</sup> )		
DESIGNED	DATE 79-04	PLAN		
DRAWN B.M.C.	REVISED	M-7123		
TRACED	DETAIL NUMBER	A		
CHECKED H.A.J.	ORIGINATES ON SHEET	B		
	DRAWN ON SHEET	C	SHEET 1 OF 2	

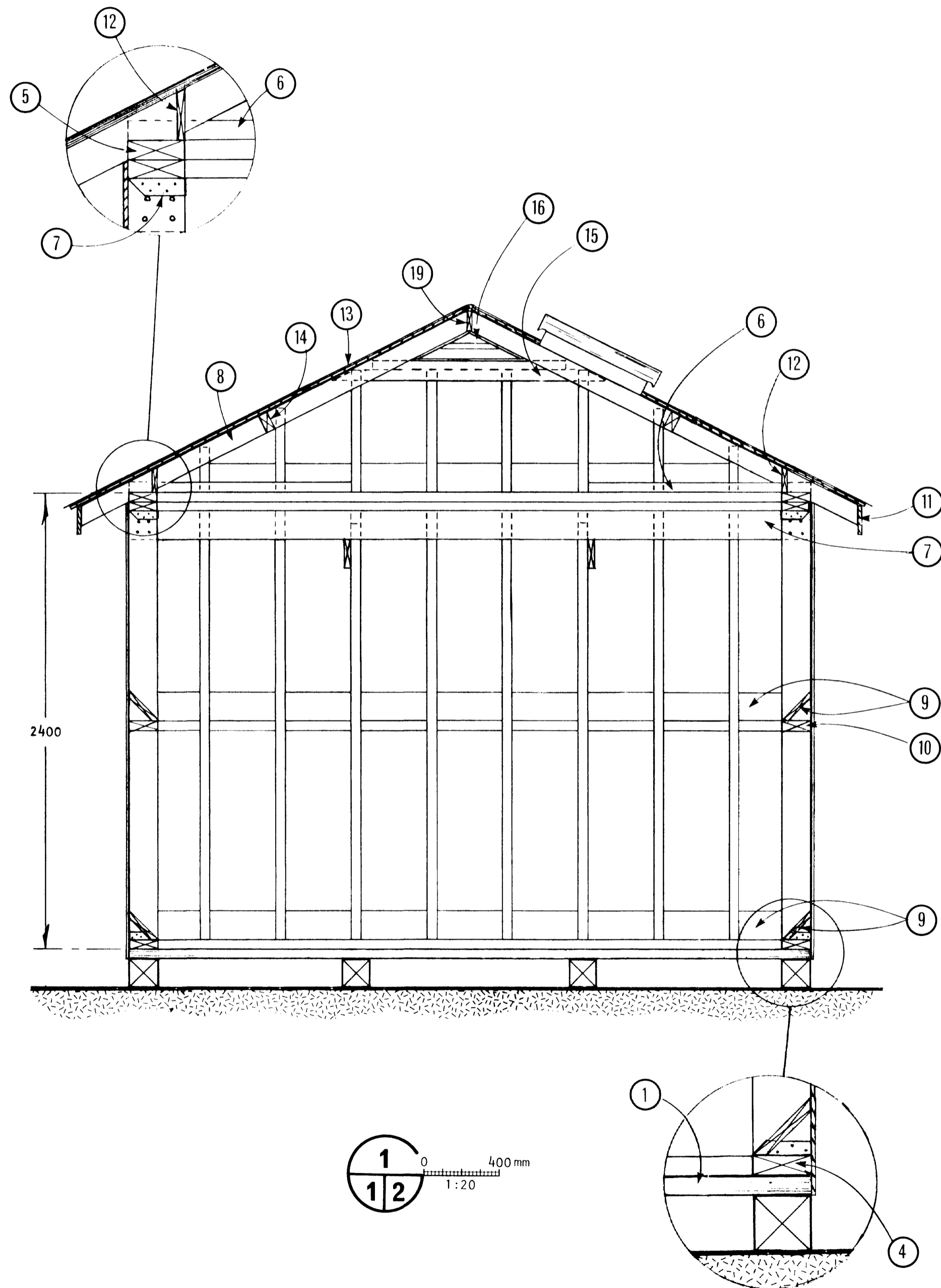

1  
1/2  
0 400 mm  
1:20

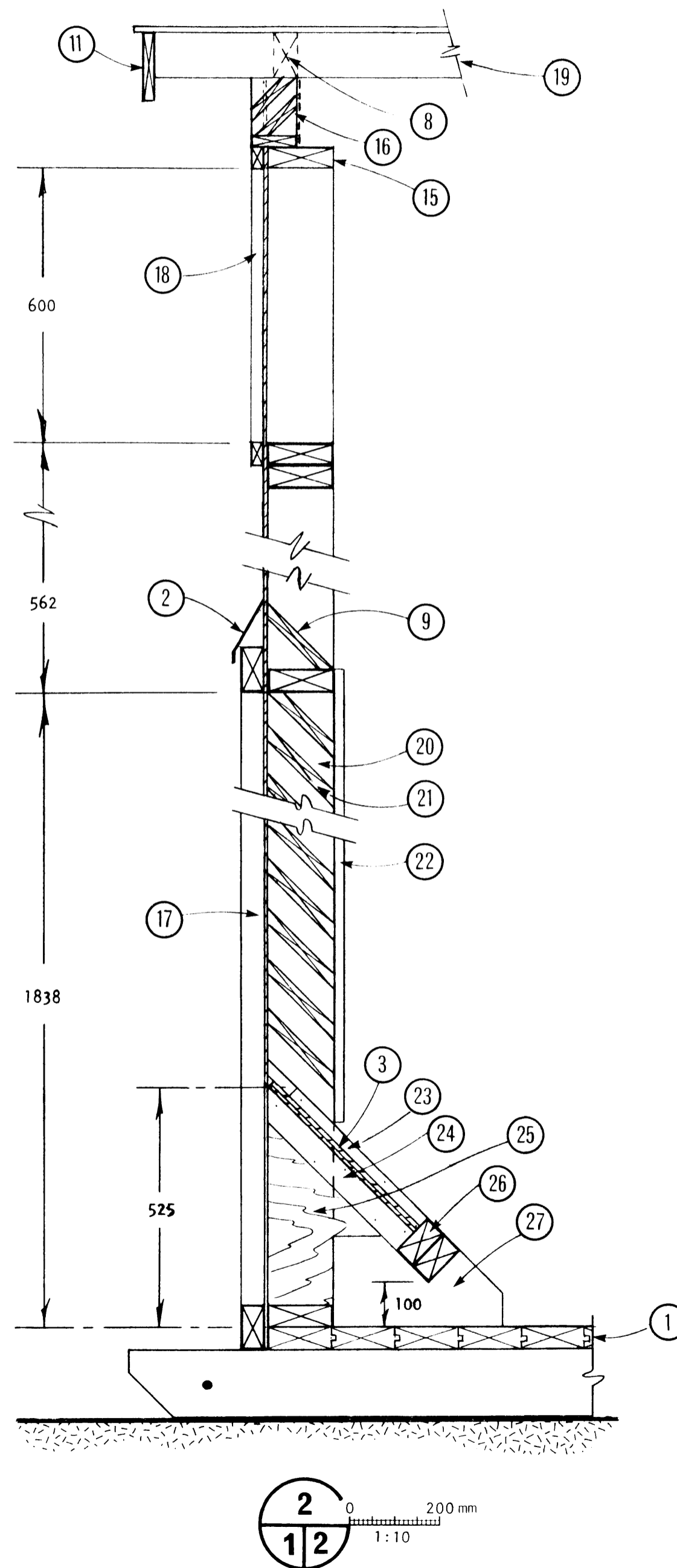

2  
1/2  
0 200 mm  
1:10

1. 38 x 140 mm T.G. floor cross ties to each skid with 2 - 89 mm galvanized spiral nails
2. door flashing
3. 18.5 mm plywood slide (removable)
4. 38 x 140 mm sill fastened to stud with 3 kN capacity joist hanger, nail to floor with 127 mm spiral galvanized nails @ 50 mm oc (staggered)
5. 38 x 140 mm bottom plate nailed to studs with 3 - 102 mm spiral nails, nail top plate to bottom plate with 102 mm spiral nails @ 100 mm oc
6. 38 x 140 mm diagonal corner brace nailed to top plate at each end with 5 - 102 mm spiral galv. nails
7. 2 - 38 x 140 x 3600 mm cross ties and 3 - 38 x 140 x 4800 mm longitudinal ties @ 1200 mm oc, fasten to stud with 4 - 1/2" bolts each end; fasten bolted studs to plate with 3 kN joist hanger in addition to 5 nailing
8. 38 x 89 mm rafters @ 600 mm oc, notch to suit plate 5
9. 19 x 140 mm cant strip
10. 38 x 140 mm blocking
11. 19 x 140 mm fascia
12. 19 x 140 mm filler
13. roof cladding, asphalt shingles over 9.5 mm plywood or corrugated galv. steel over 38 x 64 mm purlins @ 600 mm oc max.
14. 38 x 89 mm blocking @ plywood joint (used only if asphalt roofing applied)
15. 19 x 89 x 1500 mm tie @ 600 mm oc
16. screened louver, (13 x 13 mm mesh) 19 x 89 mm frame & slats
17. 38 x 89 mm door casing
18. 19 x 38 mm door casing
19. 38 x 89 mm ridgeboard
20. 19 x 38 mm guides
21. 19 x 184 mm slats @ 45°, removable
22. 19 x 140 mm stop
23. 19 x 19 mm guide
24. 19 x 38 mm guide
25. 18.5 mm plywood sides
26. 2 - 38 x 89 mm stop
27. 38 x 184 mm blocking

revised and re - numbered (was 7200)				
SYM	REVISIONS	CHECKED	DATE	APPROVED
		SECTION & DETAILS		
DESIGNED	DATE 79-04	PLAN		M-7123
DRAWN B.M.C.	REVISED	SHEET 2 OF 2		
TRACED	DETAIL NUMBER	A		
CHECKED H.A.J.	ORIGINATES ON SHEET	B		
	DRAWN ON SHEET	C		