

H/D Premiere

Cameras

4 Sony HDC 1000 Studio Cameras with heads, tripods, wheels
 5 Sony HDC 1500 Hand Held Cameras with lightweight tripods, spreaders and wheels

NB: 2 Hand Held cameras can be configured as Hand cameras with full size viewfinders

Lenses

4 Canon XJ86x9.3B Lens
 2 Canon XJ75x9.3B Lens
 3 Canon HJ22e x 7.6b Lens
 2 Canon HJ11e x 4.7b Lens
 1 Canon BG2-3259 Wide Angle Adapter

Video Production

GVG Kalypso Switcher, 4 MLEs, 75 Inputs, 48 Outputs, 3 Transform Engines, 8 Slide Stores

DVEOUS MX (DVE), Dual Twin, 6 Inputs
 GVG Encore Router (224 X 256)

Inscriber Character Generator, 2 channel with DVD Burner
 24 Leitch X-75 Conversion Units
 10 Channels of Video Modulation

Video Tape

- 5 Sony SRW 5000 HDCAM VTR's
- 2 SONY SRW 5500 HDCAM VTR's (SR + HDCAM)
- 3 - 6 channel EVS XT Units
- 1 Sony A75 SX VTR
- 1 Sony D75 Beta SP
- 1 - Panoasonic DMR-E500H DVD Recorder
- 1 JVC HR-XVS44U DVD Player + VHS Play/Recorder
- 1 JVC HR-S9911U VHS Recorder/Player

Audio Console

SSL Century C100 Audio Console

96 Mic Inputs, 48 Analog Inputs/Outputs
 96 AES Inputs/Outputs

Apex Audio Router (256 X 256)
 128 DSP's

Audio Equipment

- 2 - DBX 1066 Compressors
- 2 - ATI 8MX-2 Mic Pre-Amps
- Dolby DP 569 Encoder
- Tool
- Dolby DP 563 Surround Encoder
- Denon DN-C635 CD/MP3 Player
- HHB CDR-830 CD Recorder
- 3 - Digicart "E" Recorder/Players

Intercom/Communications

- RTS/Telex Adam 120x120 Intercom (Programmable) with panels, 15 beltpacks, 10 IFB, 7 remotes, 2 Wet Interface
- 2 Motorola VHF CDM 1550-LS 2 Channel Base with 12 HH Walkie Talkies
- 1 HME UHF RF with 6 Belt Packs

- Meridian Norstar Plus 12 Line Phone System
- 8 RTS TIF 2000 Telephone Hybrids

Transmission

- 2 Leitch X-75 Convertors
- 2 Dolby "E" Convertors
- 2 Tanberg E-5782 Signal Encoders
- 2 Tanberg TT-1280 Receivers
- GPS Clock Synchronizer
- Bell Express-Vu HD satellite system

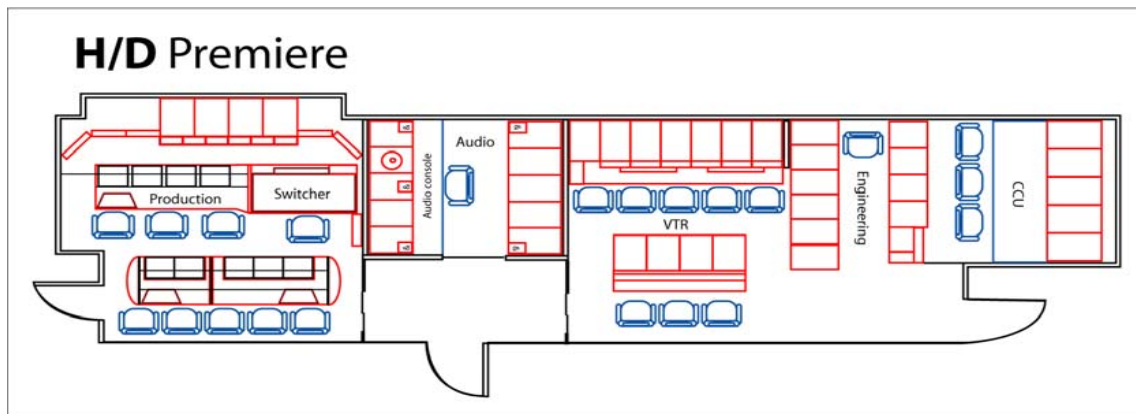

H-13'6", L-53', W-102"
 77,000 lbs (35,000 kgs)
 Curbside Expando - 5' X 47'
 Streetside Expando - 21" X 16"
 400 amp, 208/120 volt requirements
 (can be powered by 2 - 200 amp supplies)