

PLAN OF THE BOUNDARY OF THE GLENORCHY ADDITION

IN THE GEOGRAPHIC TOWNSHIP OF TRAFALGAR
IN THE TOWN OF OAKVILLE,
REGIONAL MUNICIPALITY OF HALTON

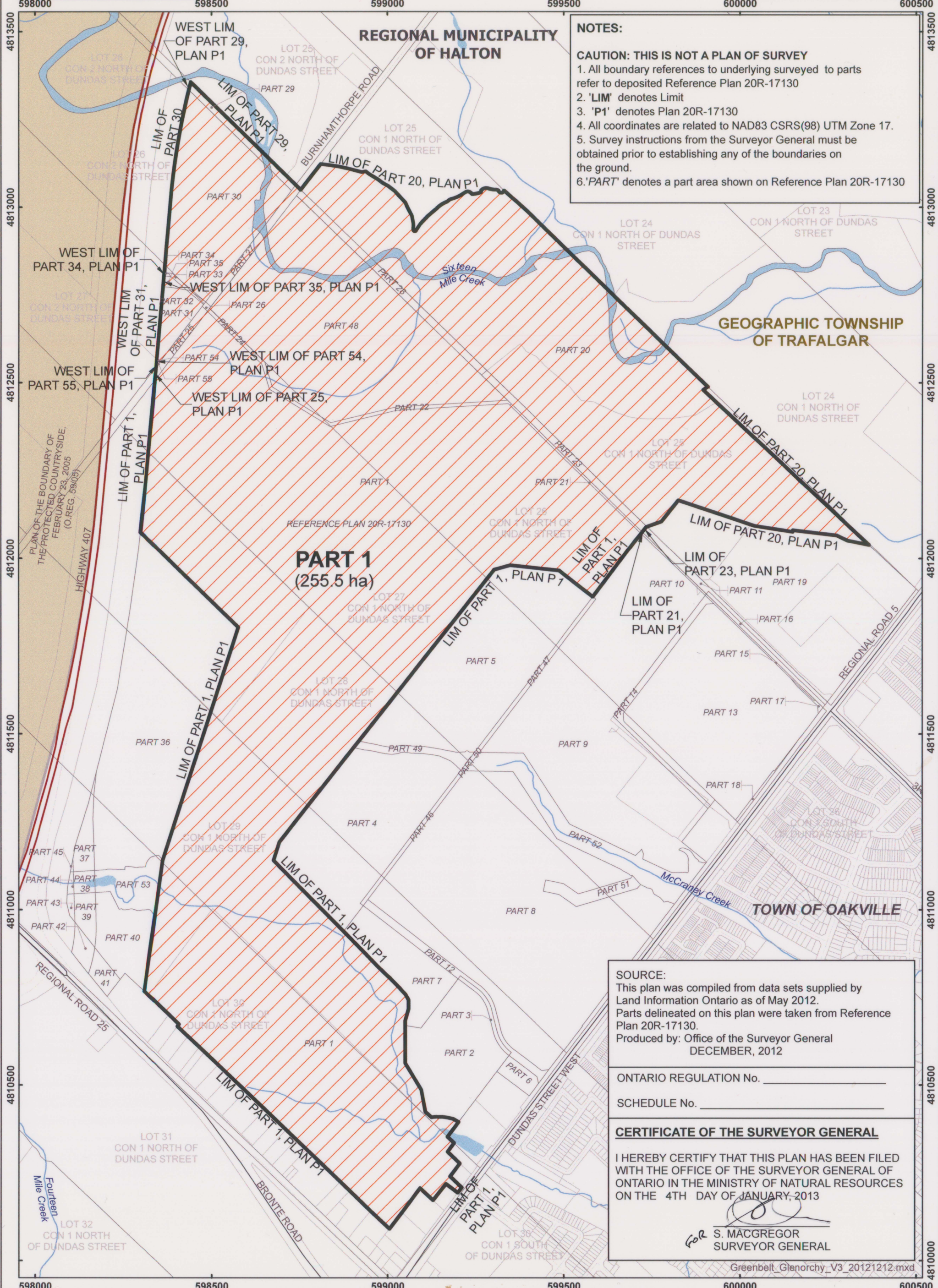
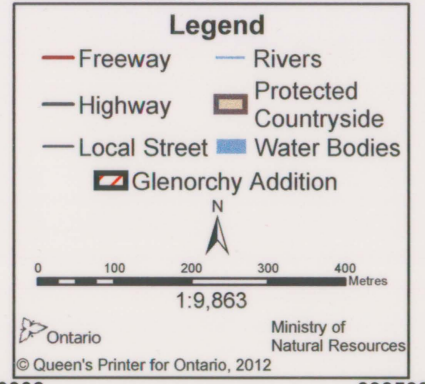
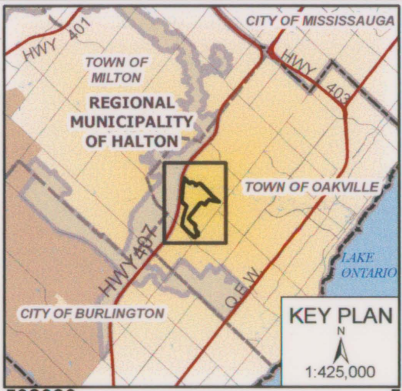

NOTES:

CAUTION: THIS IS NOT A PLAN OF SURVEY

1. All boundary references to underlying surveyed to parts refer to deposited Reference Plan 20R-17130
2. 'LIM' denotes Limit
3. 'P1' denotes Plan 20R-17130
4. All coordinates are related to NAD83 CSRS(98) UTM Zone 17.
5. Survey instructions from the Surveyor General must be obtained prior to establishing any of the boundaries on the ground.
6. 'PART' denotes a part area shown on Reference Plan 20R-17130

**PART 1
(255.5 ha)**

SOURCE:
This plan was compiled from data sets supplied by Land Information Ontario as of May 2012.
Parts delineated on this plan were taken from Reference Plan 20R-17130.
Produced by: Office of the Surveyor General
DECEMBER, 2012

ONTARIO REGULATION No. _____
SCHEDULE No. _____

CERTIFICATE OF THE SURVEYOR GENERAL

I HEREBY CERTIFY THAT THIS PLAN HAS BEEN FILED WITH THE OFFICE OF THE SURVEYOR GENERAL OF ONTARIO IN THE MINISTRY OF NATURAL RESOURCES ON THE 4TH DAY OF JANUARY, 2013

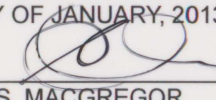
S. MACGREGOR
SURVEYOR GENERAL