

# Regulation Plan of the Southerly Boundary of the Far North of Ontario

IN THE TERRITORIAL DISTRICTS OF KENORA, KENORA PATRICIA PORTION, THUNDER BAY & COCHRANE PROVINCE OF ONTARIO

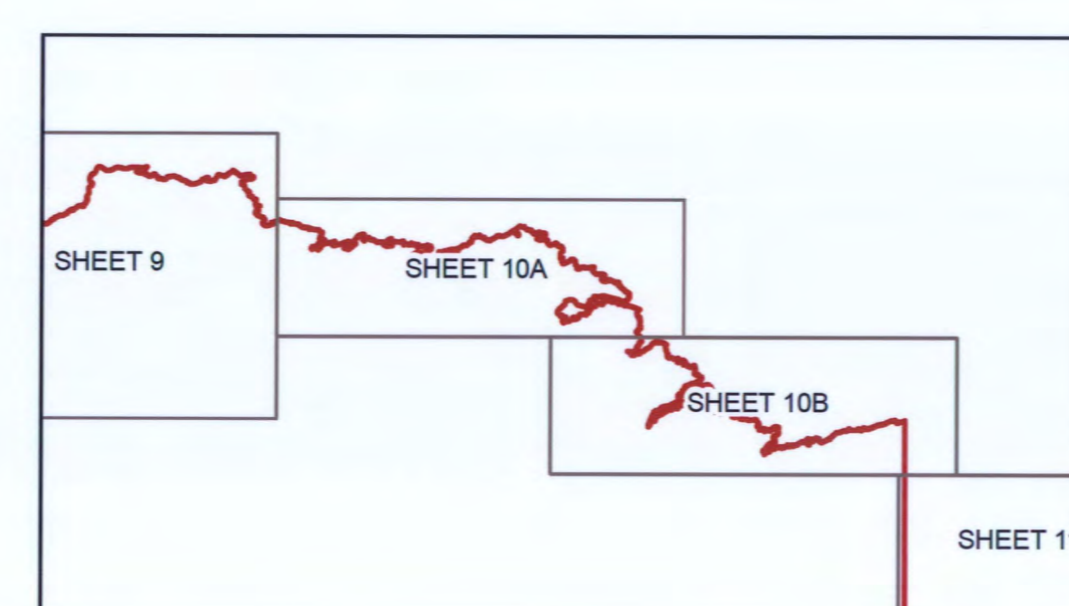
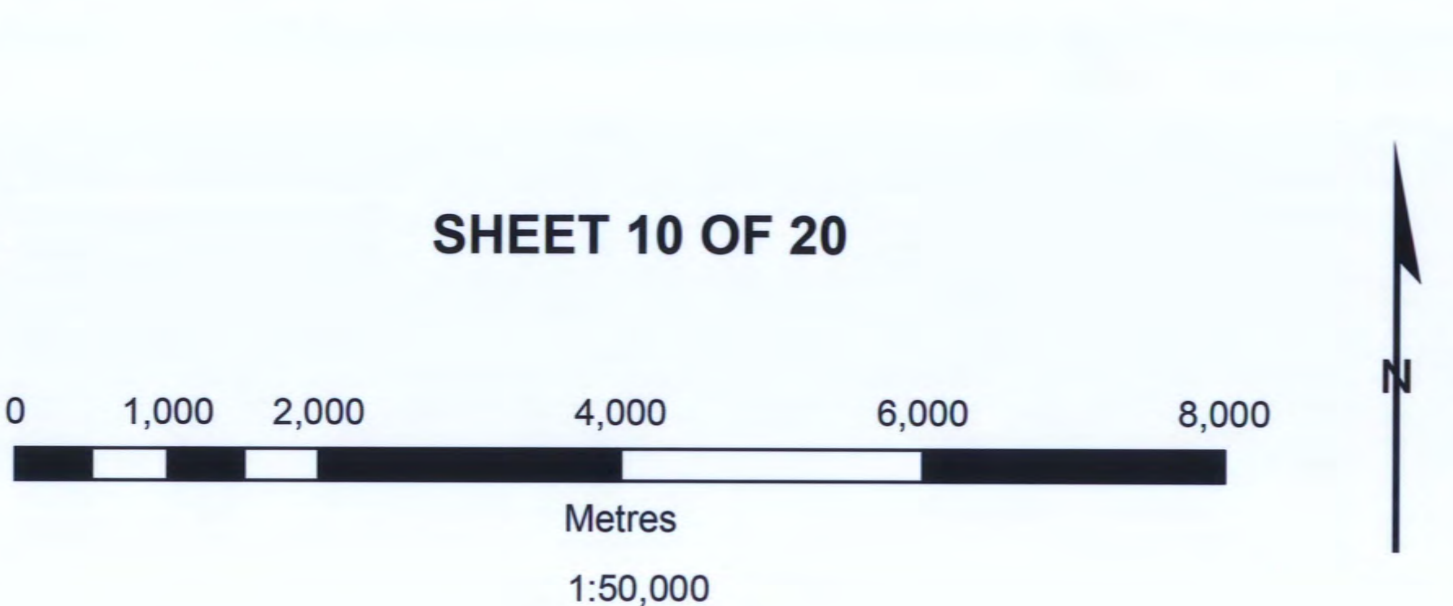

ONT. REG. No. 2111  
 SCHEDULE N/A

CERTIFICATE OF SURVEYOR GENERAL  
 I HEREBY CERTIFY THAT THIS PLAN HAS BEEN FILED WITH THE OFFICE OF THE SURVEYOR GENERAL OF ONTARIO IN THE MINISTRY OF NATURAL RESOURCES ON THE 24<sup>th</sup> DAY OF JUNE 2009.

*B. Maloney*  
 SURVEYOR GENERAL

**LEGEND**

Far North Boundary	Water
Forest Management Unit	Seasonal Water
Conservation Reserve	Wetland
Provincial Park	
Indian Reserve	

**NOTES:**  
 1. THIS IS NOT A PLAN OF SURVEY. This map is illustrative only. Do not rely on it as being a precise indicator of routes, locations of features, nor as a guide for navigation.  
 2. Survey instructions from the Surveyor General of Ontario must be obtained prior to establishing any of the boundaries on the ground.  
 3. Projection: NAD 83 UTM zone 16

**DATA SOURCE:**  
 Land Information Ontario Warehouse (March 25 & 26, 2009)  
 Metes & Bounds Description provided by MNR, Forests Division, Industry Relations Branch (April 23, 2009)  
 Other information of record with the MNR

**PRODUCED BY:**  
 The Office of the Surveyor General (June 24, 2009)

Ontario  
 © Queen's Printer for Ontario, 2009 Ministry of Natural Resources  
 Far\_North\_z16\_sheet10.mxd